

# Technical Manual



# JBL VT4889ADP-AN/CN/DA SPECIFICATIONS

## ACOUSTIC & ELECTRICAL SPECIFICATIONS:

- DP3 Internal Amplification Output (at load): 6000W Peak, 3000W Continuous
- DP3 Output Topology: 3-Channel, Class-I
- Frequency Response: 45 Hz- 16 kHz ( $\pm 3$  dB)
- Frequency Range: 40 Hz- 18 kHz (-10 dB)
- Maximum Peak Output<sup>1</sup>: 143 dB SPL, 1 m
- Signal Processing: dbx Type IV Conversion System, 3-Way Precision bandpass filters, limiting, pre-equalization, filters and auto-matic self-tested functions
  
- AC Power Operating Range: Auto Select 90-132/VAC 50/60 Hz
- AC Input Connector: Neutrik Powercon (NAC3MPA)
- AC Power Loop-thru: Neutrik Powercon (NAC3MPB)
- AC Current Requirement: 6A per system at 120V, 3A per system at 240V
- Signal Input: F-LXR Active 20K Ohms Balanced, 10K Ohms Unbalanced
- Signal Loop-Through: M-XLR (passive pass-through)
- Controls: Precision 0.5 dB increment  
16 dB input attenuator (DPIP only)

## SYSTEMS COMPONENTS:

- Cabinet: Enclosure Assembly C4889ADP
- Grille: Left (351685-002), Right (351685-001)
- Low Frequency Transducer: (2) 2265H, 380 mm (15" dia., 76 mm (3") Dual Coil, Neodymium Differential Drive<sup>R</sup>, Direct Cooled<sup>TM</sup>
- Bandpass Nominal Impedance: 4 Ohms (LF woofers wired in parallel)
- DC Resistance: 5.10 Ohms  $\pm 10\%$

## SYSTEMS COMPONENTS:

- Mid Frequency Transducer: (4) 2169H, 203 mm (8 in) dia, 76 mm (3 in) Dual Coil, Neodymium Differential Drive<sup>®</sup>, Direct Cooled<sup>TM</sup>
- Bandpass Nominal Impedance: 8 ohms (drivers wired in series-parallel)
- DC Resistance: 5.1 Ohms  $\pm 10\%$
  
- High Frequency Transducers: (3) 2435H, 76 mm (3 in) diameter beryllium diaphragm, 38 mm (1.5 in) throat diameter neodymium compression drivers
- Bandpass Nominal Impedance: 16 Ohms (HF drivers wired in series)
- DC Resistance: 4.0 Ohms  $\pm 10\%$

## AURAL SWEEP TEST SPECIFICATIONS:

- A. System Aural Sweep Test: 100mV Input, 20 Hz to 20 kHz Fully clock wise sweep Duration 7 sec
- B. LF. Aural Sweep Test: 15.0V Input, 10 Hz to 100 Hz
- C. MF. Aural Sweep Test: 7.0V Input, 20 Hz to 1 kHz
- D. HF. Aural Sweep Test: 0.75V Input, 1 kHz to 16 kHz

## PHYSICAL SPECIFICATIONS:

- Enclosure Dimensions: 494 mm x 1215 mm x 692 mm D (19.4 x 47.8 x 27.2 in. D)
- Net Weight: 205 lbs. (93.1kg)

## WARRANTY INFORMATION:

- Refer to Warranty Statement packed with each product.

## PACKAGE

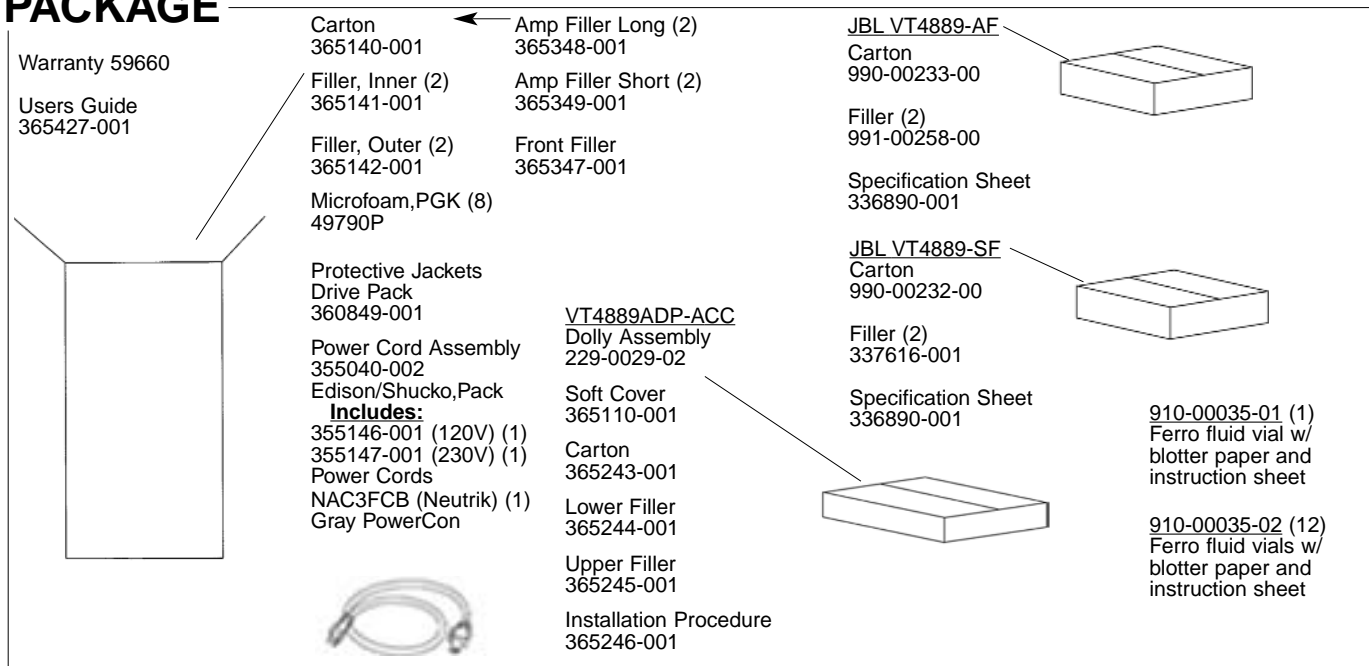

JBL VT4889ADP-AN/CN/DA REV F

# JBL VT4889ADP-AN/CN/DA

## WIRING DIAGRAM

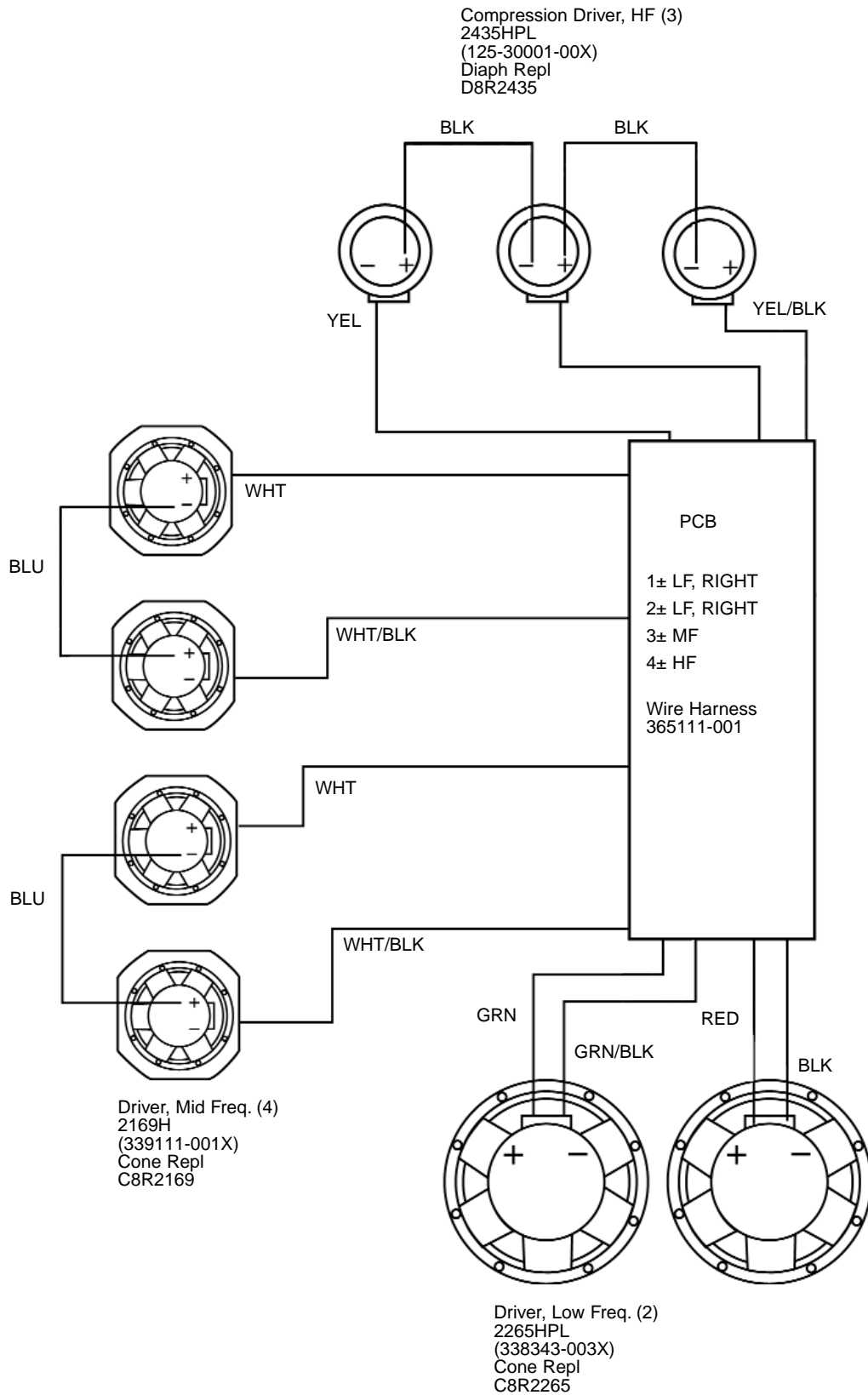

JBL VT4889ADP-AN/CN/DA

# JBL VT4889ADP-AN/CN/DA

## SCHEMATIC DIAGRAM

Wire Harness P/N 365111-001

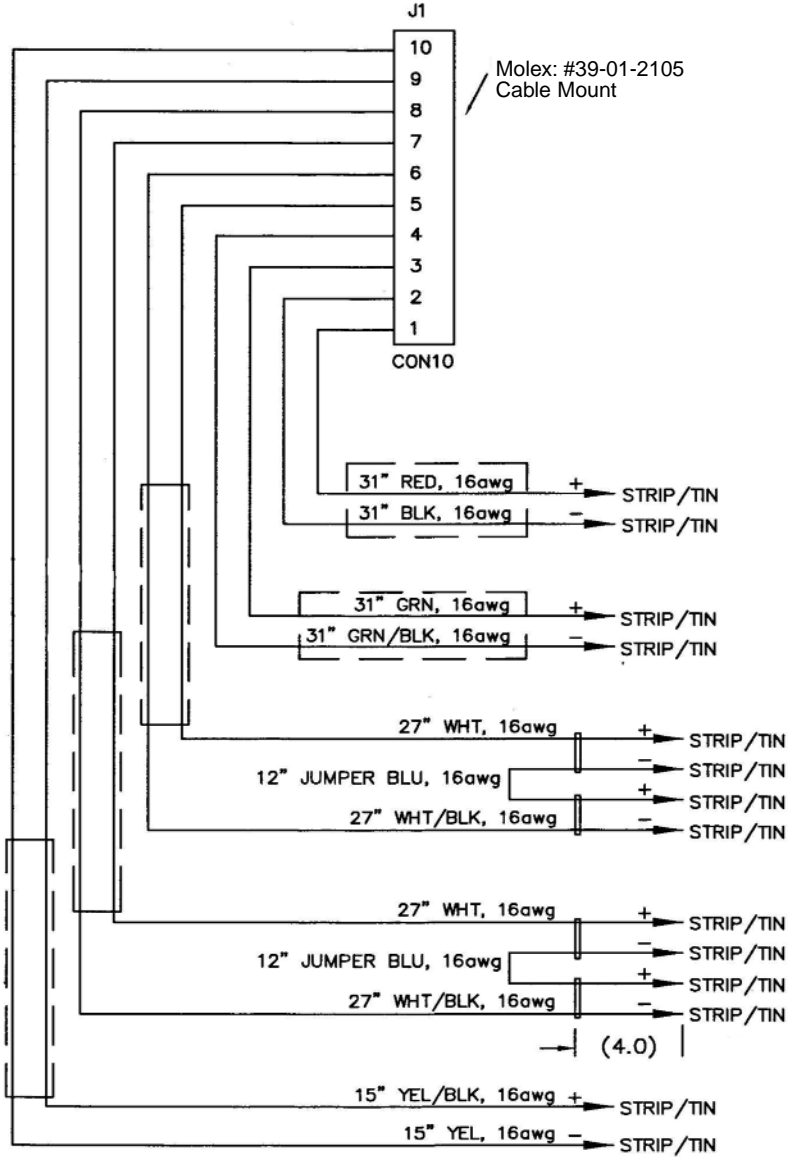

JBL VT4889ADP-AN/CN/DA

# JBL VT4889ADP-AN/CN/DA

## INPUT CUP ASSEMBLY SCHEMATIC

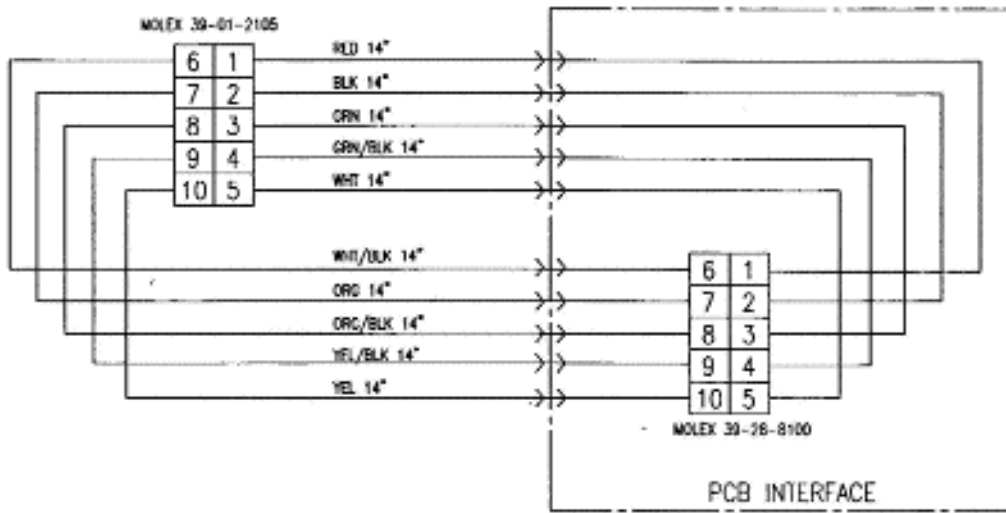

6	—	SCREW MOUNT CABLE TIE*
5	---	#6 X 3/8", TAP SCREW, PAN PH, BLK
4	352818-001	GASKET
3	352087-001	WIRE HARNESS <small>Ribbon Cable</small>
2	352270-001	PCB ASSY
1	352271-001	INPUT CUP

352270-001 Connector Assembly Diagram

352087-001 Wire Harness Diagram

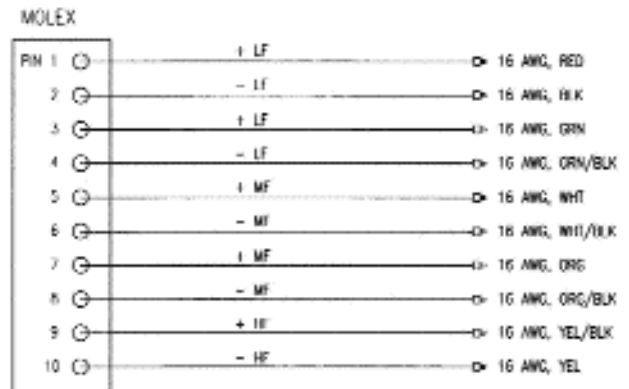
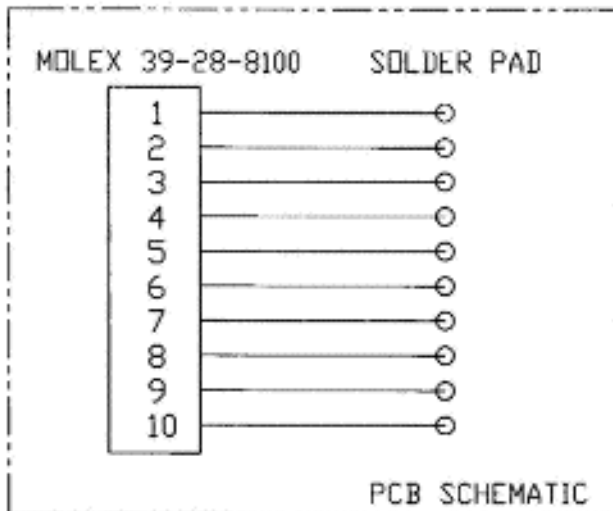

JBL VT4889ADP-AN/CN/DA

# JBL VT4889ADP-AN/CN/DA

## COMPONENT EXPLODED VIEW

JBL VT4889ADP-AN/CN/DA

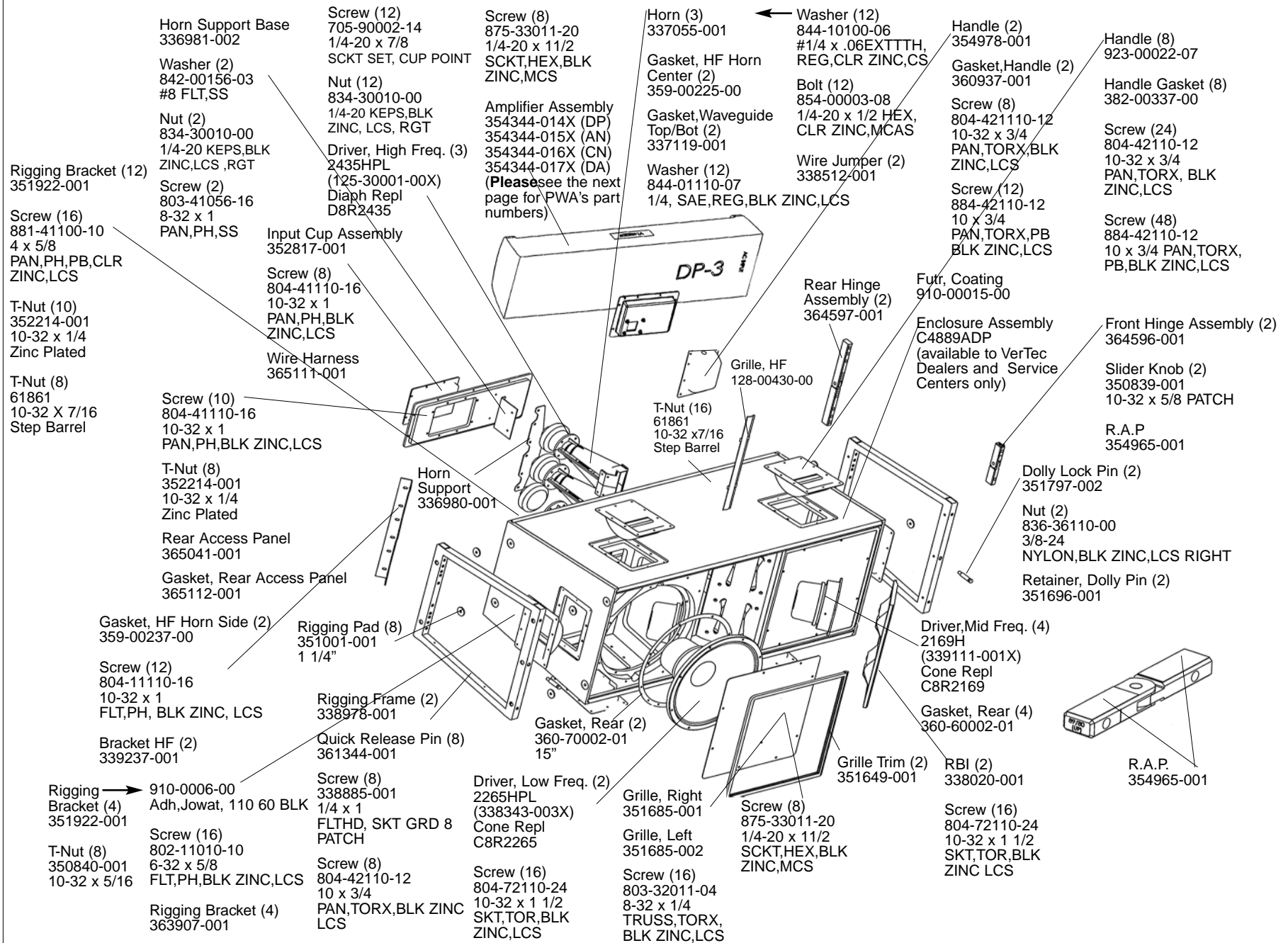

# DP3 AMPLIFIER ASSEMBLY REFERENCE

## AMPLIFIER ASSEMBLY 354344-001

### Amplifier Assemblies

**DP3**

Note: Amplifier assembly includes the input module.

Part No.	Description
354344-001	Amplifier Assembly, Base Model, VT-Series
354344-002X	Amplifier Assembly, VT4888DP
354344-003X	Amplifier Assembly, VT4882DP
354344-004X	Amplifier Assembly, VT4882DP-AN
354344-005X	Amplifier Assembly, VT4882DP-CN
354344-007X	Amplifier Assembly, VT4888DP-AN
354344-008X	Amplifier Assembly, VT4888DP-CN
354344-010X	Amplifier Assembly, VT4880ADP
354344-011X	Amplifier Assembly, VT4880ADP-AN
354344-012X	Amplifier Assembly, VT4880ADP-CN
354344-014X	Amplifier Assembly, VT4889ADP
354344-015X	Amplifier Assembly, VT4889ADP-AN
354344-016X	Amplifier Assembly, VT4889ADP-CN
354344-017X	Amplifier Assembly, VT4889ADP-DA
354344-006X	Amplifier Assembly, VT4882DP-DA
354344-009X	Amplifier Assembly, VT4888DP-DA
354344-013X	Amplifier Assembly, VT4880ADP-DA

### Input Modules

Note: If ordering an input module you must order 1 of the tuning files below depending on the system model number.

	DP-dbx 361541-001X	DP-AN 361092-001X	DP-CN 361093--001X	DP-DA 444668-001X
Model Numbers				
		Tuning File Part Numbers		
VT4888DP	355059-001	361885-001	361886-001	444729-001
VT4882DP	361282-001	361887-001	361888-001	444728-001
VT4889ADP	365137-001	365113-001	365136-001	444731-001
VT4880ADP	365139-001	365114-001	365138-001	444730-001

DP3 AMPLIFIER ASSEMBLY REFERENCE

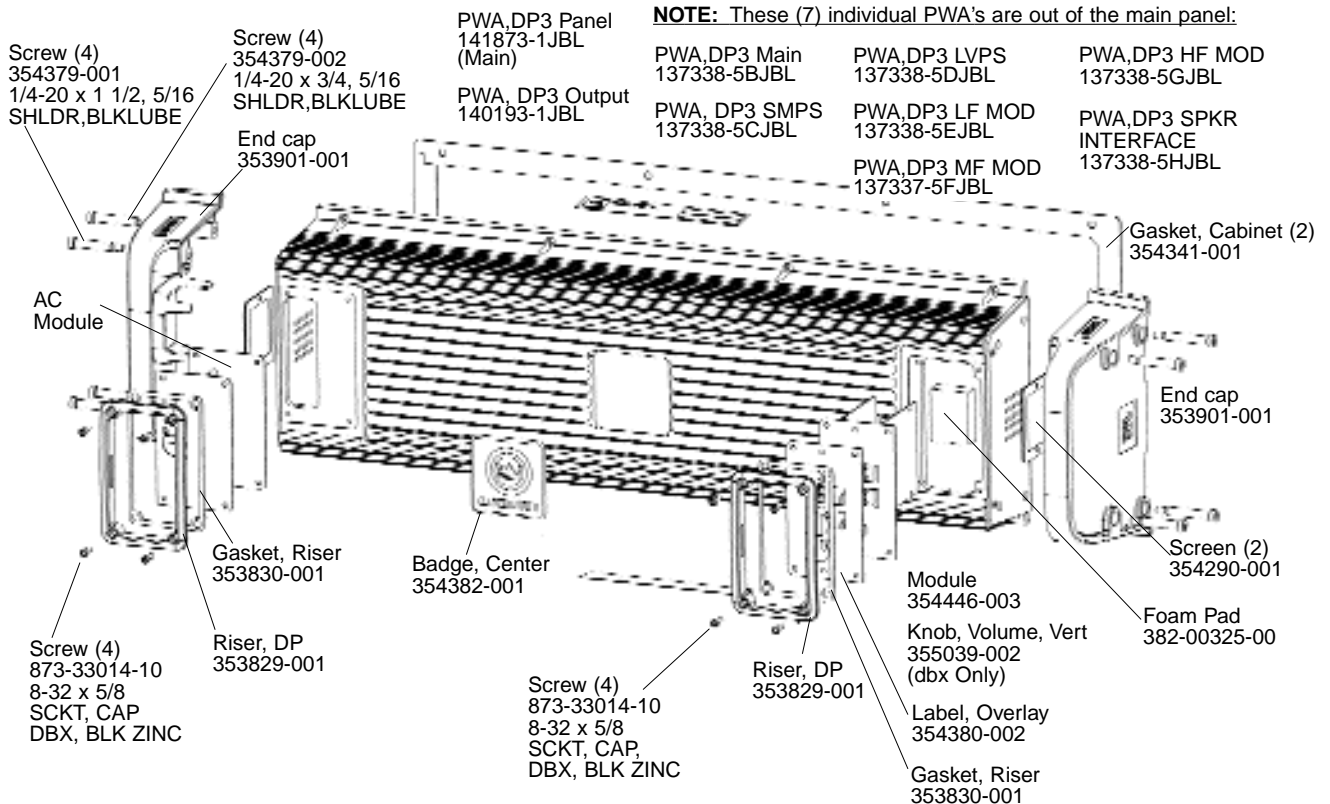

# JBL VT4889ADP-ACC

## DOLLY ASSEMBLY 229-00029-02

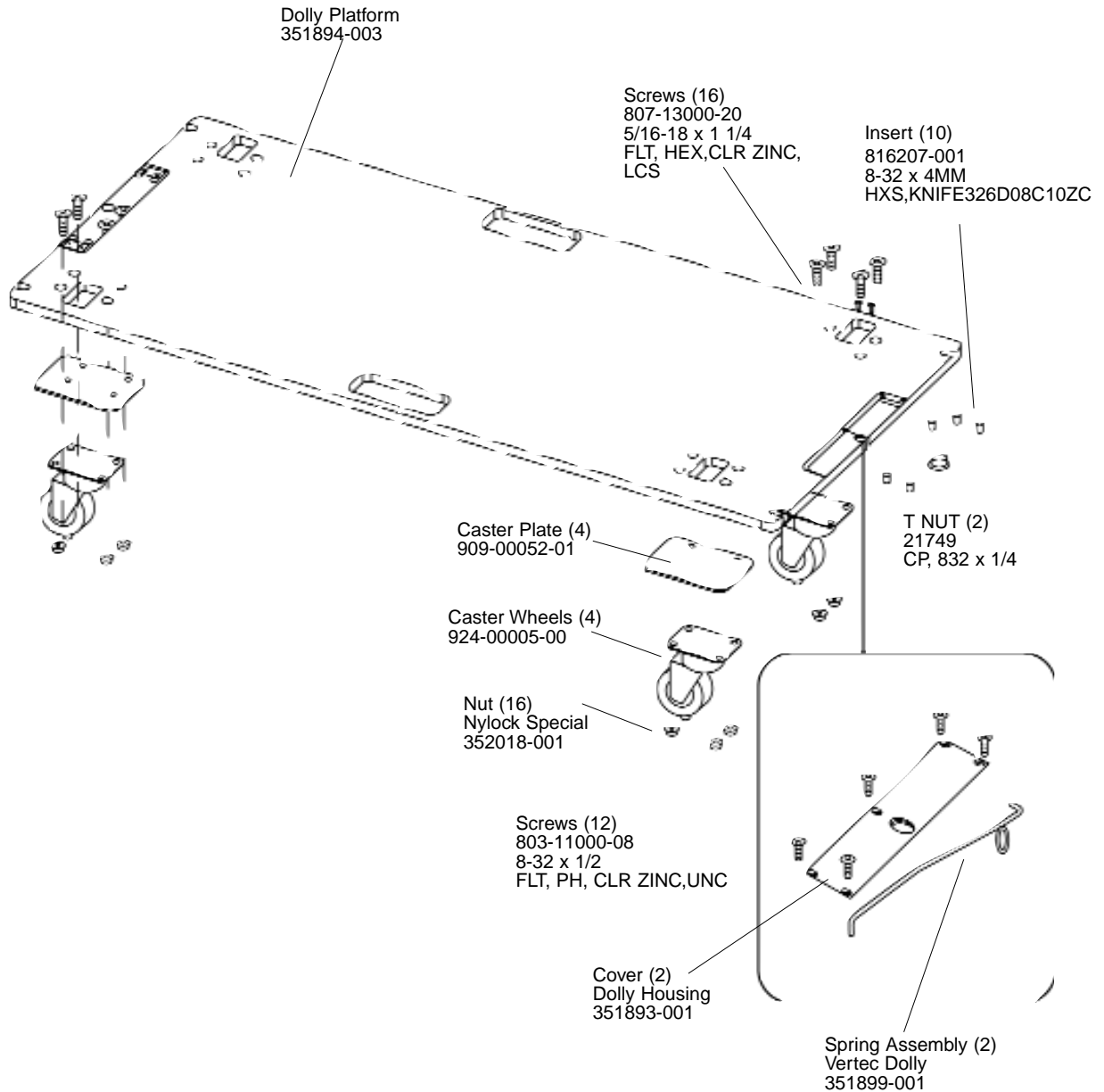

JBL VT4889ADP-ACC

# JBL VT4889-AF

ARRAY FRAME

JBL VT4889-AF

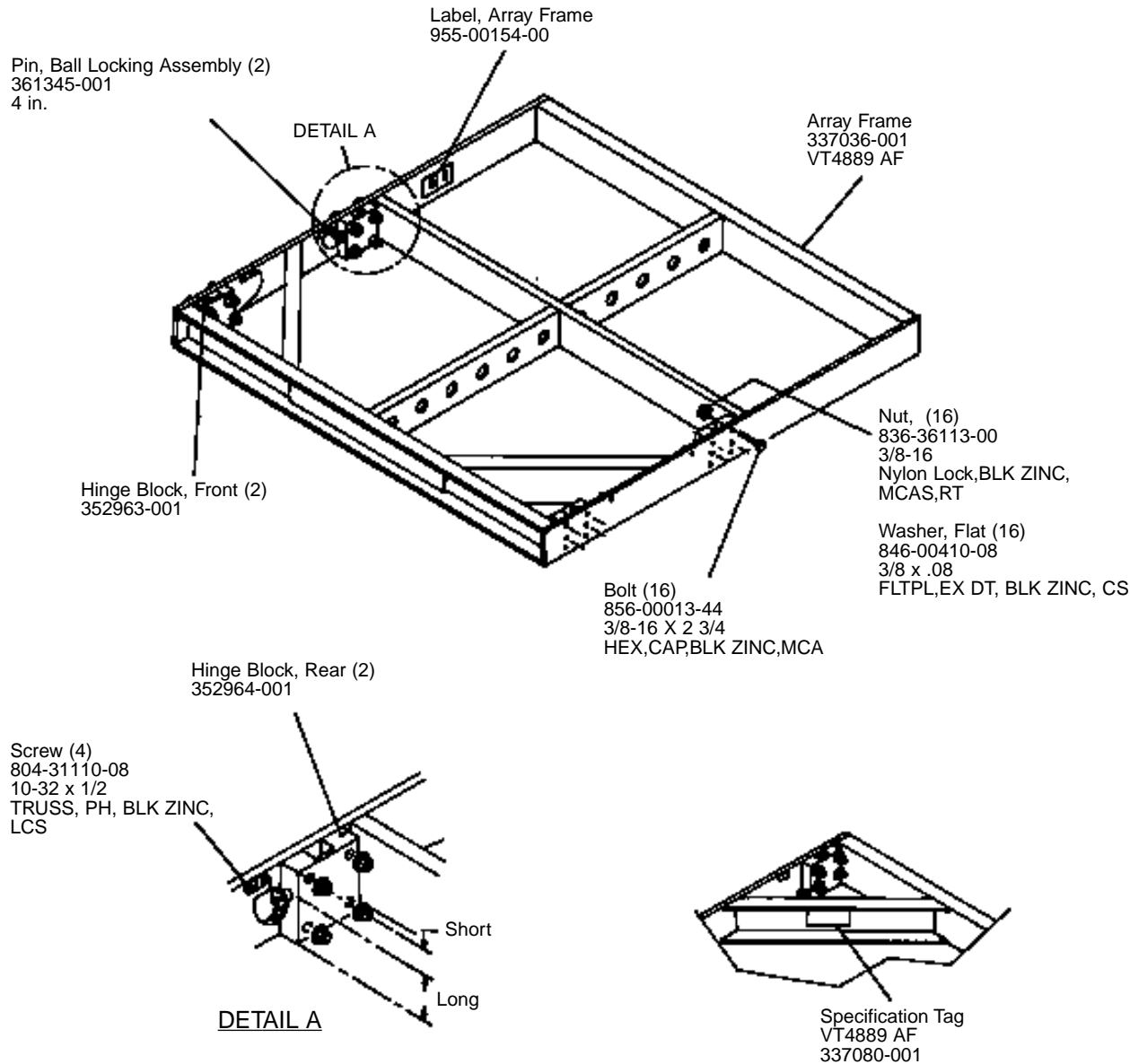

## VT4889-AF (Array Frame)

The VT4889-AF array suspension frame is crafted of 6061 Grade heat-treated aluminum. It includes 11 (eleven) attachment holes for fitting 6.5-ton shackles. Each of these holes is fitted with a bronze bushing for longer life. These holes are set on approximately 102mm (4") centers. Each hole has an I.D. (Inner Diameter) of 25.4mm (1").

The frame includes four receiver blocks, designed to attach Hinge Bars from the VT4889 enclosures. These blocks are made of 7075 Grade aluminum. They are coupled with Grade 8 bolts, and the attached steel quick release pins are secured with stainless steel restraining lanyards.

The VT4889-AF weighs 45 kilograms (100 lbs.) It measures approximately 1257mm x 1129mm x 102mm (49.5" x 44.45" x 4").

VT4889 Manual  
336890-001

# JBL VT4889-SF

ARRAY FRAME (Short Frame)

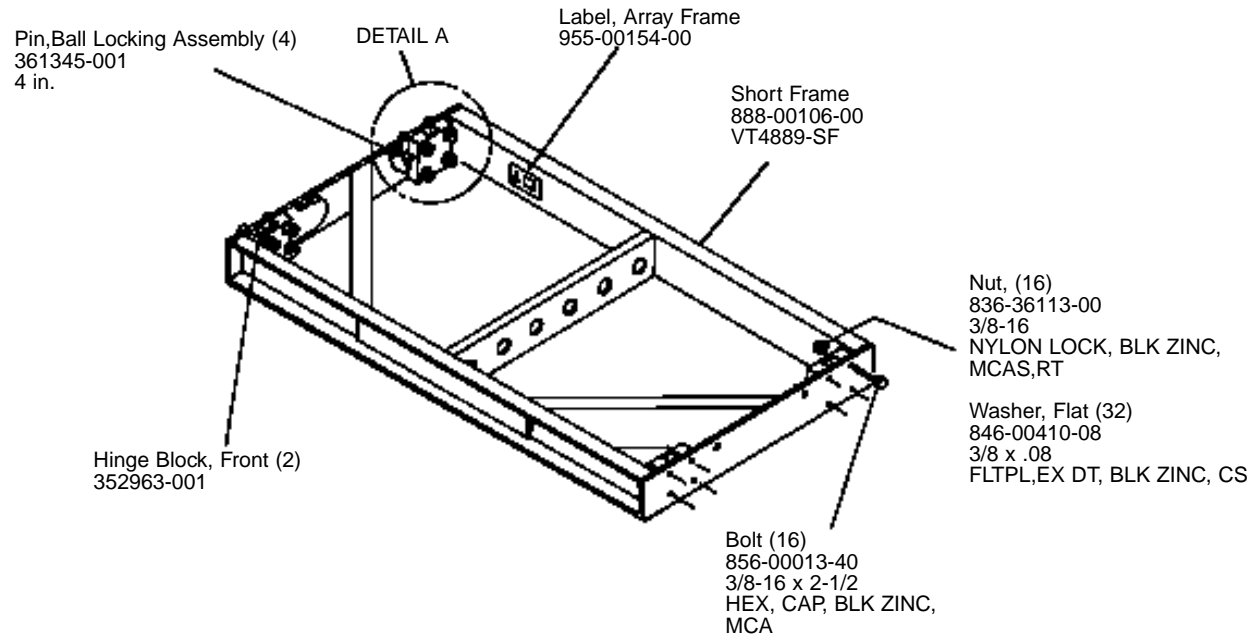

## VT4889-SF (Short Frame)

Like the larger VT4889-AF, the Short Frame is crafted of 6061 Grade heat-treated aluminum. It includes 6 (six) attachment holes. Each hole is fitted with a bronze bushing for longer life. These holes are set on approximately 102mm (4") centers. Each hole has an I.D. (Inner Diameter) of 25.4mm (1"). The frame includes four receiver blocks, designed to attach Hinge Bars from the VT4889 enclosures. These blocks are made of 7075 Grade aluminum. They are coupled with Grade 8 bolts, and the attached steel quick release pins are secured with stainless steel restraining lanyards.

The VT4889-SF weighs only 23.6 kilograms (52 lbs.). It measures approximately 1257mm x 660mm x 102mm (49.5" x 26" x 4").

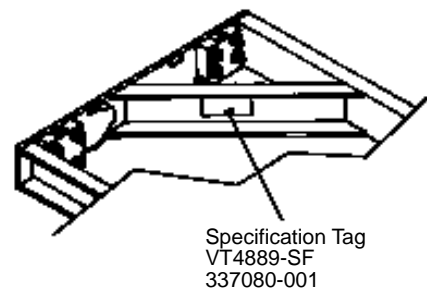
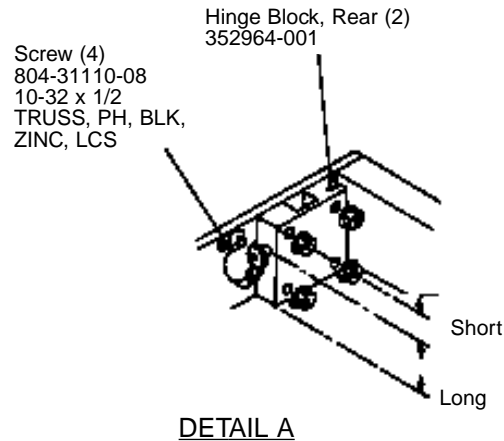

JBL VT4889-SF