

Technical Manual



JBL VT4888

SPECIFICATIONS

ACOUSTIC & ELECTRICAL SPECIFICATIONS:

- Frequency Response: 60 Hz- 16 kHz (± 3 dB)
- Max Peak Output: 136 dB to 146 dB @ 1M
(Frequency/Bandpass Dependent)
- Recommended Signal: Digital System Processing: dbx 480, BSS 366, XTA 226
- Horiz Coverage Angle: 90°, 250 Hz - 16 kHz (-6dB)
- Vert Coverage Angle: Varies with size and configuration(-6dB)
- Crossover Frequency: 315 Hz LF/Mid
1.2 kHz MF/HF

SYSTEMS COMPONENTS:

- Cabinet: Enclosure Assembly C4888
- Grille: Left (350780-002), Right (350780-001)
- Low Frequency Transducer: (2) 2262H, 304 mm (12") dia., 76 mm (3")
Dual Coil Differential Drive
- Nominal Impedance: 8 ohms (Per Driver)
- Input Power Rating: 2000W (8000W peak) 2 hrs.
1400W (5600W peak) 100 hrs.
- Bandpass Sensitivity: 98 dB,1W @ 1m (3.3 ft.)
- DC Resistance: 5.1 Ohms
- Mid Frequency Transducer: (4) 2106HPL, 50 mm (2") dia. Voice Coil
- Nominal Impedance: 8 Ohms (Per Driver)
- Input Power Rating: 600W (2400W peak) 100 hrs.
400W (1600W peak) 100 hrs.
- Bandpass Sensitivity: 102 dB,1W @ 1m (3.3 ft.)
- DC Resistance: 4.3 Ohms

SYSTEMS COMPONENTS (Cont):

- High Frequency Transducer: (2) 2431H, 76 mm (3") dia. Aluminium Diaphragm, 38mm (1.5") Throat Dia.
- Nominal Impedance: 8 ohms (Per Driver)
- Input Power Rating: 150W (600W peak) 100 hrs.
- Bandpass Sensitivity: 114 dB,1W @ 1m (3.3 ft.)
- DC Resistance: 4.0 Ohms

AURAL SWEEP TEST SPECIFICATIONS:

- A. System Aural Sweep Test (thru processor measured as amp output): 6V, 40 Hz to 20 kHz
- B. LF Woofer Aural Sweep Test: 6V, 40 Hz to 1 kHz
- C. MF Woofer Aural Sweep Test: 3V, 400 Hz to 4 kHz
- D. HF Driver Aural Sweep Test: 1.5V, 800 Hz to 20 kHz

PHYSICAL SPECIFICATIONS:

- Enclosure Dimensions: 355.6 mm x 990.6 mm x 508 mm D
(14 x 39 x 20 in. D)
- Shipping Weight: VT4888 130 lbs. (59 kg)
VT4888-ACC 30 lbs. (13.6 kg)

WARRANTY INFORMATION:

- Refer to Warranty Statement packed with each product.

PACKAGE

- Filler (1) 35862-001
- Microfoam (4) 49790P
- Carton 351861-001
- Fiberglass (13) 22389P
- Chip FBRBRD (38) 300982-001

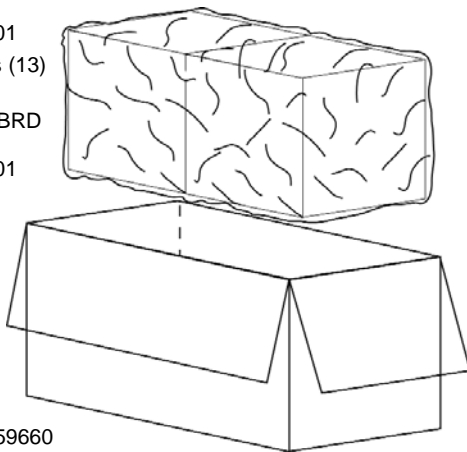

- Warranty 59660
- Specification Sheet 350620-001

- Dolly Assembly 350519-002

- Carton 350521-001

- Filler, Bottom (2) 350522-001

- Filler, Top (2) 351401-001

- Soft Cover 350520-001

- 910-00035-01 (1) Ferro fluid vial w/ blotter paper and instruction sheet

- 910-00035-02 (12) Ferro fluid vials w/ blotter paper and instruction sheet

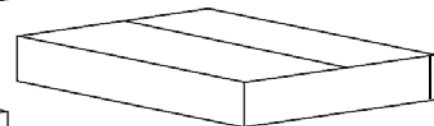
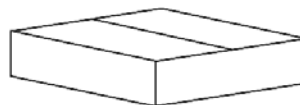

- JBL VT4888-AF Carton 350484-001
- Filler (2) 350486-001
- Owner's Manual 350485-001

- JBL VT4888-SF Carton 350706-001
- Filler (2) 350713-001
- Owner's Manual 350485-001

JBL VT4888 REV AAB

JBL VT4888

WIRING DIAGRAM

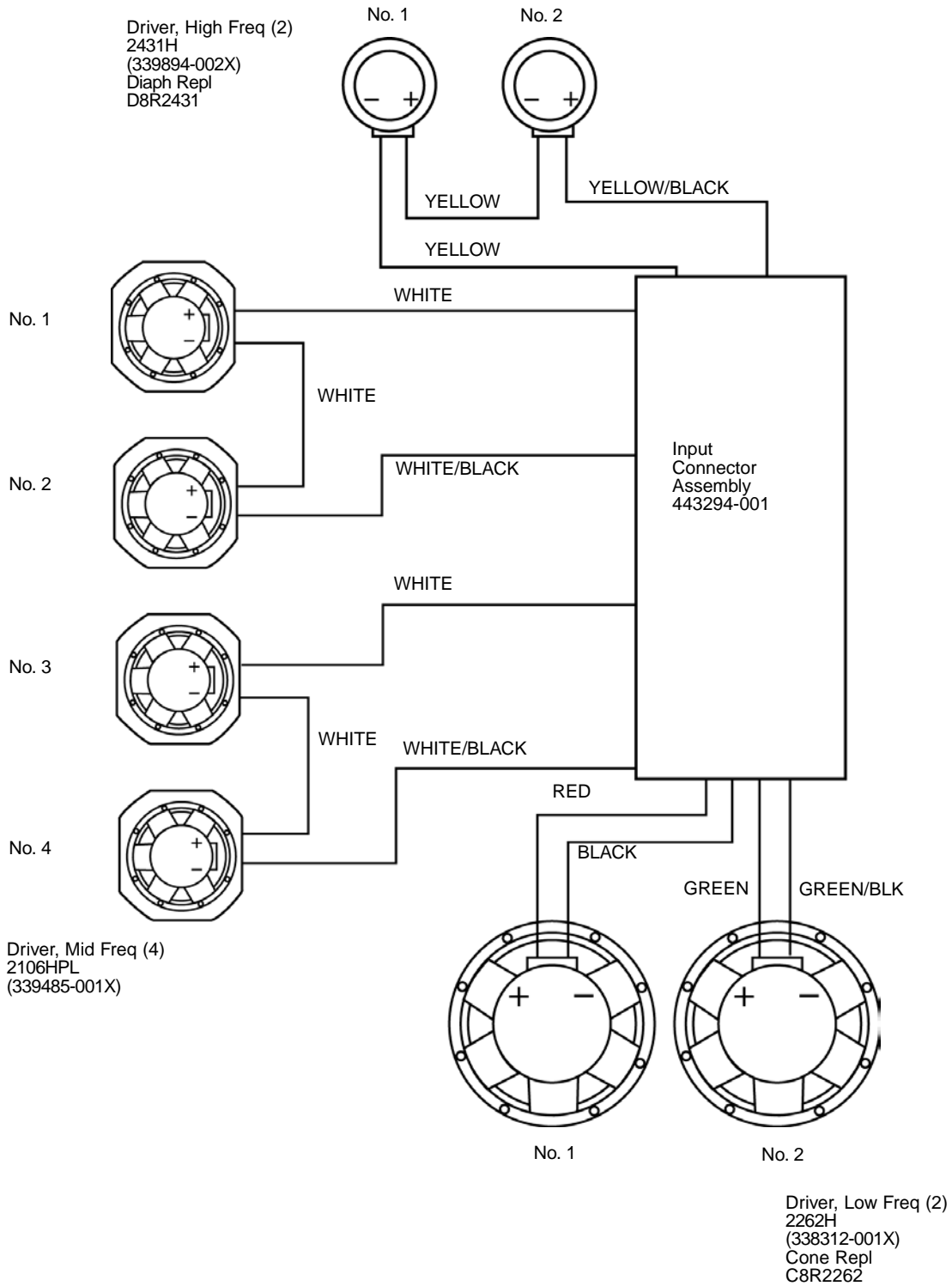

JBL VT4888

SCHEMATIC DIAGRAMS

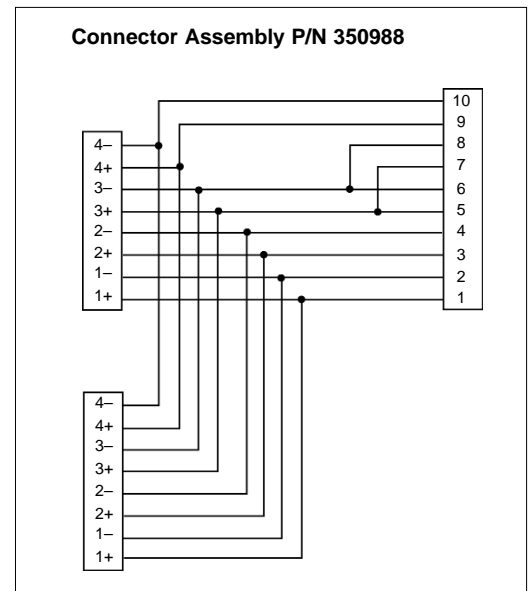
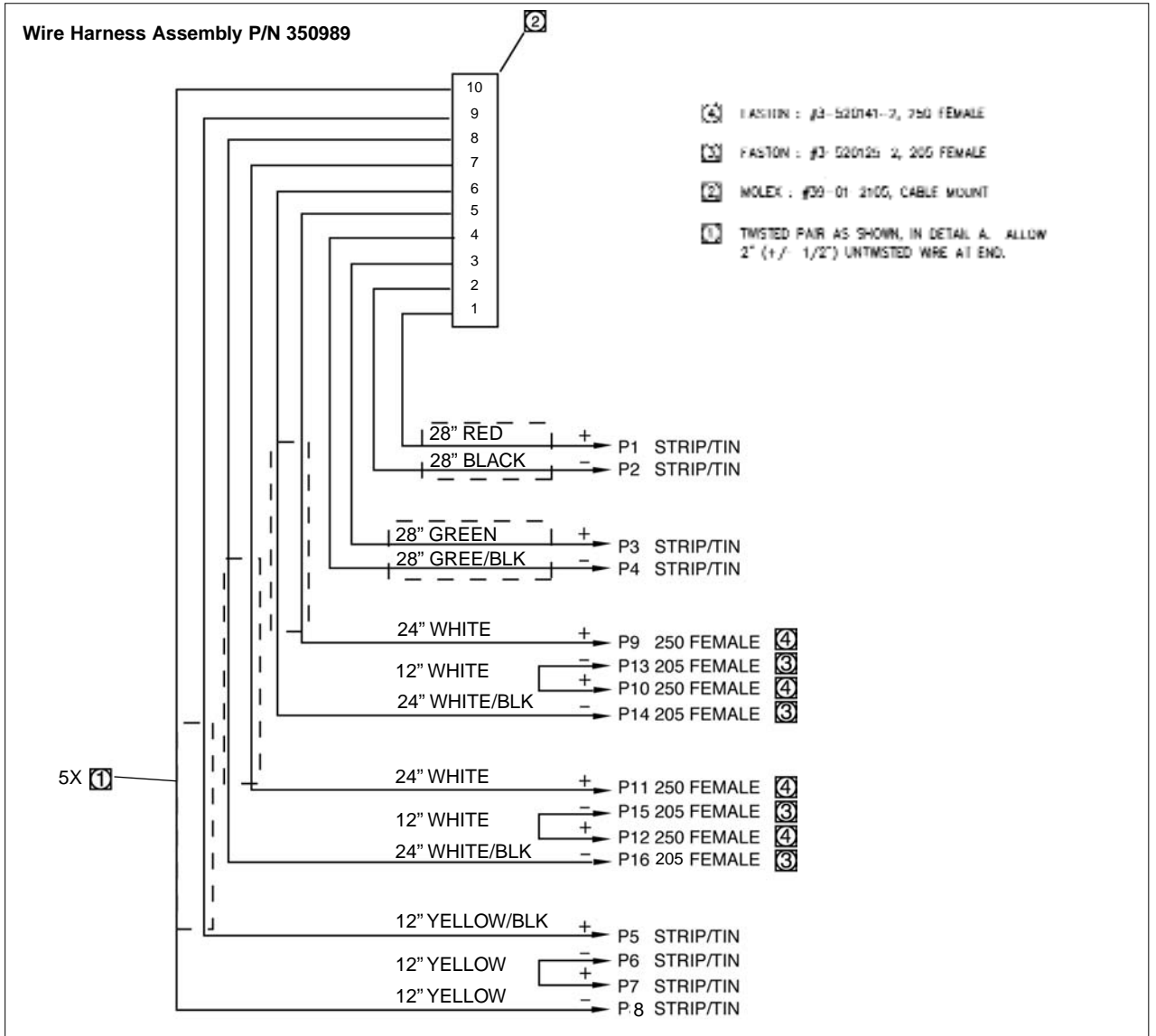

JBL VT4888

COMPONENT EXPLODED VIEW

Enclosure Assy
C4888
(available to VerTec
Dealers and
Service Centers)

HF Center Horn
Gasket
359-00225-00

Bolt, (8)
854-00003-08
1/4-20 x 1/2
HEX, CLR, ZINC,
MCAS

External Tooth Lock
Washer (8) 1/4"
844-10100-06
REG, CLR, ZINC, CS

Washer (8)
844-01110-07
1/4,SAE,REG,BLK,
ZINC,LCS

Front Hinge (2)
364136-001

Slider Knob (2)
350839-001
10-32 x 5/8

Screws (32)
804-72110-24
10-32 x 1
SKT, TORX,
BLK, ZINC, LCS

RBI Assy (2)
350779-001

Screw (2)
804-72110-24
10-32 x 1 1/2
SCT,TORX,
BLK ZINC,
LCS

Driver, Mid Freq (4)
2106H
(339485-001X)

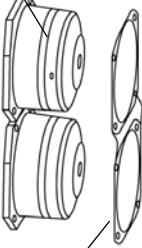

Mid-Range Gasket (2)
350819-001

H/F Grille
350827-001

Grille Right
350780-001

Grille Left
350780-002

Grille Trim (2)
351526-001

Screws (16)
803-32011-04
8-32 x 1/4
TRUSS,TORX,BLK
ZINC,LCS

Standoff (16)
885-00082-01
8-32, 3/8
HEX 1/4, SS

Driver, Low Freq
2262H (2)
(338312-001X)
Cone Repl
C8R2262

Screw (16)
804-72110-24
10-32 x 1 1/2
SKT,TORX,BLK ZINC,
LCS

Grille Insert Nut (16)
350618-001

HF Flare
351486-001

Screws (8)
881-11110-08
4 x 1/2
FLT, PH, PB,
BLK,ZINC

Dolly Lock Pin (2)
351797-002

Nut (2)
836-36110-00
3/8-24
Nylon,BLK, ZINC,
LCS

Dolly Retainer, Pin
(2) 351696-001

Gasket 12" (2)
339391-001

Horn Bracket (2)
350782-001

Screws (6)
804-11110-16
10-32 x 1
FLT, PH, BLK,
OXIDE, LCS

Horn (2)
337055-001

Rigging Bracket (8)
351922-001

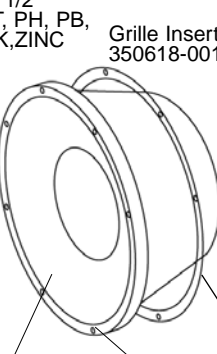

Front Rigging
Tube (2)
350572-002

Screw (4)
338885-001
1/4 x 1
FLTHD
SOCKT GRD
8, PATCH

Handle (6)
923-00022-07

Gasket (6)
382-00337-00
Handle

Driver, High Freq (2)
2431H
(339894-002X)
Diaph Repl
D8R2431

Screw (8)
705-90002-14
1/4-20 x 7/8
SOCKET SET
CUP POINT

Nut (8)
834-30010-00
1/4-20
KEPS, BLK ZINC,
LCS,RIGHT

Threadlocker
69437
Locktite 242

Waveguide Gasket (2)
350841-001

Horn Gasket
Top/Bottom (2)
351415-001

Washer, Amp Mount (8)
351905-002
7/8"
(Drive Pack Attachment
only)

Screw (8)
806-42010-16
1/4-20 x 1
PAN,TORX,BLK ZINC,
LCS
(Cabinet Back)

Screw (8)
804-42110-12
10-32 x 3/4
PAN, TORX,
BLK ZINC,
LCS

Input
Connector
443294-001

Wire Harness
350989-001

Connector
Assembly
350988-001

Rear Hinge
Assy. (2)
364137-001

Screws (4)
338885-001
1/4 x 1 FLTHD
Socket Grade
8,PATCH

Quick Release
Pin, (8)
361343-001

Rear Rigging
Tube (2)
350573-002

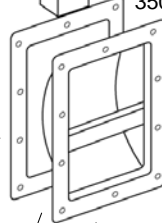

JBL VT4888-ACC

DOLLY ASSEMBLY

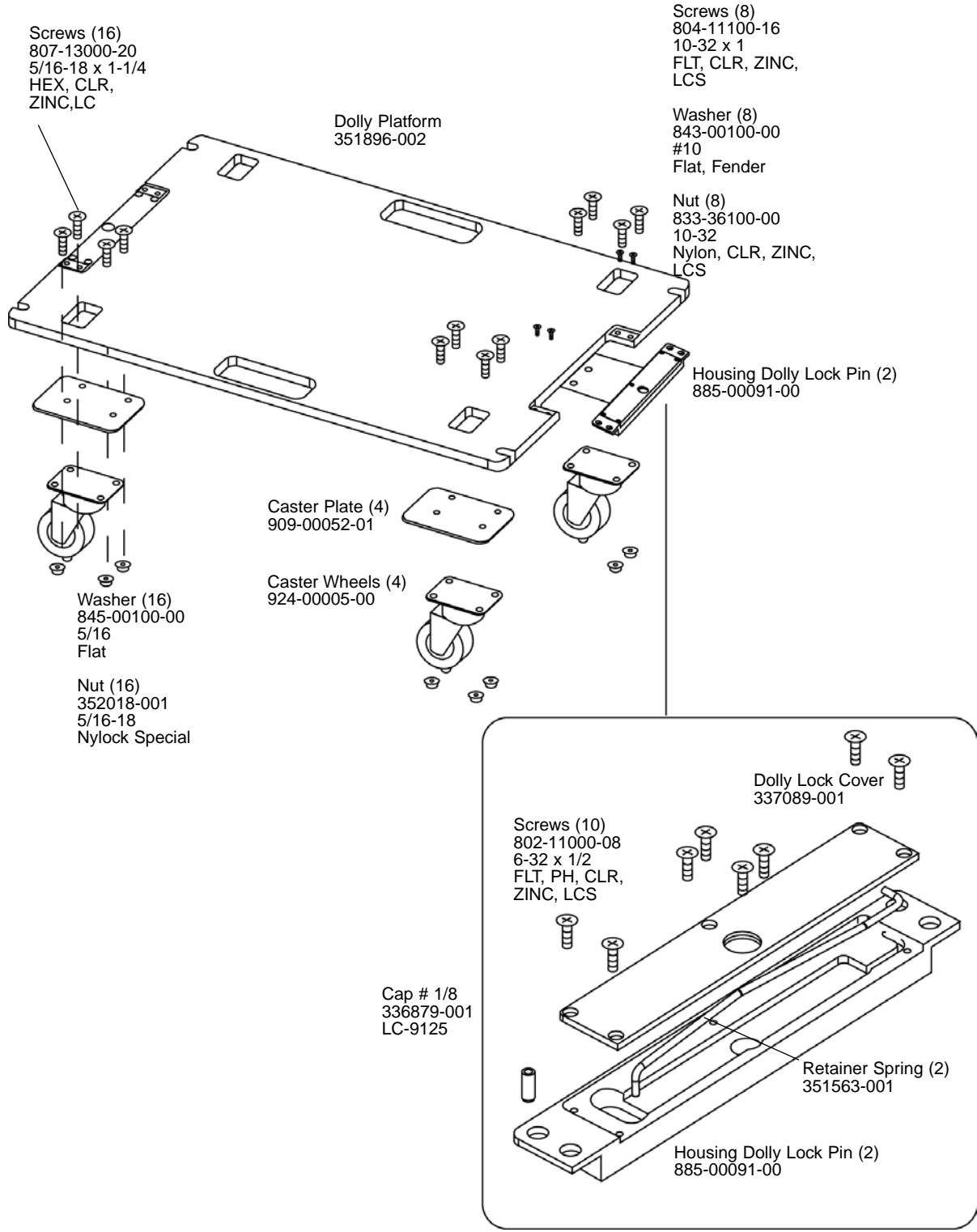

Screws (16)
807-13000-20
5/16-18 x 1-1/4
HEX, CLR,
ZINC,LC

Dolly Platform
351896-002

Screws (8)
804-11100-16
10-32 x 1
FLT, CLR, ZINC,
LCS

Washer (8)
843-00100-00
#10
Flat, Fender

Nut (8)
833-36100-00
10-32
Nylon, CLR, ZINC,
LCS

Housing Dolly Lock Pin (2)
885-00091-00

Caster Plate (4)
909-00052-01

Caster Wheels (4)
924-00005-00

Washer (16)
845-00100-00
5/16
Flat

Nut (16)
352018-001
5/16-18
Nylock Special

Dolly Lock Cover
337089-001

Screws (10)
802-11000-08
6-32 x 1/2
FLT, PH, CLR,
ZINC, LCS

Cap # 1/8
336879-001
LC-9125

Retainer Spring (2)
351563-001

Housing Dolly Lock Pin (2)
885-00091-00

JBL VT4888-ACC

REV B

DOLLY ASSEMBLY 350519-002

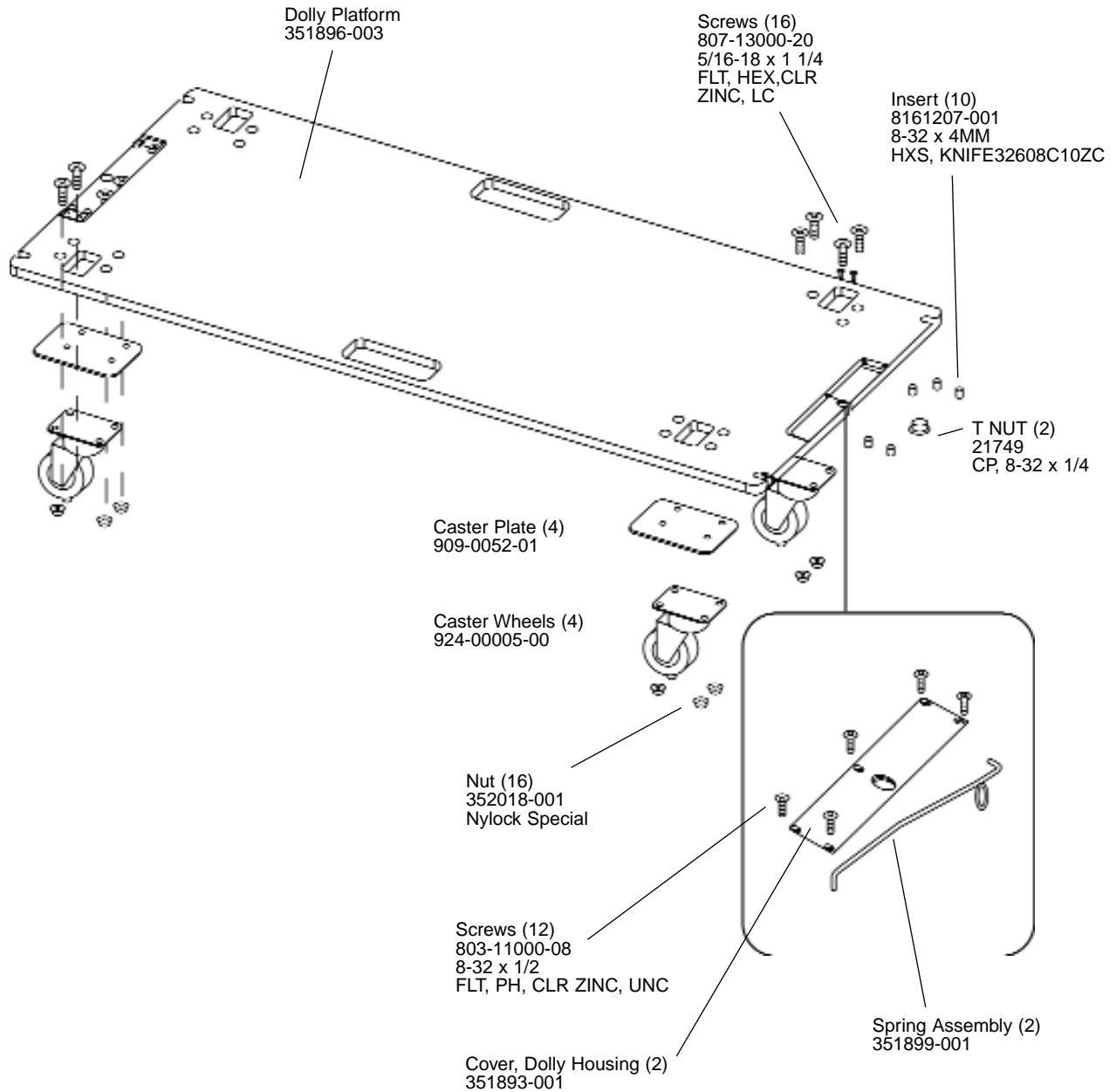

JBL VT4888-ACC

JBL VT4888-SF

ARRAY FRAME ASSEMBLY

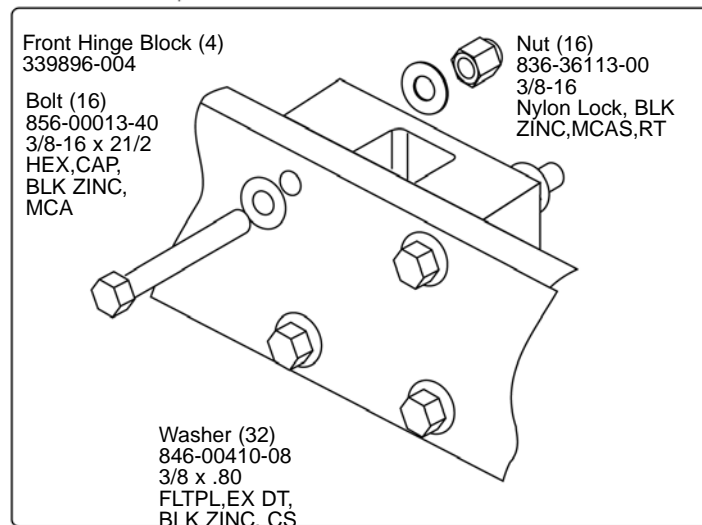
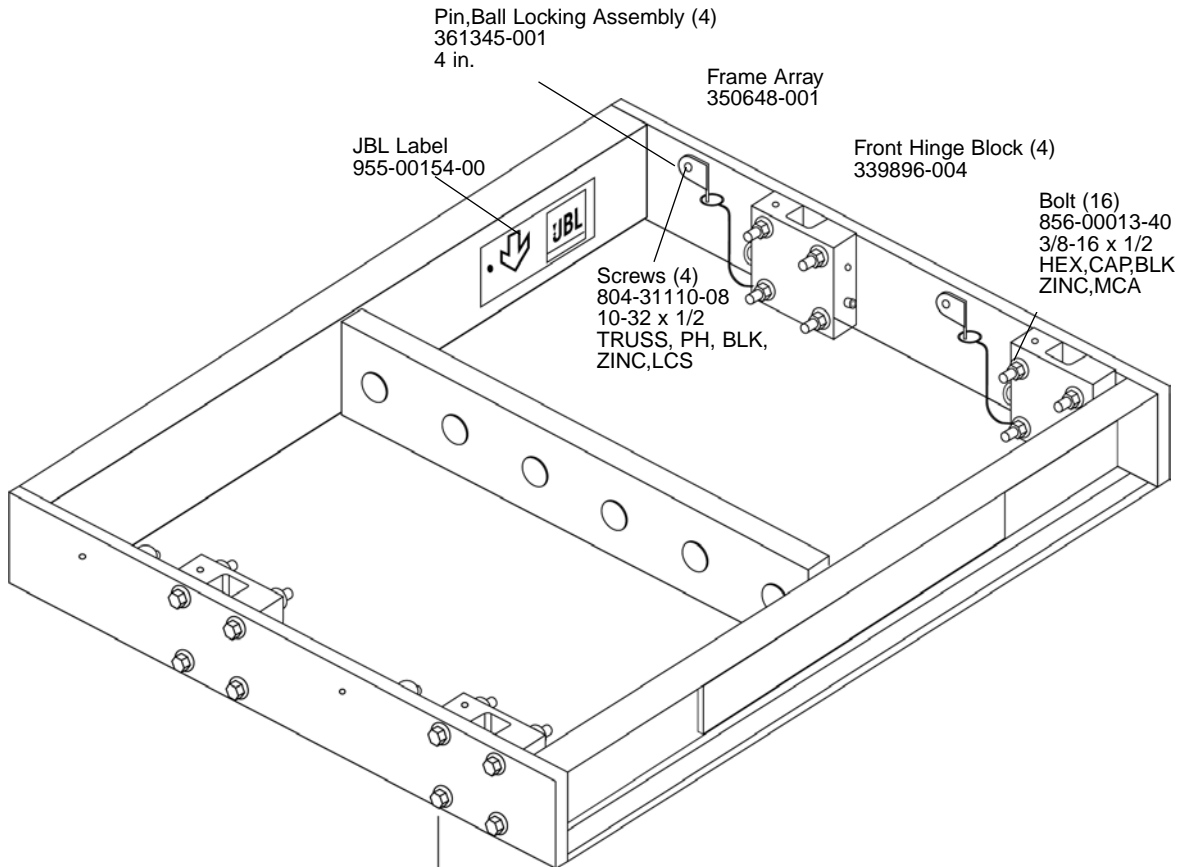

JBL VT4888-AF

ARRAY FRAME ASSEMBLY

