

# Technical Manual



# JBL VT4881A

## SPECIFICATIONS

### ACOUSTIC & ELECTRICAL SPECIFICATIONS:

- Nominal Impedance: 8 ohms
- Input Power Rating: 600 Continuous Pink Noise
- Frequency Response: 34 Hz-125 Hz ( $\pm 10$  dB)
- Frequency Range: 25 Hz-125 Hz ( $\pm 3$  dB)
- Sensitivity: 91dB, 2.83 Vrms. @ 1m
- Max Peak Output: 136 dB @ 1m (half-space, grounded)  
130 dB @ 1m (free-space, suspended)
- Recommended Signal Processing: dbx 4800<sup>(R)</sup>, Crown<sup>(R)</sup> I-Tech, BSS FDS-366, and other Digital System Controllers supported.
- Crossover Frequency: 125 Hz

### SYSTEMS COMPONENTS:

- Grille: 354690-001
- Low Frequency Transducer: 2269H, 460 mm (18 in.) 100 mm (4 in.) Dual Coil, Neodymium Differential Drive<sup>(R)</sup>, Direct Cooled<sup>(TM)</sup>
- DC Resistance: 2.7 ohms

### AURAL SWEEP TEST SPECIFICATIONS:

- A. System Aural Sweep Test: 7.0V Input, 20 Hz to 1 kHz
- B. LF. Aural Sweep Test: 10.0V Input, 10 Hz to 300 Hz

### PHYSICAL SPECIFICATIONS:

- Enclosure Dimensions: 787 mm x 569 mm x 654 mm  
(31 in. x 22.4 in. x 25.8 in.)
- Net Weight: 111 lbs. (50.4 kg)
- Shipping Weight: 132 lbs. (59.9 kg)

### WARRANTY INFORMATION:

- Refer to Warranty Statement packed with each product.

## PACKAGE

- Warranty 59660
- Specification Sheet 360855-001
- Filler (2) 351866-001
- Microfoam (8) 49790P
- Carton 351865-001
- VT4881A-ACC
- Dolly Assembly 350434-003
- Carton 350531-001
- Filler,(2) Bottom 350532-001
- Filler,Top (2) 351391-001
- Soft Cover 361340-001
- JBL VT4887-AF
- Carton 350712-001
- Filler, (2) 350713-001
- Owner's Manual 350485-001

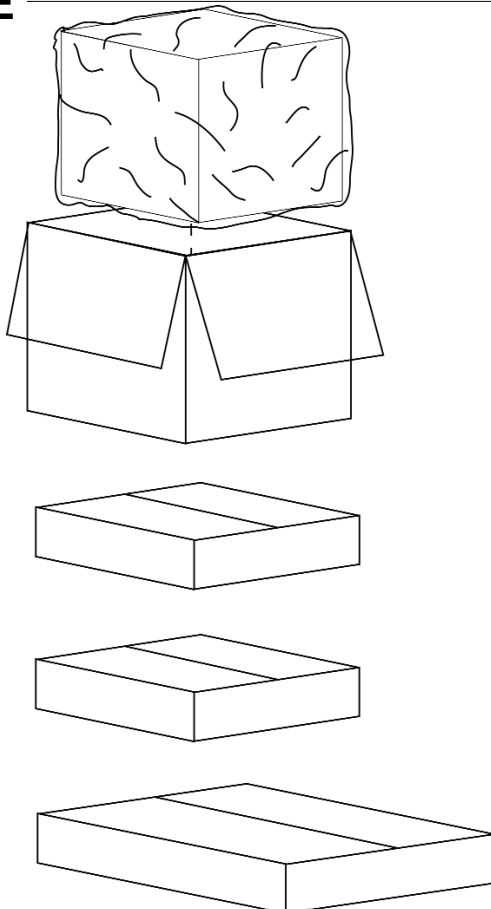

- JBL VT4887-SF
- Carton 350487-001
- Filler (2) 350486-001
- Owner's Manual 350485-001

## WIRING

Driver, Low Freq.  
2269H  
(354096-001X)  
Cone Repl  
C8R2269

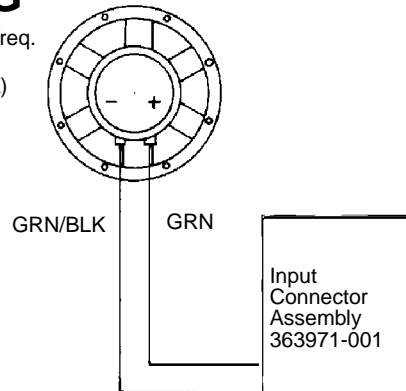

SCHEMATIC: 362309-001  
Wiring Harness

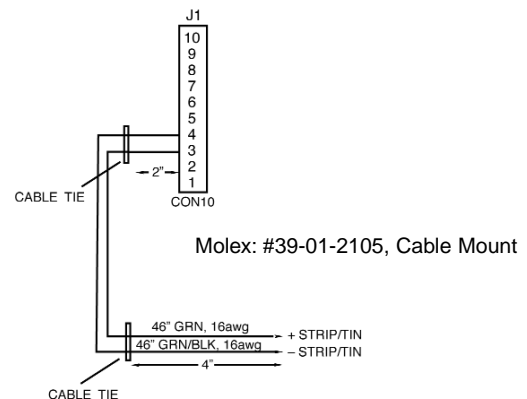

JBL VT4881A REV F

# JBL VT4881A

## SCHEMATIC DIAGRAM

Connector Assembly Diagram P/N 363968

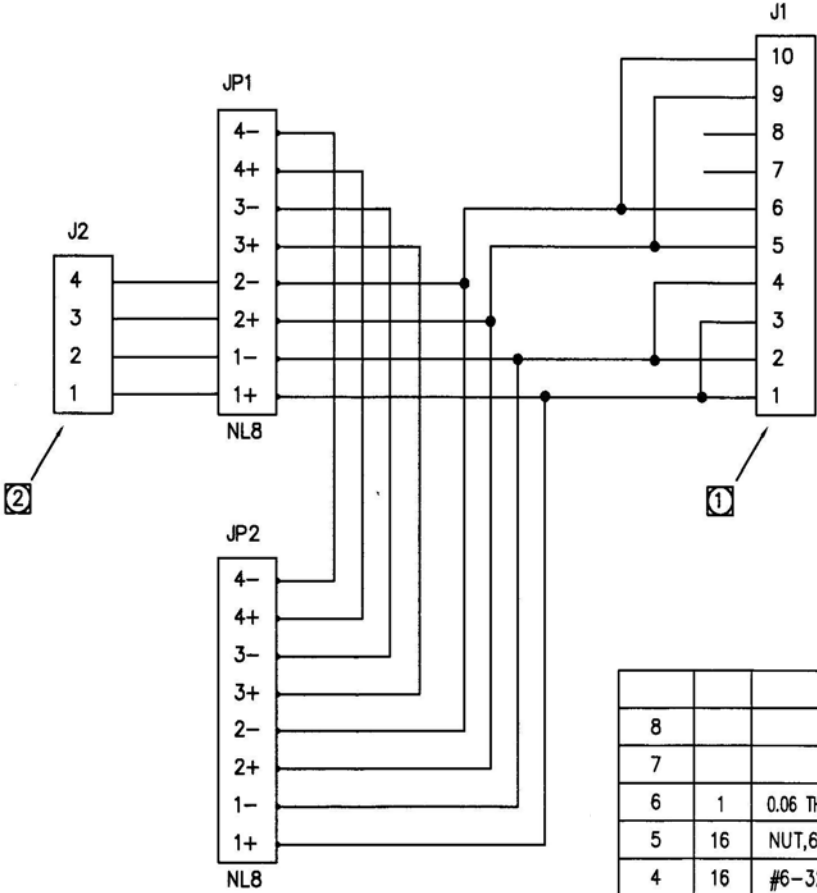

ITEM #	QTY	DESCRIPTION	P/N REF
8			
7			
6	1	0.06 THK NEOPRENE FOAM GASKET W/PSA	
5	16	NUT,6-32, K LOCK, ZINC, LCS	801-30000-00
4	16	#6-32 X 1/2, FL, PH, BLK	702-11010-08
3	1	PCB ASSY, NL-4	352595-001
2	1	INPUT PCB, NL-8	363968-001
1	1	MOUNTING PLATE, VT48XX	352588-001

352595-001  
(NL-4)

MOLEX #39-01-4041 OR ENG EQUIV.

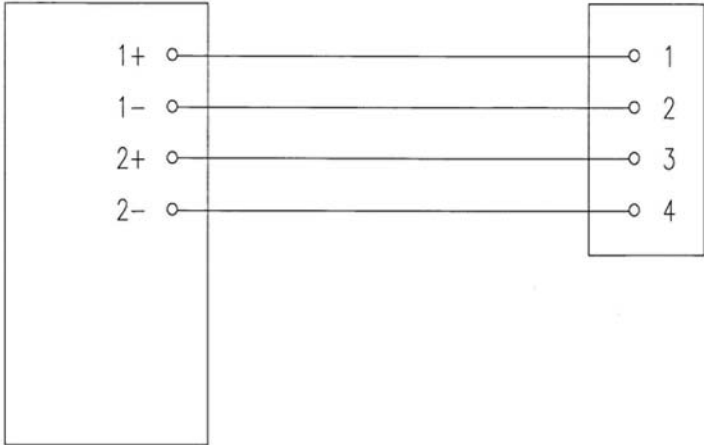

# JBL VT4881A

## COMPONENT EXPLODED VIEW

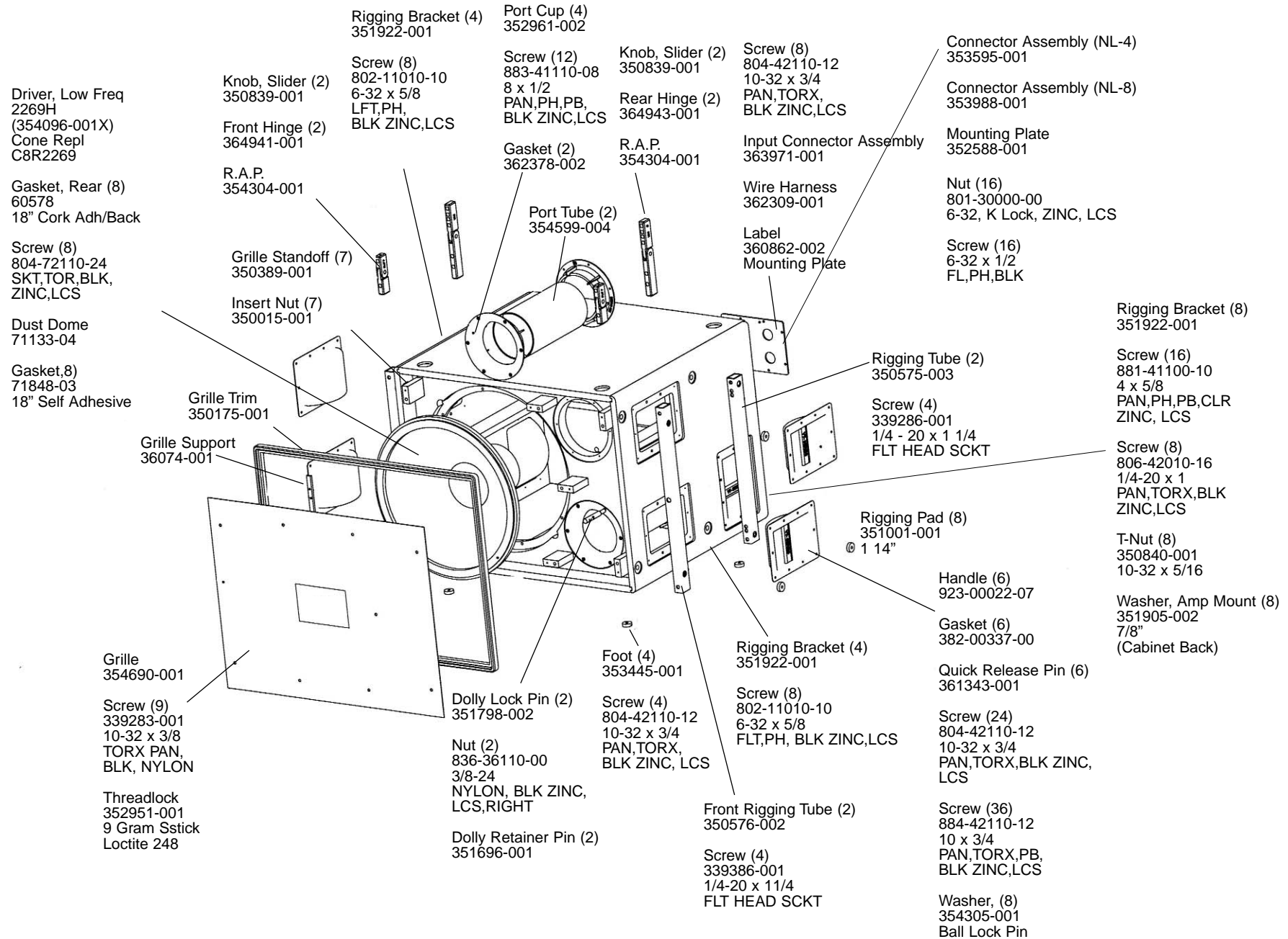

# JBL VT4881A-ACC

## DOLLY ASSEMBLY

350434-003

Screw (8)  
807-13000-20  
5/16-18 x 1-1/4  
FLT HEX, CLR,  
ZINC,LC

Dolly Platform  
351895-002  
(w/c'sink holes)

Screw (8)  
807-13000-20  
5/16-18 x 1-1/4  
FLT HEX, CLR  
ZINC,LC

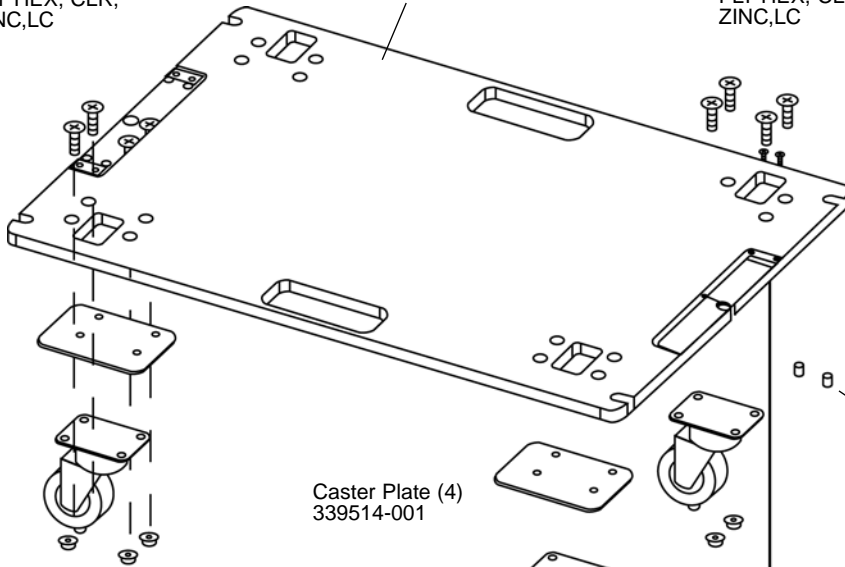

T-Nut (2)  
21749  
8-32 x 1/4  
CP

Insert (10)  
8161207-001  
8-32 x 4MM  
HXS,KNIFE32608C10ZC

Caster Plate (4)  
339514-001

Caster Wheels (4)  
339513-001

Nut (16)  
352018-001  
Nylock Special

Screw (12)  
803-11000-08  
8-32 x 1/2  
FLT,PH,CLR,  
ZINC,UNC

Cover,Dolly Housing (2)  
351893-001

Spring Assembly (2)  
351899-001

JBL VT4881A-ACC

# JBL VT4887-SF

## ARRAY FRAME ASSEMBLY

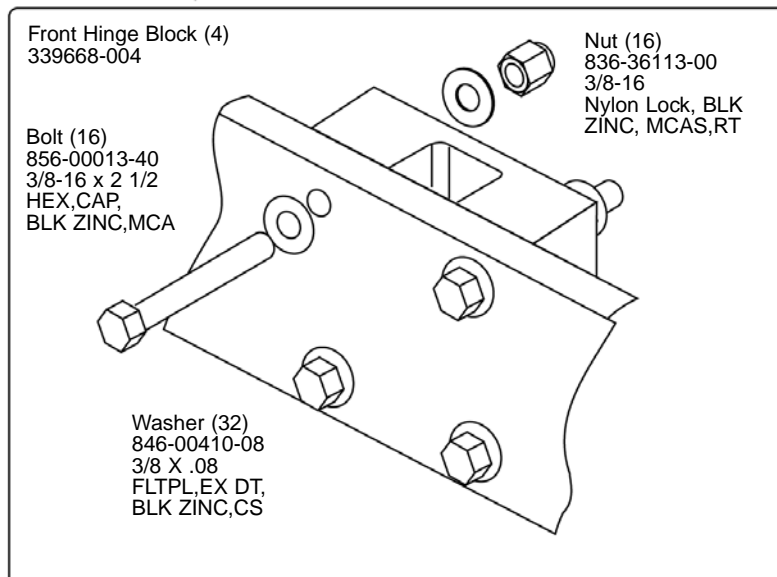
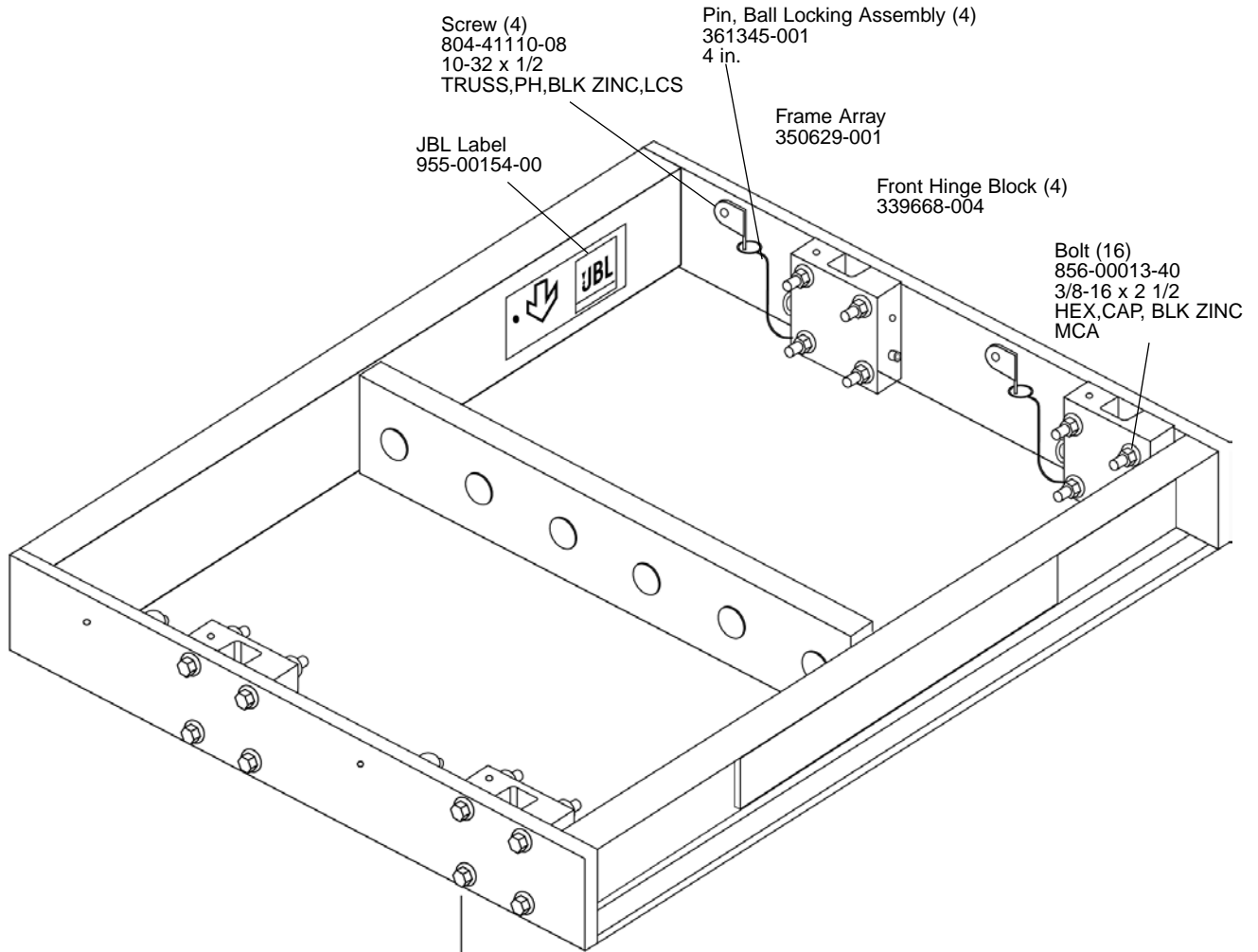

JBL VT4887-SF

# JBL VT4887-AF

## ARRAY FRAME ASSEMBLY

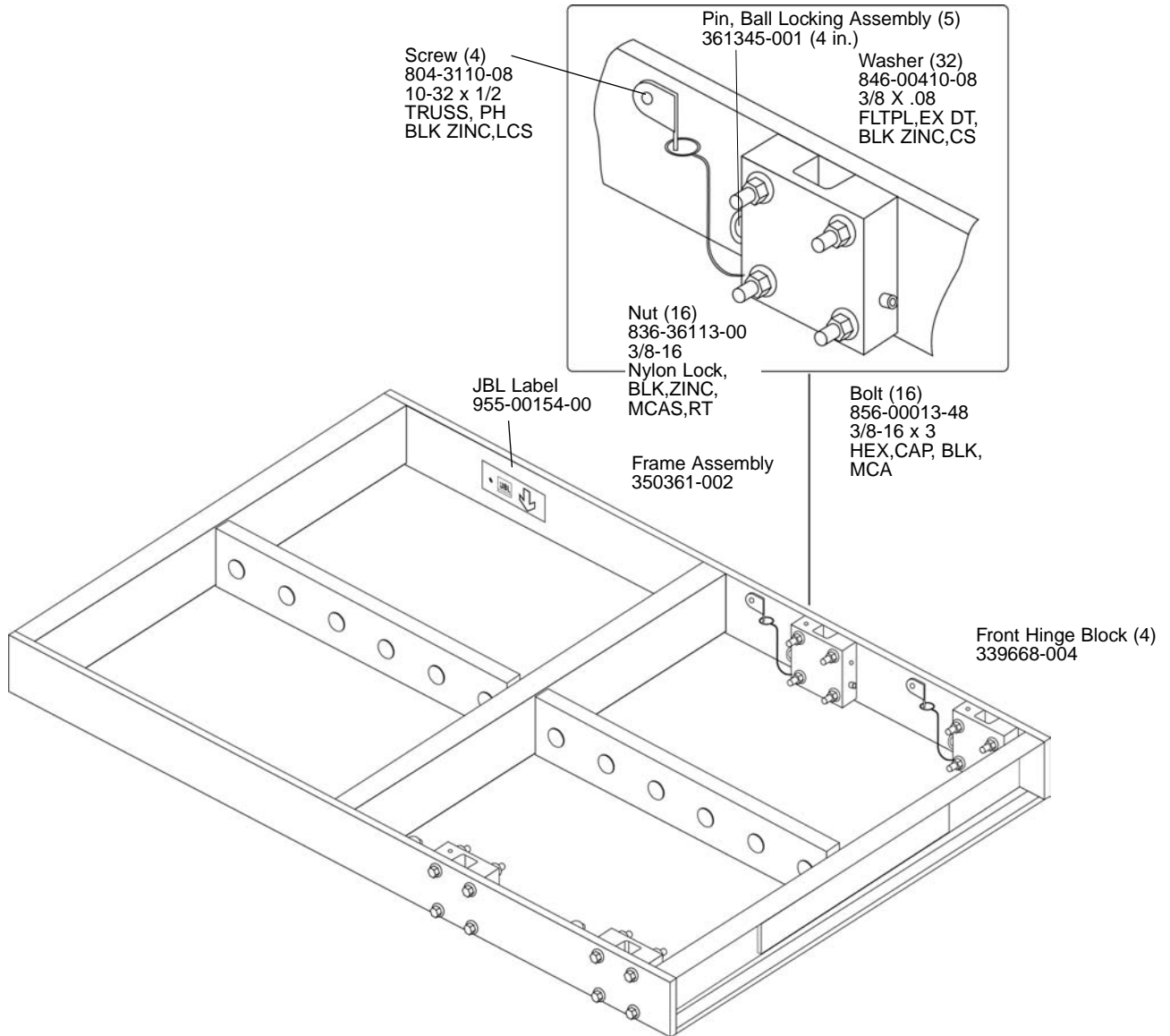

JBL VT4887-AF