

Technical Manual



JBL VT4881

SPECIFICATIONS

ACOUSTIC & ELECTRICAL SPECIFICATIONS:

- Frequency Response: 22 Hz-125 Hz (± 3 dB)
- Sensitivity 90dB, 2.83 Vrms. @ 1m (25 Hz - 85 Hz)
- Max Peak Output: 126 dB @ 1M
(Frequency/Bandpass Dependent)
- Recommended Signal Processing: Digital System Controller: dbx 480, BSS 366, XTA 226 Supported
- Crossover Frequency: 125 Hz

SYSTEMS COMPONENTS:

- Cabinet: Enclosure Assembly C4881
- Grille: (350810-001)
- Low Frequency Transducer: (1) 2256G, 380 mm (15 in.)
76 mm (3 in.) Dual Coil Differential Drive

- Nominal Impedance: 8 Ohms (Each Coil)
- Input Power Rating: 600W Continuous Pink Noise
- Bandpass Sensitivity: 90 dB, *SPL (System Bandpass)
- DC Resistance: 2 x 6.0 Ohms

AURAL SWEEP TEST SPECIFICATIONS:

- A. System Aural Sweep Test: 10.0V Input, 10 Hz to 100 Hz
- B. LF. Aural Sweep Test: 10.0V Input, 10 Hz to 100 Hz

PHYSICAL SPECIFICATIONS:

- Enclosure Dimensions: 566 mm x 787 mm x 655 mm D
(22 x 31 x 25.8 in. D)
- Shipping Weight:
 - VT4881 114 lbs. (58.1 kg)
 - VT4881-ACC 35.5 lbs. (16.1 kg)

WARRANTY INFORMATION:

- Refer to Warranty Statement packed with each product.

SYSTEMS COMPONENTS (Cont.):

PACKAGE

Warranty 59660
Specification Sheet
350621-001

Filler (2)
351866-001

Microfoam (8)
49790P

Carton
351865-001

Dolly
Assembly
350434-002
and
350434-003

Soft Cover
350530-001

Carton
350531-001

Filler, Bottom
(2)
350532-001

Filler, Top (2)
351391-001

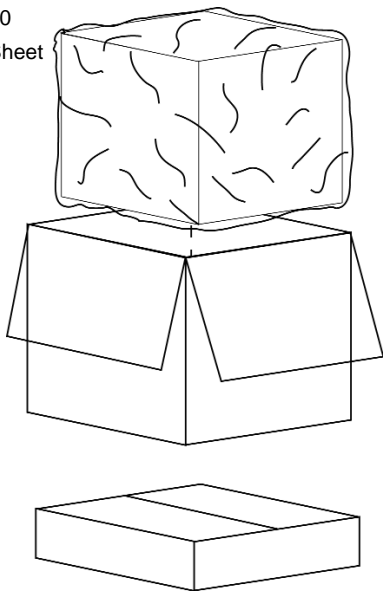

JBL VT4887-SF	JBL VT4887-AF
Carton 350712-001	Carton 350487-001
Filler (2) 350713-001	Filler (2) 350466-001
Owner's Manual 350485-001	Owner's Manual 35048-001

WIRING

Driver, Low Freq. (1)
2256G
(339548-001X)
Cone Repl
C4R2256

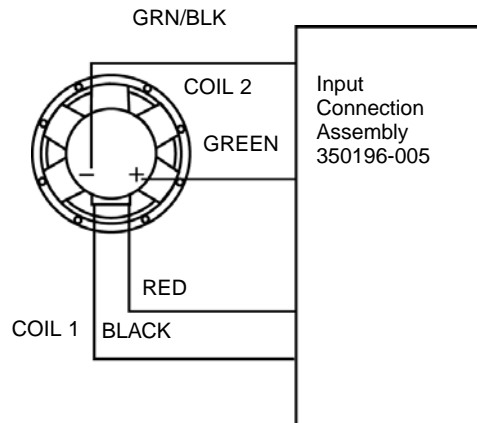

JBL VT4881

Schematic Diagrams

Connector Assembly
350991-001

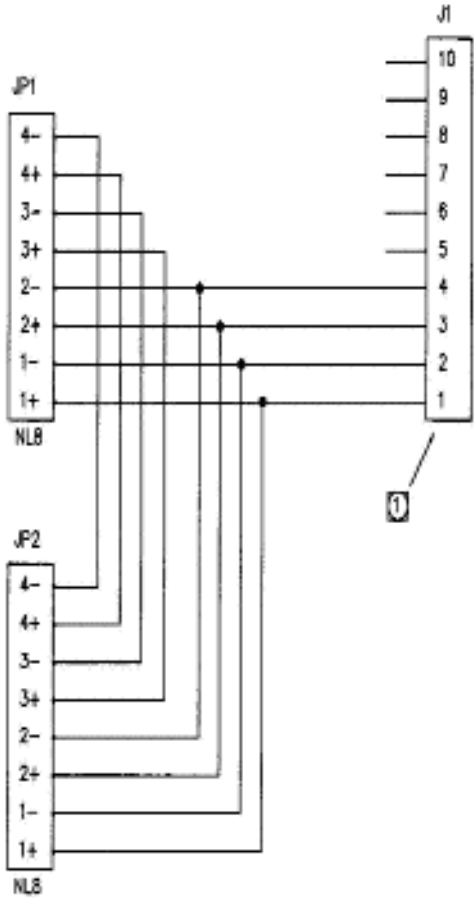

Wire Harness
350992-001

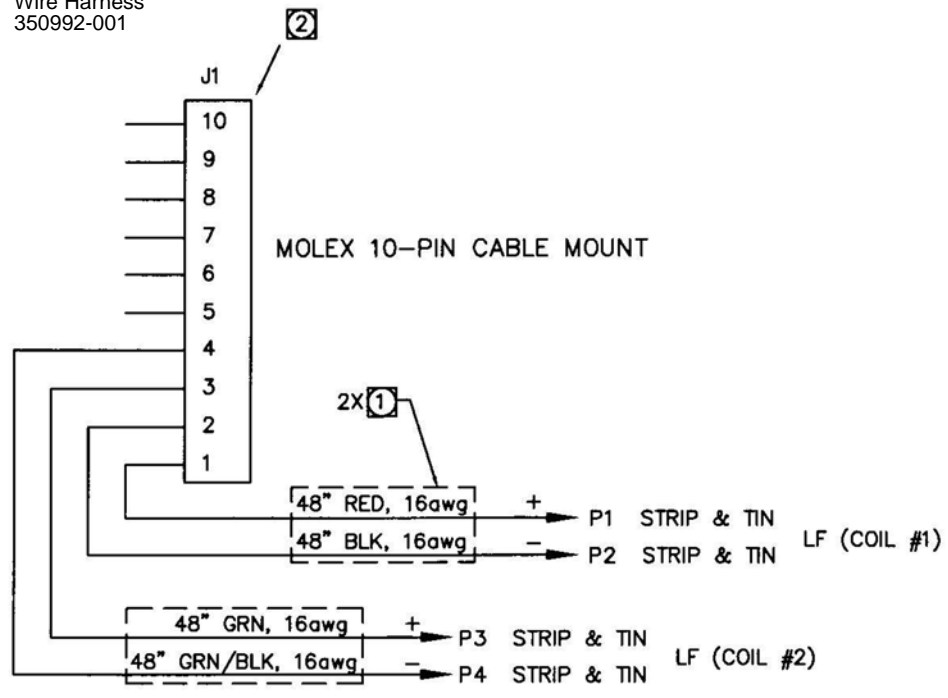

JBL VT4881

JBL VT4881

COMPONENT EXPLODED VIEW

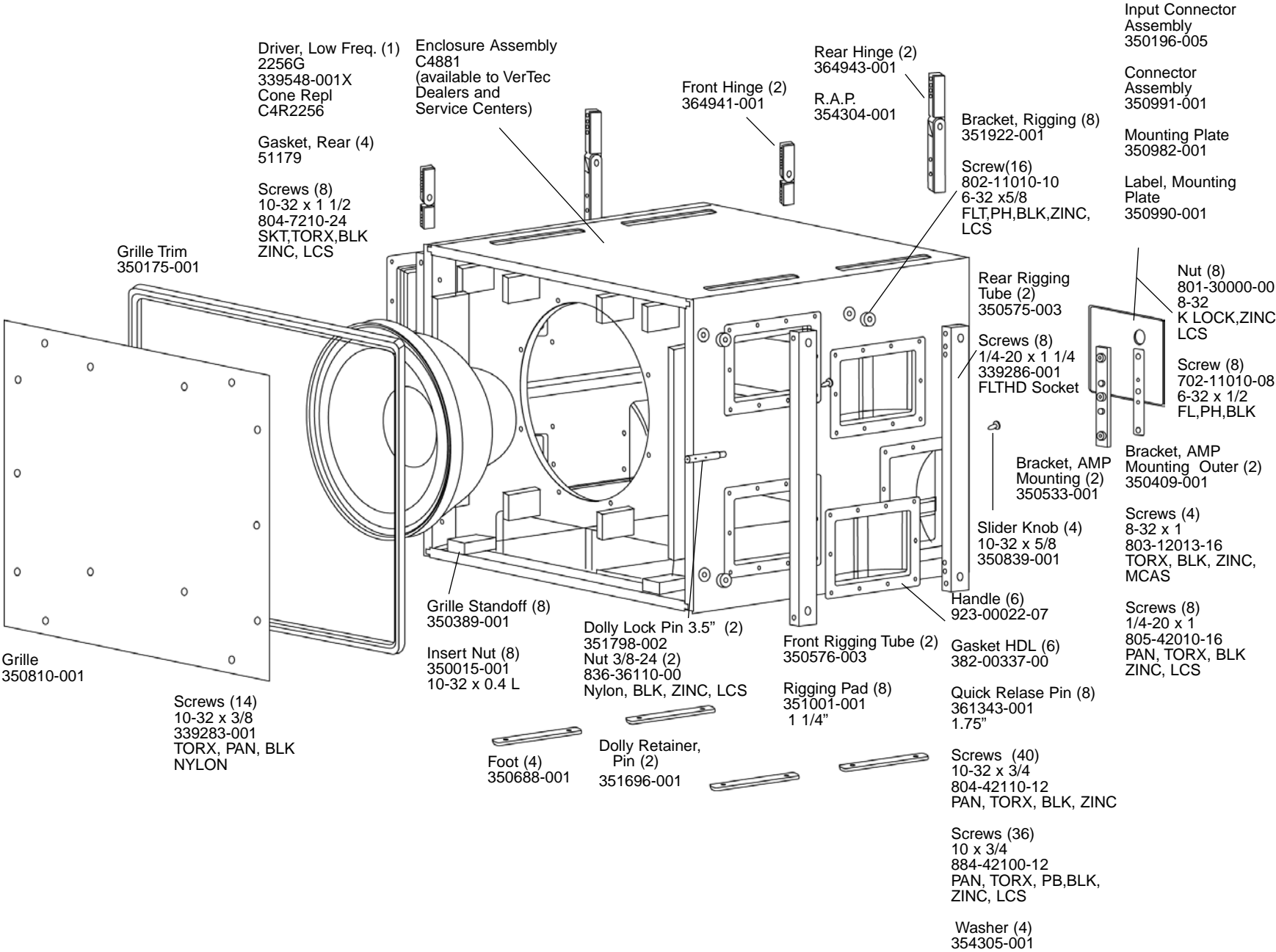

JBL VT4881-ACC

DOLLY ASSEMBLY 350434-002

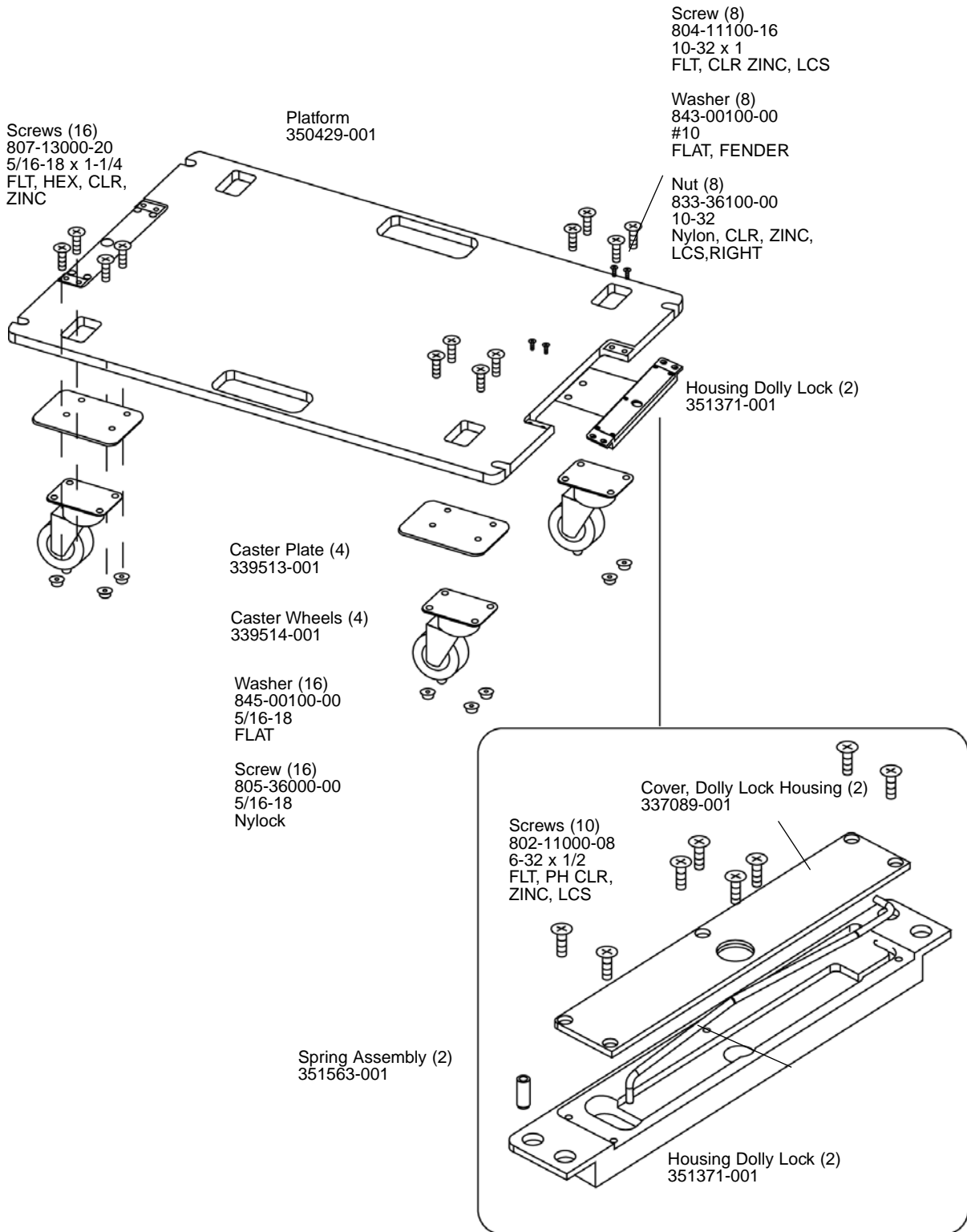

JBL VT4881-ACC

DOLLY ASSEMBLY 350434-003

Screw (16)
807-13000-20
5/16-18 x 1-1/4
FLT HEX, CLR,
ZINC,LC

Dolly Platform
351895-003
(w/c sink holes)

Screw (16)
807-13000-20
5/16-18 x 1-1/4
FLT HEX, CLR,
ZINC,LC

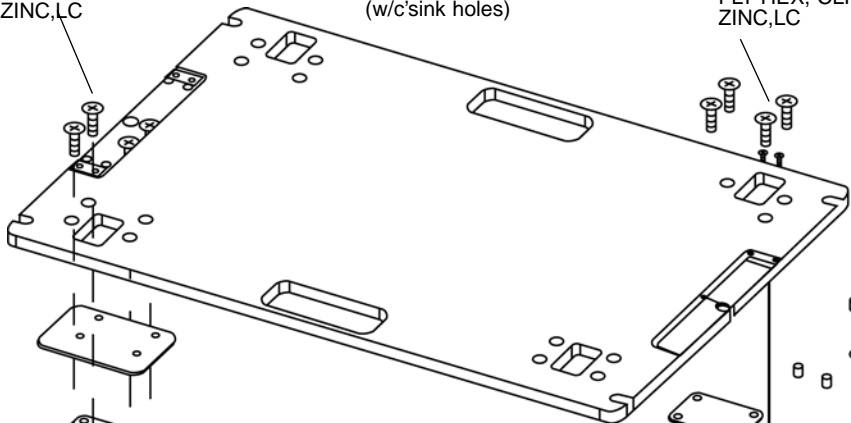

T-Nut (2)
21749
8-32 x 1/4
CP

Insert (10)
8161207-001
8-32 x 4MM
HXS,KNIFE32608C10ZC

Caster Plate (4)
339513-001

Caster Wheels (4)
339514-001

Nut (16)
352018-001
Nylock Special

Screw (12)
803-11000-08
8-32 x 1/2
FLT,PH,CLR,
ZINC,UNC

Cover,Dolly Housing (2)
351893-001

Spring Assembly (2)
351899-001

JBL VT4887-SF

ARRAY FRAME ASSEMBLY

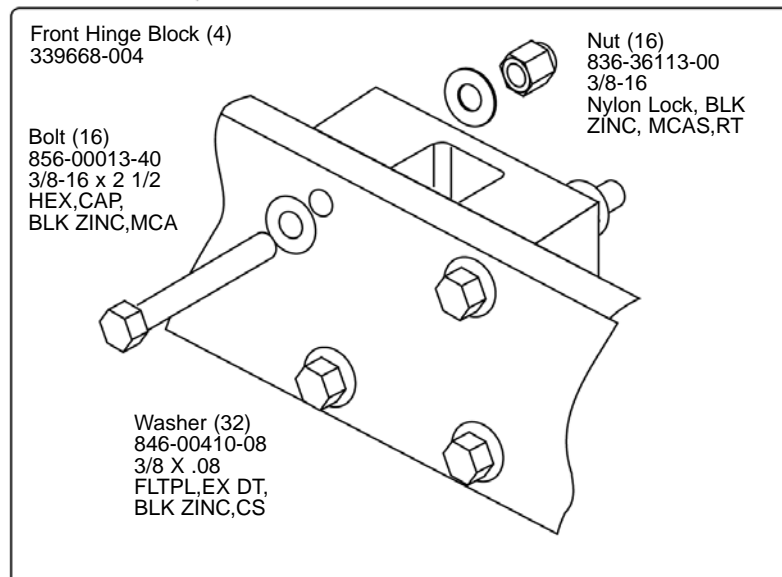
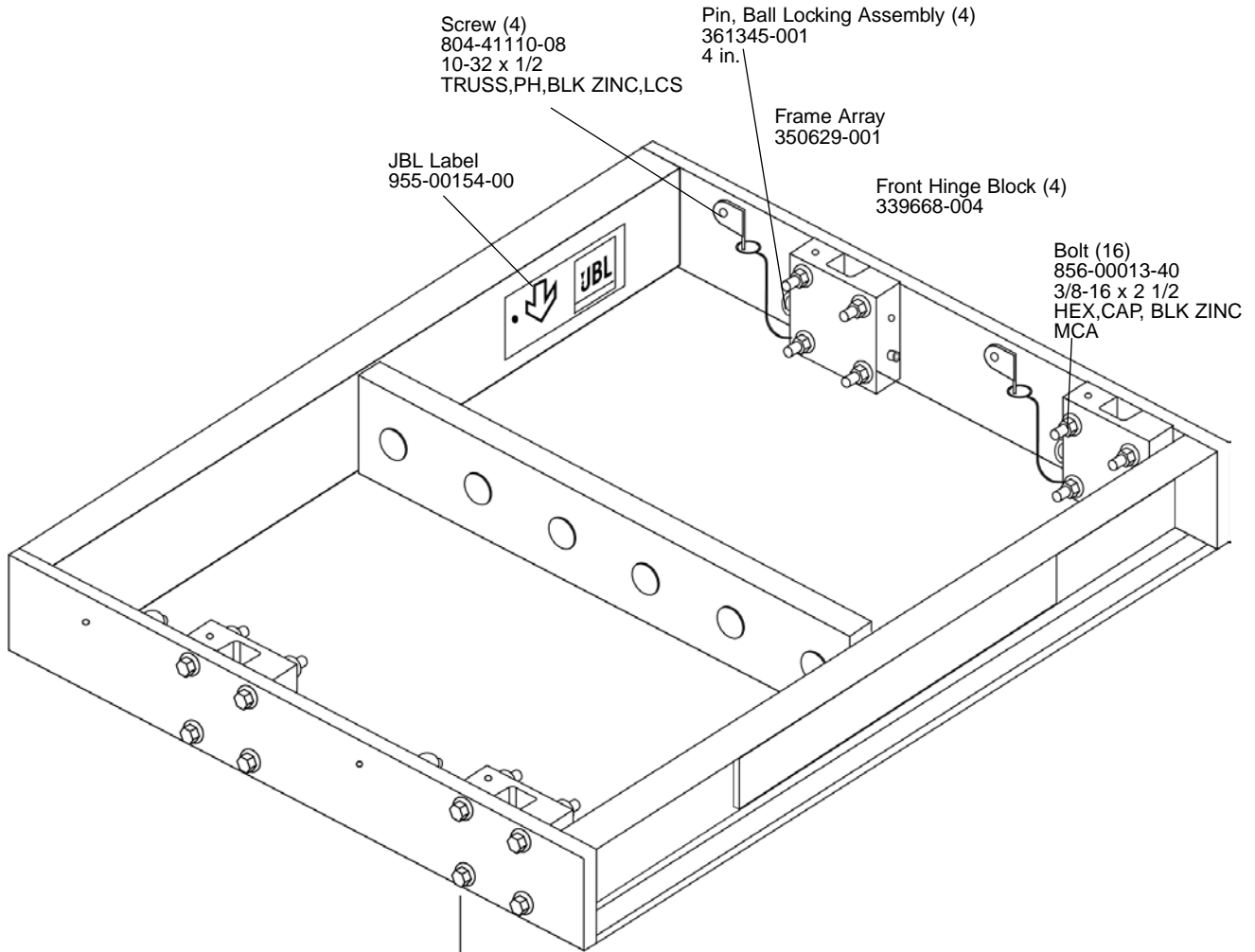

JBL VT4887-AF

ARRAY FRAME ASSEMBLY

