

Technical Manual

JBL VRX932LA



SPECIFICATIONS

ACOUSTIC & ELECTRICAL SPECIFICATIONS:

- Nominal Impedance: 8 ohms
- Power Capacity: Continuous / Program / Peak
Passive: 800W / 1600W / 3200W
Bi-amp LF: 800W / 1600W / 3200W
Bi-amp HF: 75W / 150W / 300W
- Crossover Freq: 1.2 kHz
- Frequency Range: 57 Hz – 20 kHz (–10 dB)
- Maximum SPL: 129 dB SPL peak (passive)
LF: 129 dB; HF: 139 dB
- System Sensitivity: 95 dB SPL (1 watt @ 1 meter) passive mode
LF: 95 dB; HF: 114 dB (1 watt @ 1 meter)

SYSTEM COMPONENTS:

- Cabinet: Enclosure (Not For Sale)
- Grille: 352282-001
- Low Frequency Transducer: 2262HPL, 305 mm (12 in) Differential Drive Woofer with Neodymium-magnet and Dual Voice Coils
- DC Resistance: 5.1 ohms ± 10%

SYSTEM COMPONENTS: (CONT'D)

- High Frequency Transducer: (3) 2407J 25.4 mm (1 in) Voice Coil, Neodymium Magnet Compression Driver
- DC Resistance: 8.7 ohms ± 5%
- Crossover Network: 353566-006

AURAL SWEEP TEST SPECIFICATIONS:

- A. System Aural Sweep Test: 10.0V Input, 20 Hz to 20 kHz
- B. L.F. Aural Sweep Test: 10.0V Input, 20 Hz to 1 kHz
- C. H.F. Aural Sweep Test: 2.83V Input, 1.6 kHz to 16 kHz

PHYSICAL SPECIFICATIONS:

- Enclosure Dimensions: 349 x 597 x 381 mm D (13.75 x 23.5 x 15.0 in. D)
- Net Weight: 48 lb (21.8 kg.)

WARRANTY INFORMATION:

- Refer to Warranty Statement packed with each product.

PACKAGE

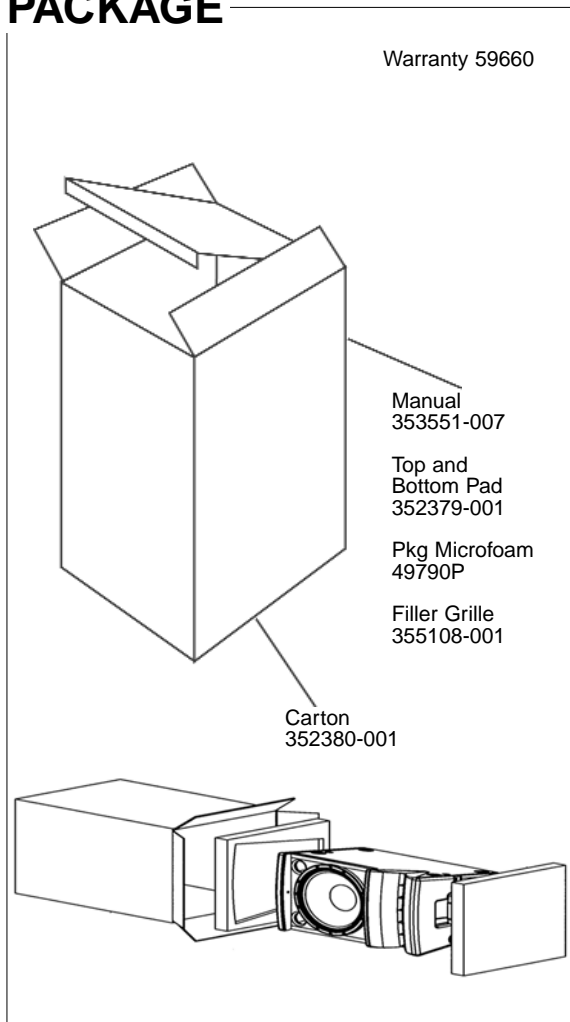

WIRING DIAGRAM

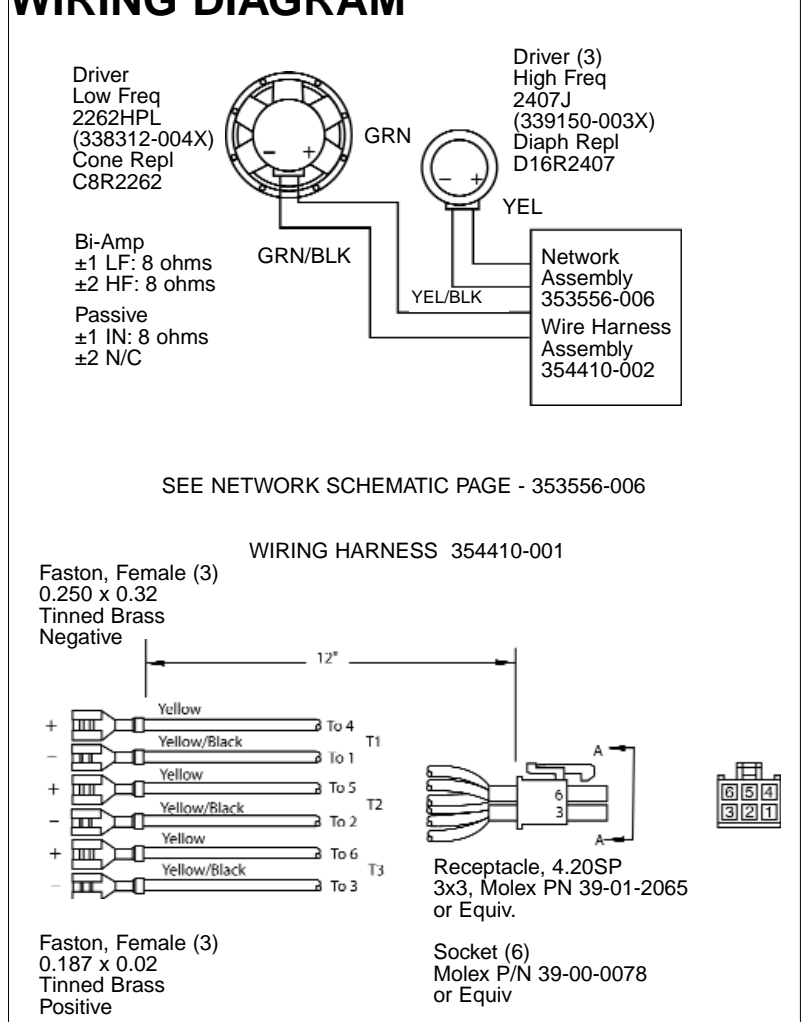

JBL VRX932LA

COMPONENT EXPLODED VIEW

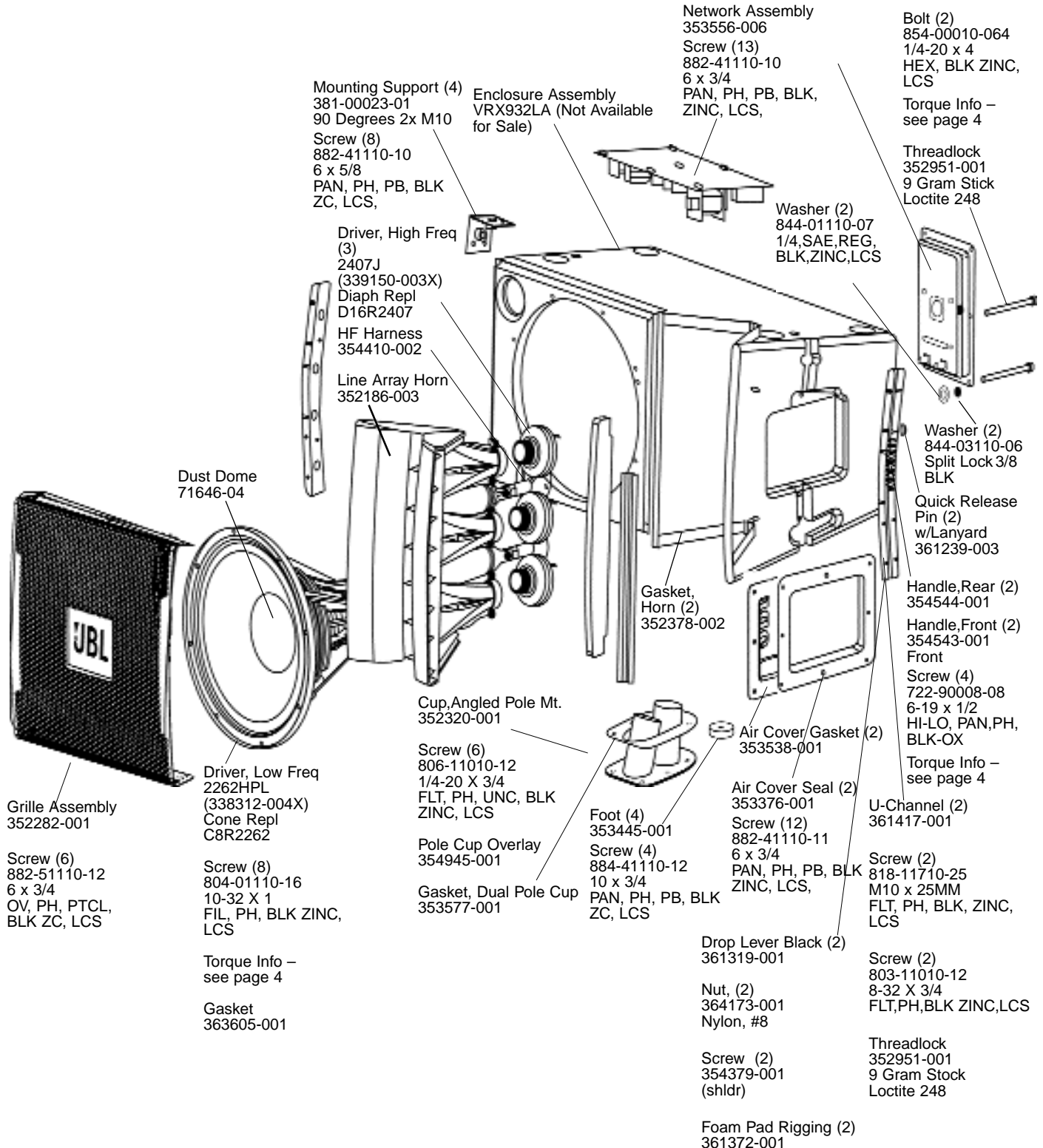

JBL VRX932LA

JBL VRX932LA

SCHEMATIC 353556-006

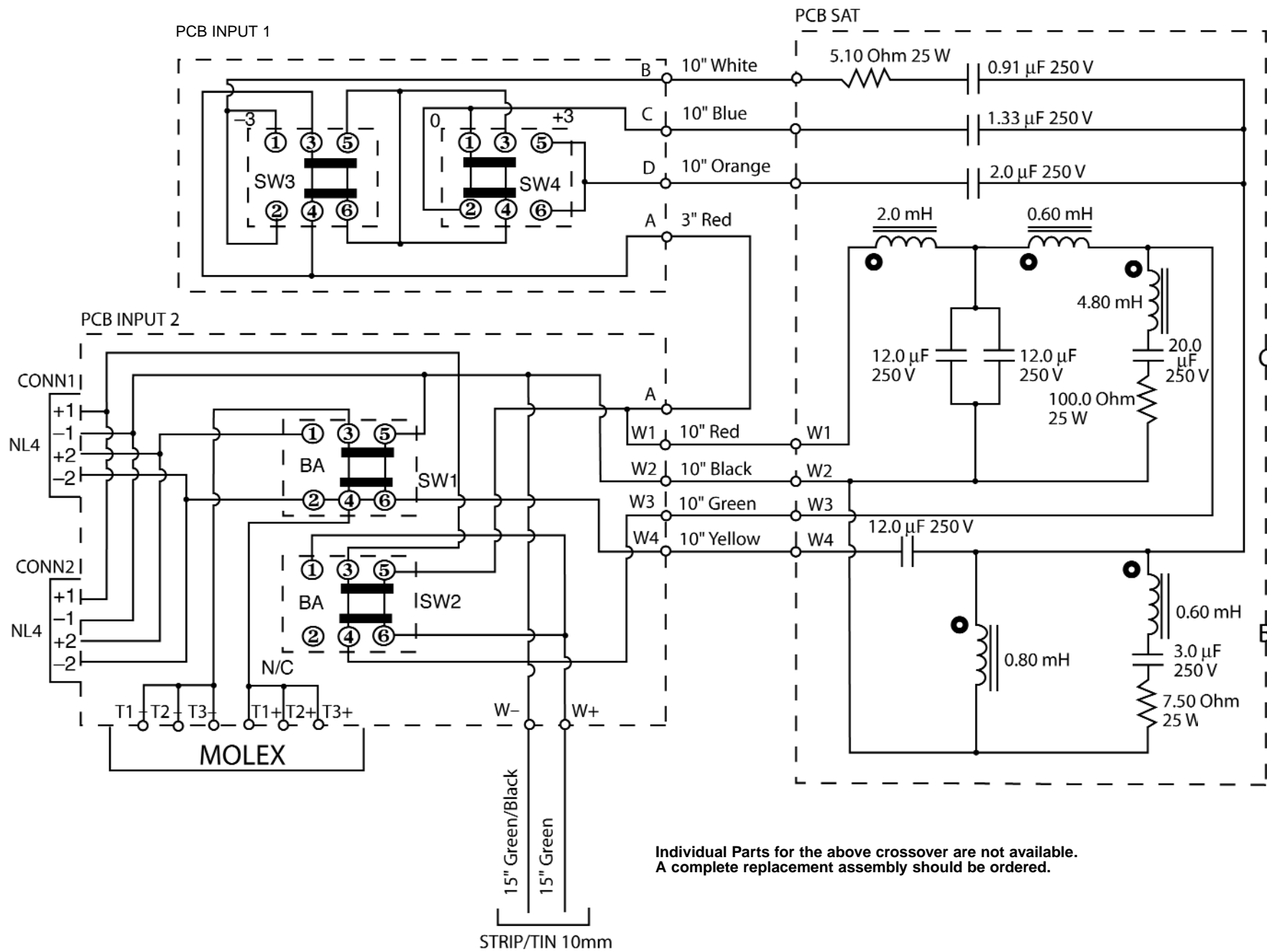

Individual Parts for the above crossover are not available.
A complete replacement assembly should be ordered.

JBL VRX-AF

ARRAY FRAME ASSEMBLY

Manual
353551-007

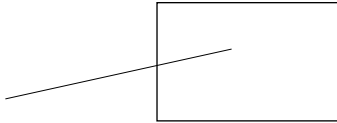

- 4" 1/4-20 bolts to horn — 5" — caution! You can break the horn at 60"/lbs, which is pretty easy with a ratchet (pull on the end of a 1' handle with 5 pounds). 35"/lbs = 2.9 ft/lbs.
- Screws to handle cup from outside of rigging frame — 16"/lbs. Current production is getting machine screw and keps nut on deviation (which could take much more torque), but when we switch to sheetmetal screw (which can be serviced without removing horn/grille), it will be sensitive (likely failure torque <30"/lbs)
- Woofer screws, typical 22"/lbs.
- M10 rigging screws — 40"/lbs minimum; don't forget the threadlock! Ditto the 1/4-20's on the pole mount (except no threadlock)

*VRX Service Kit (includes):

Drop Level Black VRX932LA
361319-001

Nut, Keps (2)
832-30010-00
Steel BLK ZINC
and EM LUBE

Screw (shldr) (2)
354379-001
3/16 DIA X 1 LG

