

Technical Manual

JBL VRX932LA-WH



SPECIFICATIONS

ACOUSTIC & ELECTRICAL SPECIFICATIONS:

- Nominal Impedance: 8 Ohms
- Power Capacity: Continuous / Program / Peak
Passive: 800W / 1600W / 3200W
Bi-amp LF: 800W / 1600W / 3200W
Bi-amp HF: 75W / 150W / 300W
- Crossover Freq: 1.2 kHz
- Frequency Range: 57 Hz – 20 kHz (-10 dB)
- Maximum SPL: 129 dB SPL peak (passive)
LF: 129 dB; HF: 139 dB
- System Sensitivity: 95 dB SPL (1 watt @ 1 meter) passive mode
LF: 95 dB; HF: 114 dB (1 watt @ 1 meter)

SYSTEM COMPONENTS:

- Cabinet: Enclosure (Not For Sale)
- Grille: 352282-002
- Low Frequency Transducer: 2262HPL, 305 mm (12 in) Differential Drive Woofer with Neodymium-magnet and Dual Voice Coils
- DC Resistance: 5.1 ohms ± 10%

SYSTEM COMPONENTS: (CONT'D)

- High Frequency Transduce: (3) 2407J, 25.4 mm (1 in) Voice Coil, Neodymium Magnet Compression Driver
- DC Resistance: 4.25 ohms ± 0.15%

AURAL SWEEP TEST SPECIFICATIONS:

- A. System Aural Sweep Test: 10.0V Input, 20 Hz to 20 kHz
- B. L.F. Aural Sweep Test: 10.0V Input, 20 Hz to 1 kHz
- C. H.F. Aural Sweep Test: 2.83V Input, 1.6 kHz to 16 kHz

PHYSICAL SPECIFICATIONS:

- Enclosure Dimensions: 349 mm x 597 mm x 381 mm D (13.75 in. x 23.5 in. x 15.0 in. D)
- Net Weight: 48 lbs. (21.8 kg.)

WARRANTY INFORMATION:

- Refer to Warranty Statement packed with each product.

PACKAGE

Warranty 59660

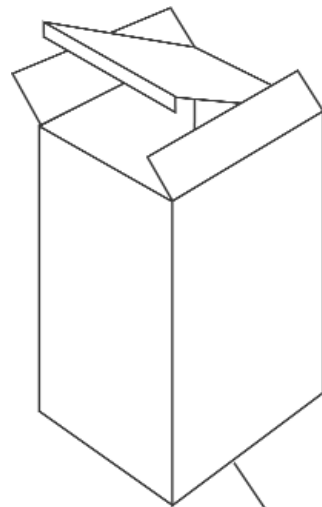

Manual
353551-007

Pad (2)
352379-001

Pkg. Microfoam (8)
49790P

Filler Grille
355108-001

Carton
352380-001

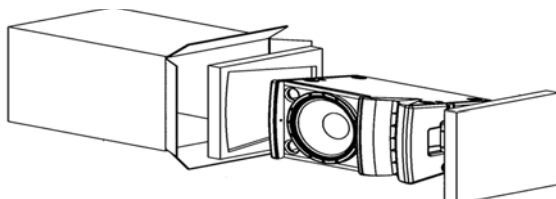

WIRING DIAGRAM

Driver
Low Freq
2262HPL
(338312-004X)
Cone Repl
C8R2262

Bi-Amp
±1 LF: 8 ohms
±2 HF: 8 ohms
Passive
±1 IN: 8 ohms
±2 N/C

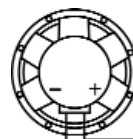

Driver (3)
High Freq
2407J
(339150-003X)
Diaph Repl
D16R2407



Network
Assembly
353556-006
H/F Wire
Harness
Assembly
354410-002

SEE NETWORK SCHEMATIC PAGE - 353556-006

WIRE HARNESS 354410-002

Faston, Female (3)
0.250 x 0.32
Tinned Brass
Negative

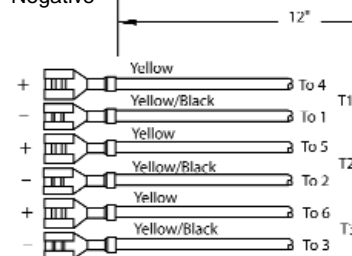

Faston, Female (3)
0.187 x 0.02
Tinned Brass
Positive

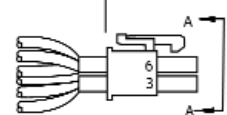

Receptacle, 4.20SP
3x3, Molex PN 39-01-2065
or Equiv.

Socket (6)
Molex P/N 39-00-0078
or Equiv



JBL VRX932LA-WH REV J

JBL VRX932LA-WH

COMPONENT EXPLODED VIEW

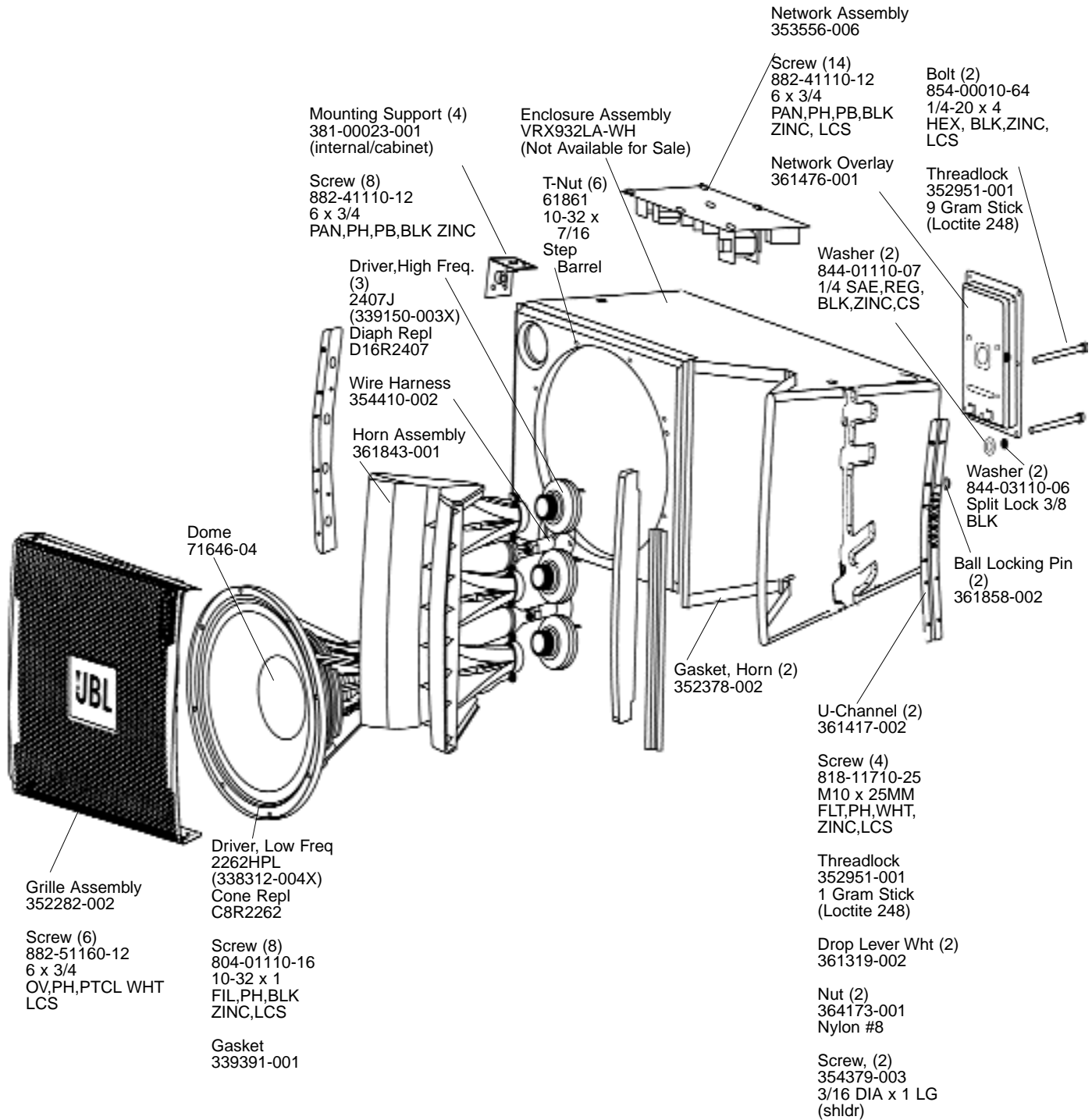

JBL VRX932LA-WH

JBL VRX932LA-WH

SCHEMATIC 353556-006

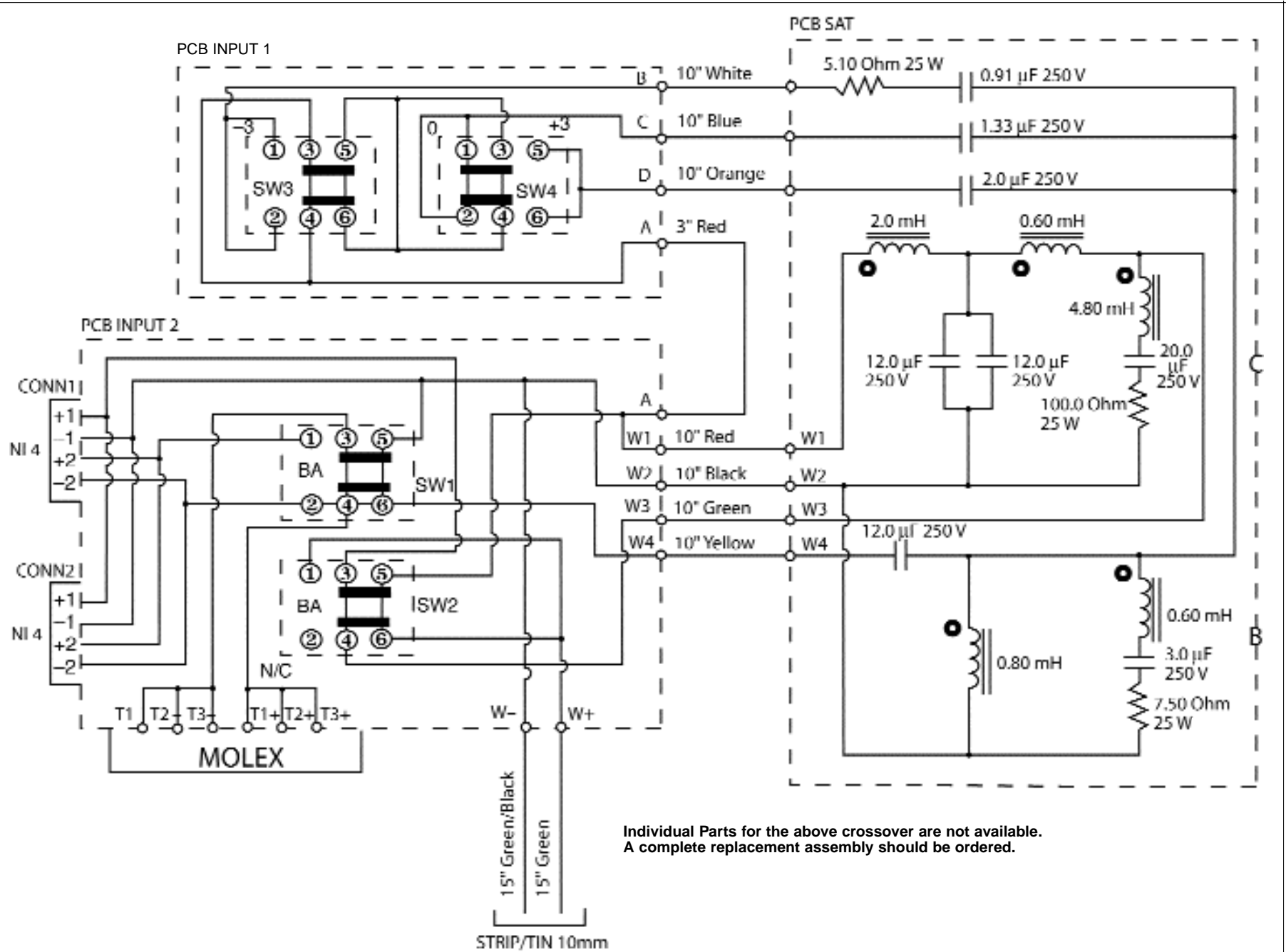

Individual Parts for the above crossover are not available.
A complete replacement assembly should be ordered.

JBL VRX-AF

ARRAY FRAME ASSEMBLY

Manual
353551-007

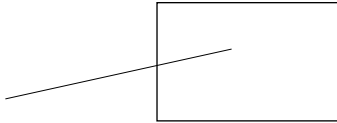

- 4" 1/4-20 bolts to horn — 5" — caution! You can break the horn at 60"/lbs, which is pretty easy with a ratchet (pull on the end of a 1' handle with 5 pounds). 35"/lbs = 2.9 ft/lbs.
- Screws to handle cup from outside of rigging frame — 16"/lbs. Current production is getting machine screw and keps nut on deviation (which could take much more torque), but when we switch to sheetmetal screw (which can be serviced without removing horn/grille), it will be sensitive (likely failure torque <30"/lbs)
- Woofer screws, typical 22"/lbs.
- M10 rigging screws — 40"/lbs minimum; don't forget the threadlock! Ditto the 1/4-20's on the pole mount (except no threadlock)

*VRX Service Kit:
Drop Level White VRX932LA
361319-002

Nut, Keps (2)
832-30010-00
Steel BLACK ZINC and EM LUBE

