

# Technical Manual



# JBL VRX932LA-1WH

## SPECIFICATIONS

### ACOUSTIC & ELECTRICAL SPECIFICATIONS:

- Nominal Impedance: 8 Ohms
- Power Capacity: Continuous / Program / Peak  
Passive: 800W / 1600W / 3200W  
Bi-amp LF: 800W / 1600W / 3200W  
Bi-amp HF: 75W / 150W / 300W
- Crossover Freq: 1.2 kHz
- Frequency Range: 57 Hz – 20 kHz (-10 dB)
- Maximum SPL: 129 dB SPL peak (passive)  
LF: 129 dB; HF: 139 dB
- System Sensitivity: 95 dB SPL (1 watt @ 1 meter) passive mode  
LF: 95 dB; HF: 114 dB (1w @ 1m)

### SYSTEM COMPONENTS:

- Cabinet: Enclosure (Not For Sale)
- Grille: 352282-002
- Low Frequency Transducer: 2262HPL, 305 mm (12 in) Differential Drive Woofer with Neodymium-magnet and Dual Voice Coils
- DC Resistance: 5.1 ohms ± 10%

### SYSTEM COMPONENTS: (CONT'D)

- High Frequency Transducer: (3) 2408J, 38 mm (1.5) Voice Coil, Neodymium Compression Driver
- DC Resistance: 8.9 ohms ± 0.2%

### AURAL SWEEP TEST SPECIFICATIONS:

- A. System Aural Sweep Test: 10.0V Input, 20 Hz to 20 kHz
- B. L.F. Aural Sweep Test: 10.0V Input, 20 Hz to 1 kHz
- C. H.F. Aural Sweep Test: 1.0V 200 Hz to 1.5 kHz

### PHYSICAL SPECIFICATIONS:

- Enclosure Dimensions: 349 x 597 x 381 mm D (13.75 in. x 23.5 in. x 15.0 in. D)
- Net Weight: 48 lb (21.8 kg.)

### WARRANTY INFORMATION:

- Refer to Warranty Statement packed with each product.

## PACKAGE

Warranty 59660

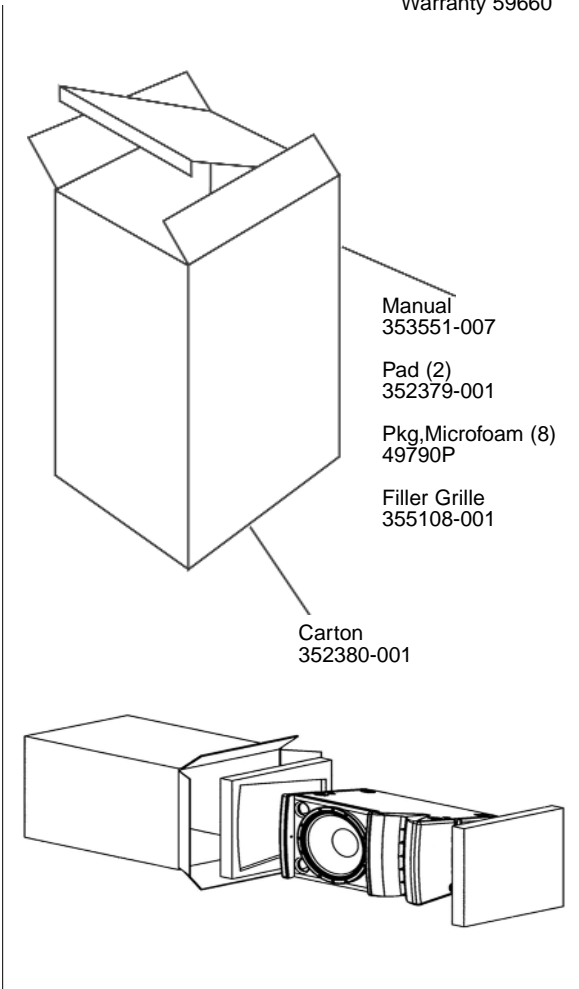

## WIRING DIAGRAM

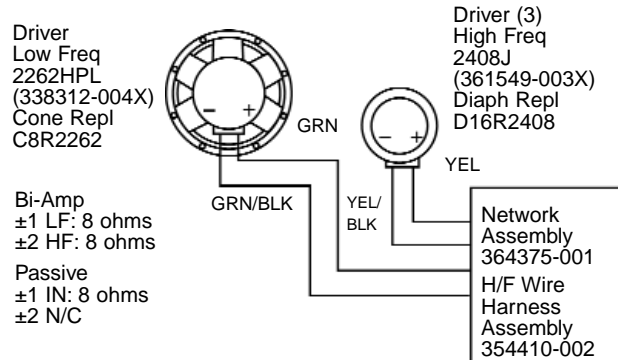

SCHEMATIC 364375-001  
(Please see page 3)

WIRE HARNNESS 354410-002

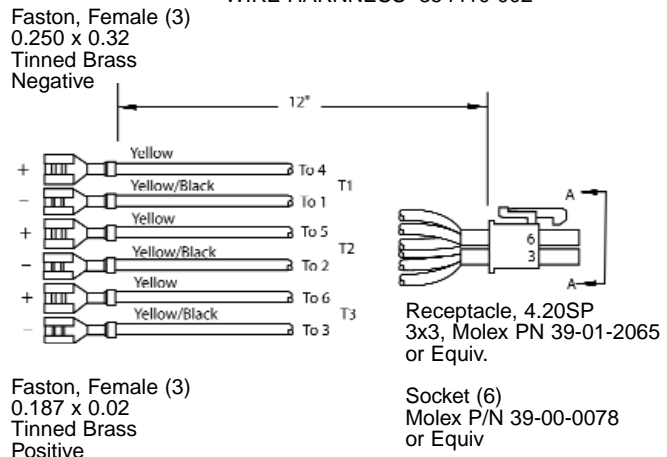

JBL VRX932LA-1WH REV B

# JBL VRX932LA-1WH

## COMPONENT EXPLODED VIEW

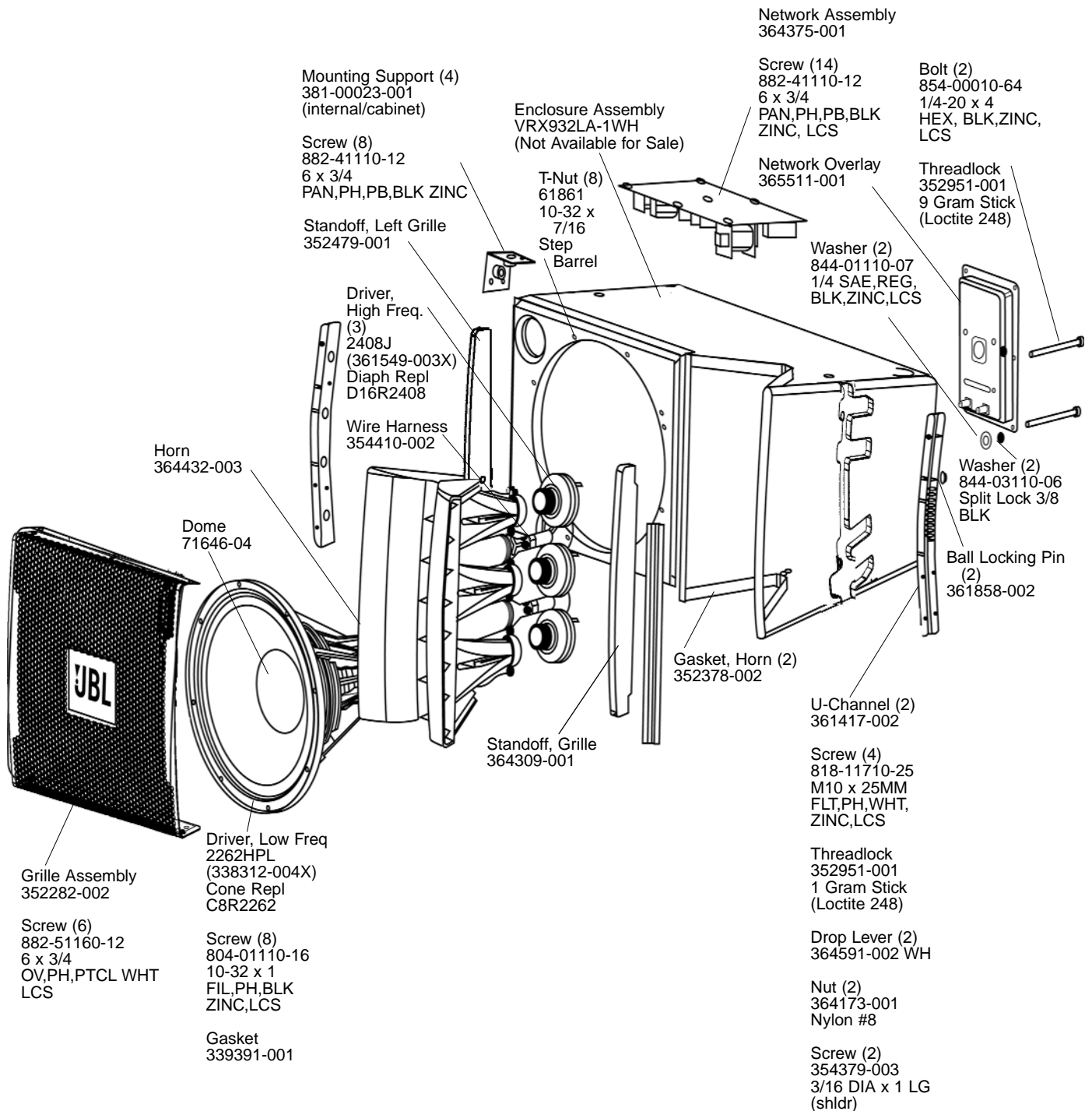

# JBL VRX932LA-1WH

SCHEMATIC 364375-001

## SCHEMATIC

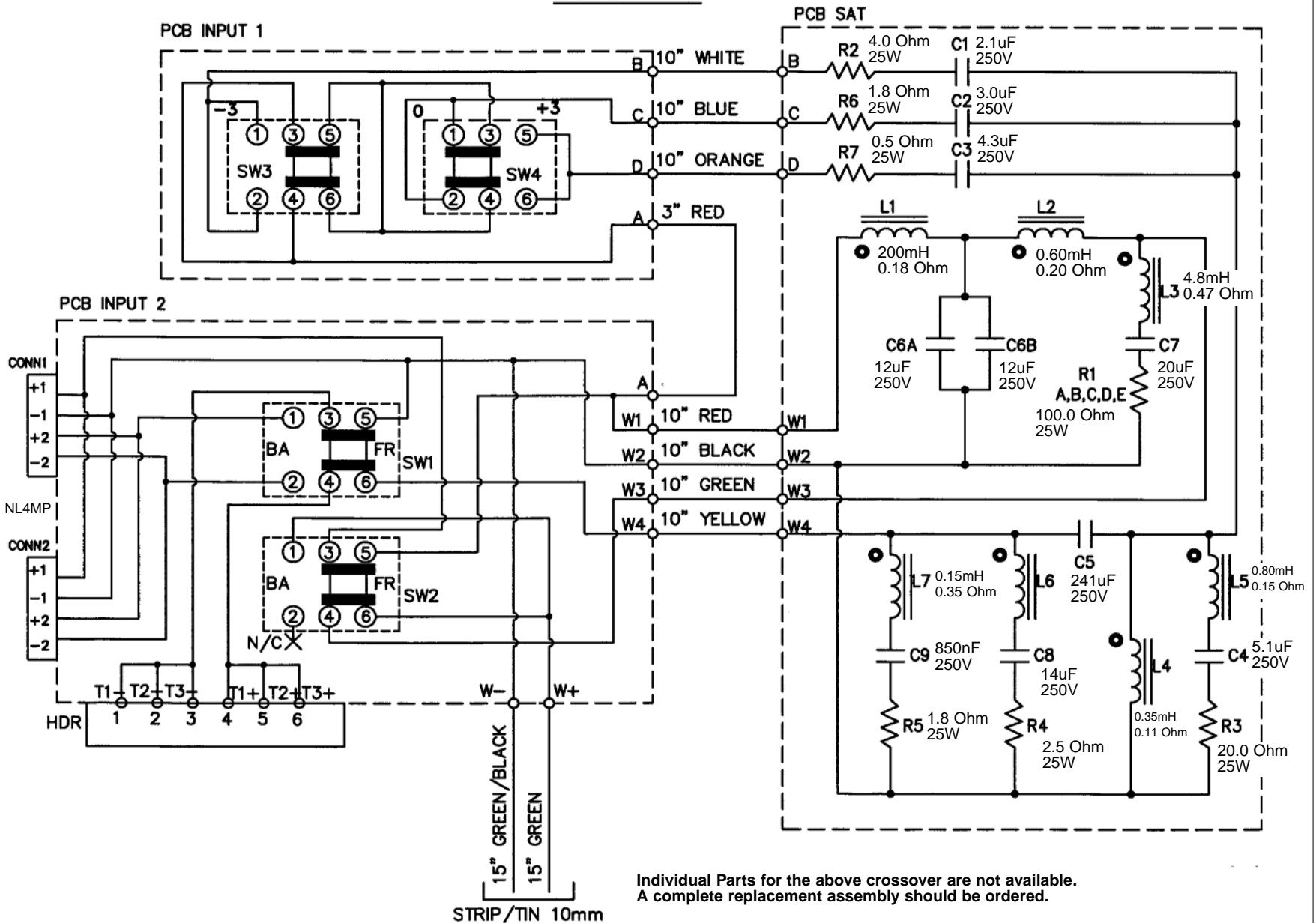

Individual Parts for the above crossover are not available.  
A complete replacement assembly should be ordered.

JBL VRX932LA-1WH

# JBL VRX-AF

## ARRAY FRAME ASSEMBLY

Manual  
353551-007

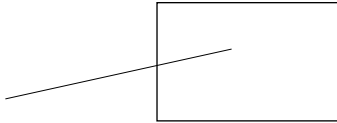

- 4" 1/4-20 bolts to horn — 5" — caution! You can break the horn at 60"/lbs, which is pretty easy with a ratchet (pull on the end of a 1' handle with 5 pounds). 35"/lbs = 2.9 ft/lbs.
- Screws to handle cup from outside of rigging frame — 16"/lbs. Current production is getting machine screw and keps nut on deviation (which could take much more torque), but when we switch to sheetmetal screw (which can be serviced without removing horn/grille), it will be sensitive (likely failure torque <30"/lbs)
- Woofer screws, typical 22"/lbs.
- M10 rigging screws — 40"/lbs minimum; don't forget the threadlock! Ditto the 1/4-20's on the pole mount (except no threadlock)

\*VRX Service Kit:  
Drop Level White VRX932LA  
361319-002

Nut, Keps (2)  
832-30010-00  
Steel BLACK ZINC and EM LUBE

Screw (shldr) (2)  
354379-001  
3/16 DIA x 1 LG

