

Technical Manual

JBL VRX932LA-1



SPECIFICATIONS

ACOUSTIC & ELECTRICAL SPECIFICATIONS:

- Nominal Impedance: Passive: 8 Ohm
Bi-amp LF: 8 ohms
Bi-amp HF: 8 ohms
- Power Rating: Continuous / Program / Peak
Passive: 800 W / 1600 W / 3200 W
Bi-amp LF: 800 W / 1600 W / 3200 W
Bi-amp HF: 75 W / 150 W / 300 W
- Freq. Response: 75 Hz - 20 kHz (± 3 dB)
- Frequency Range: 57 Hz - 20 kHz (-10 dB)
- System Max. SPL: 130 dB SPL peak (passive mode)
LF: 130 dB; HF: 139 dB
- System Sensitivity: 95 dB SPL (passive mode)
LF: 95 dB (Bi-amp mode)
HF: 114 dB (Bi-amp mode)
(1w @ 1m)
- Input Connectors: Neutrik Speakon NL-4 (x2)
- Crossover Freq: 1.2 kHz

SYSTEM COMPONENTS: (Cont'd)

- Low Frequency Transducers: (1) 2262HPL, 305 mm (12 in) Differential Drive woofer with Neodymium magnet and dual voice coils, and dual magnetic gaps.
- DC Resistance: 5.1 ohms \pm 10%
- High Frequency Transducer: (3) 2408J, 38 mm (1.5 in) voice coil, Neodymium Compression Driver
- DC Resistance: 8.9 ohms \pm 0.2%
- Crossover Network: 364375-001

AURAL SWEEP TEST SPECIFICATIONS:

- A. System Aural Sweep Test: 10.0V Input, 20 Hz to 20 kHz
- B. L.F. Aural Sweep Test: 10.0V Input, 20 Hz to 1 kHz
- C. H.F. Aural Sweep Test: 1.0V Input, 200 Hz to 1.5 kHz

PHYSICAL SPECIFICATIONS:

- Enclosure Dimensions: 349 mm x 597 mm x 381 mm D (13.75 in. x 23.5 in. x 15.0 in. D)
- Net Weight: 46 lbs. (21 kg.)

SYSTEM COMPONENTS:

- Cabinet: (Not For Sale)
- Grille: 352282-001

WARRANTY INFORMATION:

- Refer to Warranty Statement packed with each product.

PACKAGE

Warranty 59660

Carton 352380-001

Pad (2) 352379-001

Filler (1) 355108-001

Pkg, Microfoam (8) 49790P Sheets

Manual 353551-007

Filler 361091-001

Carton 361094-001

Pad 361257-001

VRX-AF
Array Frame Accessory

WIRING DIAGRAM

Driver
Low Freq
2262HPL
(338312-004X)
Cone Repl
C8R2262

Bi-Amp
 ± 1 LF: 8 ohms
 ± 2 HF: 8 ohms

Passive
 ± 1 IN: 8 ohms
 ± 2 N/C

Driver (3)
High Freq
2408J
(361549-003X)
Diaph Repl
D16R2408

Network
364375-001

Wiring
Harness
354410-002

SCHEMATIC 364375-001
(Please see page 3)

WIRING HARNESS 354410-002

Faston, Female (3)
0.250 x 0.032
Tinned Brass
Negative

Faston, Female (3)
0.187 x 0.020
Tinned Brass
Positive

Receptacle, 4.20SP
3x3, Molex PN 39-01-2065
or Equiv.

Socket (6)
Molex P/N 39-00-0078
or Equiv

JBL VRX932LA-1 REV C

JBL VRX932LA-1

JBL VRX932LA-1

SCHEMATIC

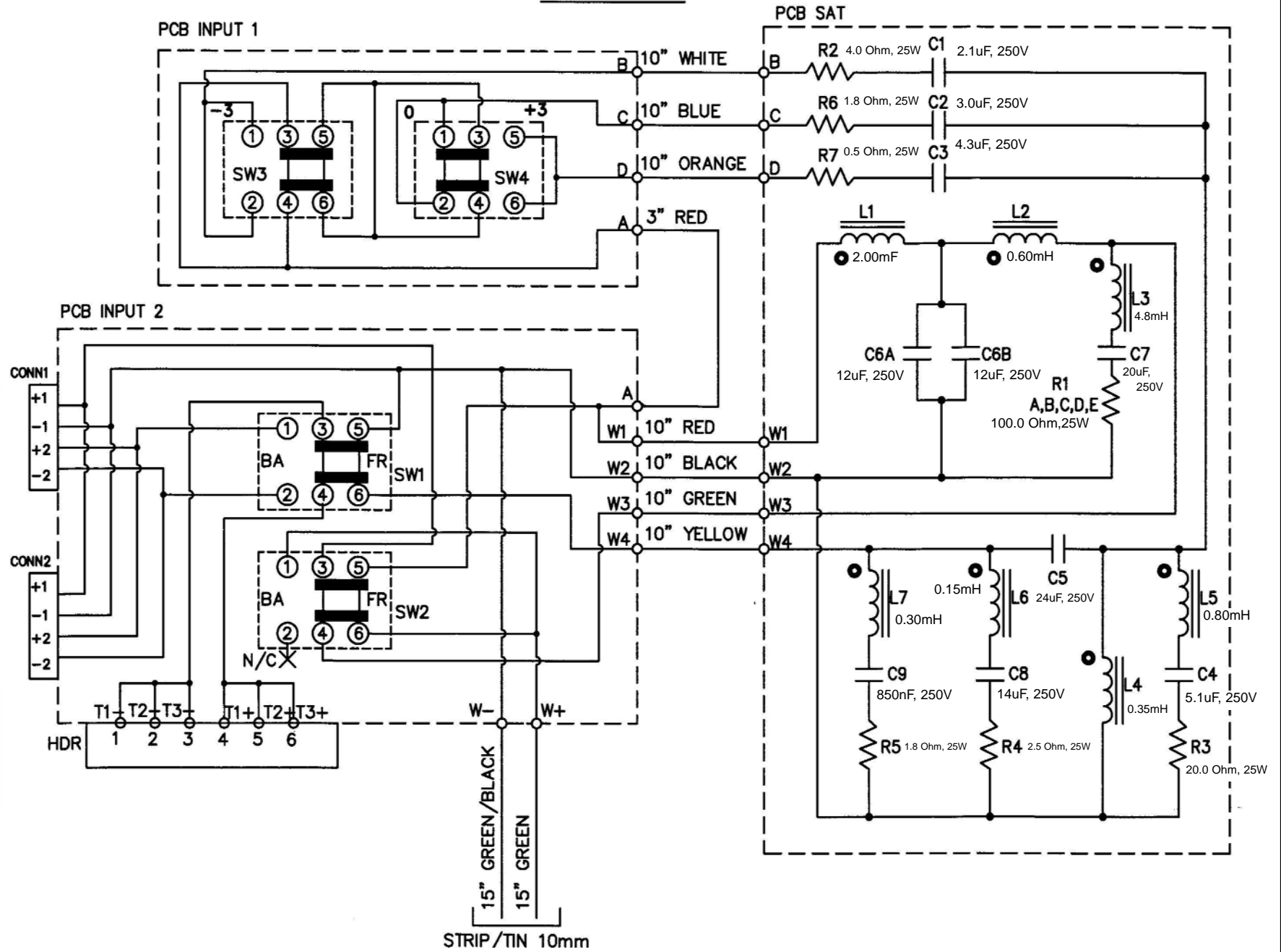

SCHEMATIC 364375-001

JBL VRX932LA-1

COMPONENT EXPLODED VIEW

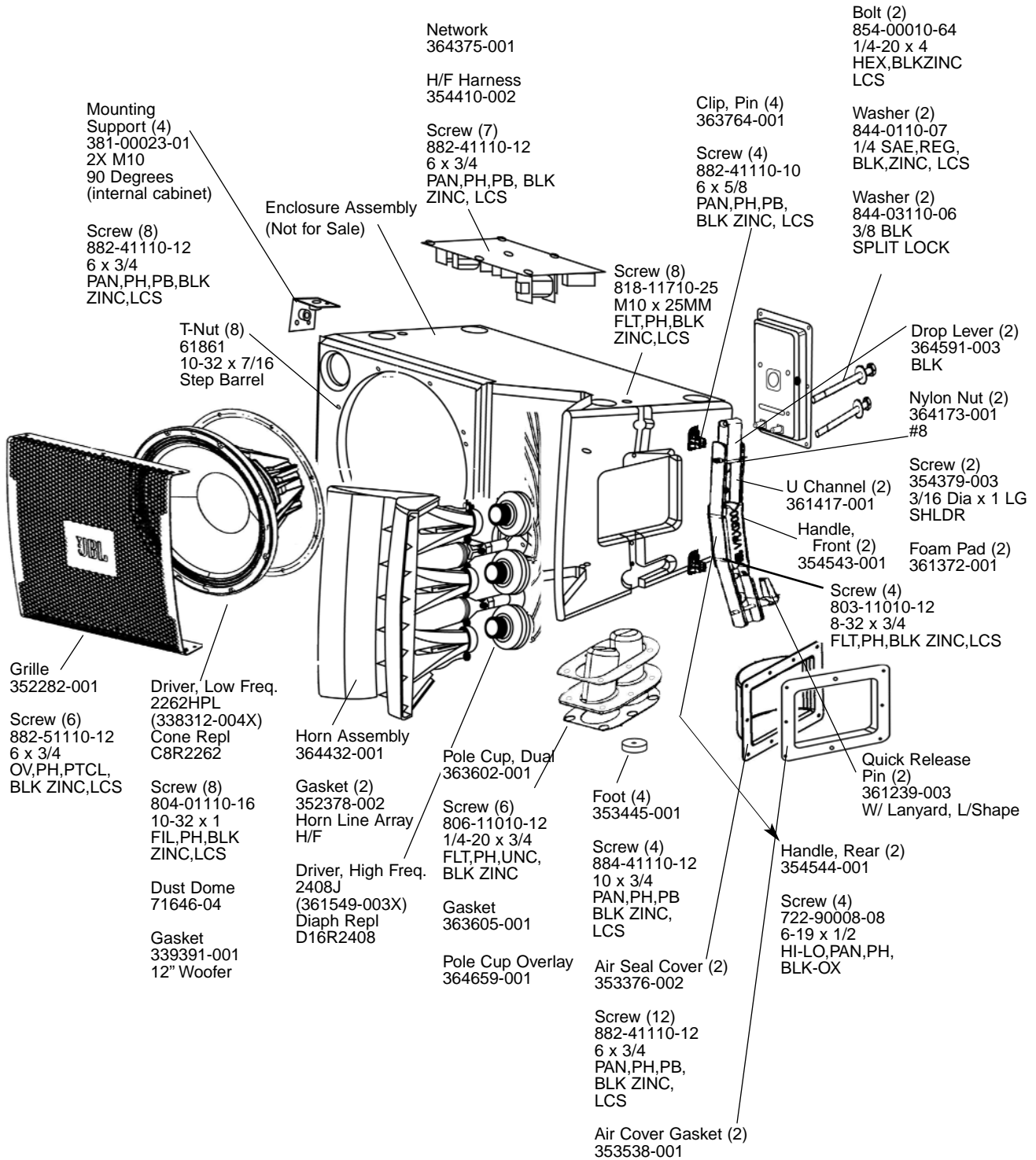

JBL VRX-AF

ARRAY FRAME ASSEMBLY

Manual
353551-007

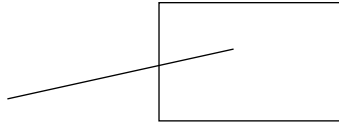

- 4" 1/4-20 bolts to horn — 5" — caution! You can break the horn at 60"/lbs, which is pretty easy with a ratchet (pull on the end of a 1' handle with 5 pounds). 35"/lbs = 2.9 ft/lbs.
- Screws to handle cup from outside of rigging frame — 16"/lbs. Current production is getting machine screw and keps nut on deviation (which could take much more torque), but when we switch to sheetmetal screw (which can be serviced without removing horn/grille), it will be sensitive (likely failure torque <30"/lbs)
- Woofer screws, typical 22"/lbs.
- M10 rigging screws — 40"/lbs minimum; don't forget the threadlock! Ditto the 1/4-20's on the pole mount (except no threadlock)

*VRX Service Kit:
Drop Level Black VRX932LA
361319-001

Nut, Keps (2)
832-30010-00
Steel BLK ZINC
and EM LUBE

Screw (Shldr) (2)
354379-002
3/16 DIA X 1 LG

