

Technical Manual



JBL VP7315/64DPAN/CN/DA

SPECIFICATIONS

ACOUSTIC & ELECTRICAL SPECIFICATIONS:

- Frequency Response: 43 Hz – 18 kHz (± 3 dB)
- Frequency Range: 34 Hz – 20 kHz (-10 dB)
- Coverage Pattern: 60° x 40° rotatable waveguide
- Max. Peak Output: 138 dB SPL 1m

TRANSDUCER SECTION:

- Cabinet: Enclosure (Not For Sale)
- Grille: 361931-001
- Low Frequency: 2265G, 381 mm (15 in) dia., 76 mm (3 in) Dual Coil neodymium Differential Drive, Direct Cooled,
- DC Resistance: 2.5 ohms $\pm 10\%$
- Mid Frequency: 2169H, 200 mm (8 in) Dual Coil neodymium Differential Drive Transducer,
- DC Resistance: 5.1 ohms $\pm 10\%$
- High Frequency: 2452H-SL, 100 mm (4 in) titanium damped diaphragm, 1.5 in. exit,
- DC Resistance: 4.1 ohms $\pm 10\%$
- Crossover Network: 362599-001

SYSTEM:

- DP2 Internal Amp Output: 2200W Peak, 1100W Continuous (at nominal load)
- DP2 Output: 750LF / 350HF Watts (Continuous IEC shaped pink noise into rated load impedance)
- DP2 Output Section: 2-Channel, Class I

SYSTEM CONT'D:

- Audio Input Connector: XLR with loop-through
- Network Control Connector: Ethernet, RJ45
- Signal Processing: DSP based, resident in Input Module
- System Management: DSP based limiters for mechanical and thermal protection
- AC Power Oper. Range: Auto Select 90-132VAC/216-264VAC, 50/60 Hz
- AC Line Voltage: 50/60 Hz, Auto-Detect; 120V/240V (-15%, +10%)
- AC Input Connector: Neutrik PowerCon
- AC Loop-thru: Neutrik PowerCon
- AC Current Requirement: 6A per system at 120V, 3A per system at 240V

AURAL SWEEP TEST SPECIFICATIONS:

- A. System Aural Sweep Test: 140mV Input, 20 Hz to 20 kHz
- B. L.F. Aural Sweep Test: 10.0V Input, 10 Hz to 300 Hz
- C. M.F. Aural Sweep Test: 7V Input, 20 Hz to 1 kHz
- D. H.F. Aural Sweep Test: 3.5V Input, 300 Hz to 20 kHz

PHYSICAL SPECIFICATIONS:

- Enclosure Dimensions: 914.4 mm x 528.3 mm x 624.8 mm D (36 in. x 20.8 in. x 24.6 in. D)
- Net Weight: 97 lbs. (44 kg.)

WARRANTY INFORMATION:

- Refer to Warranty Statement packed with each product.

PACKAGE

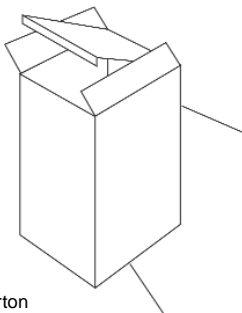

Carton
362257-001
Power Cord Assembly Pack
355040-002

Warranty 59660
Spec Sheet 361996-011

Top and Bottom Filler
362258-001

Manual
361997-001

CD Networked Drive Pack
361908-004

Protective Jacket
360849-001

VP Product Guide
361997-001

WIRING DIAGRAM

Driver, Mid Freq
2169H
(339111-001X)
C8R2169

Driver, Low Freq
2265G
(338343-005X)
Cone Repl
C4R2265

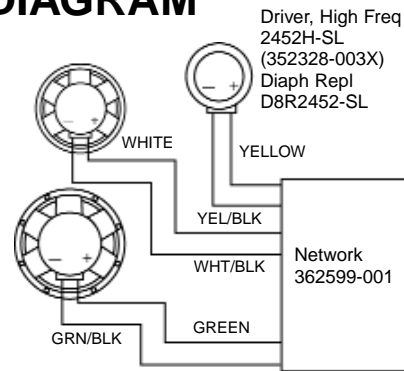

SCHEMATIC (362599-001)

CUP ASSEMBLY SCHEMATIC (352817-001)

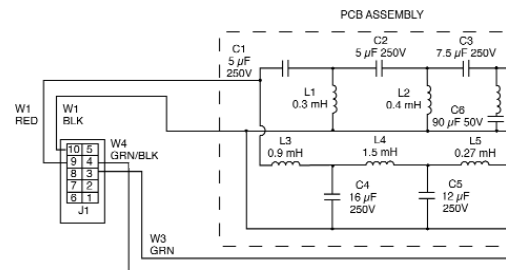
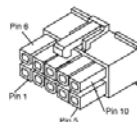
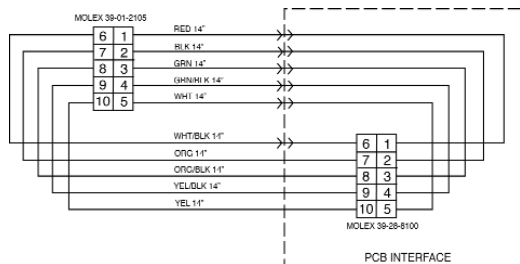

JBL VP7315/64DPAN/CN/DA REV M

JBL VP7315/64DPAN/CN/DA

COMPONENT EXPLODED VIEW

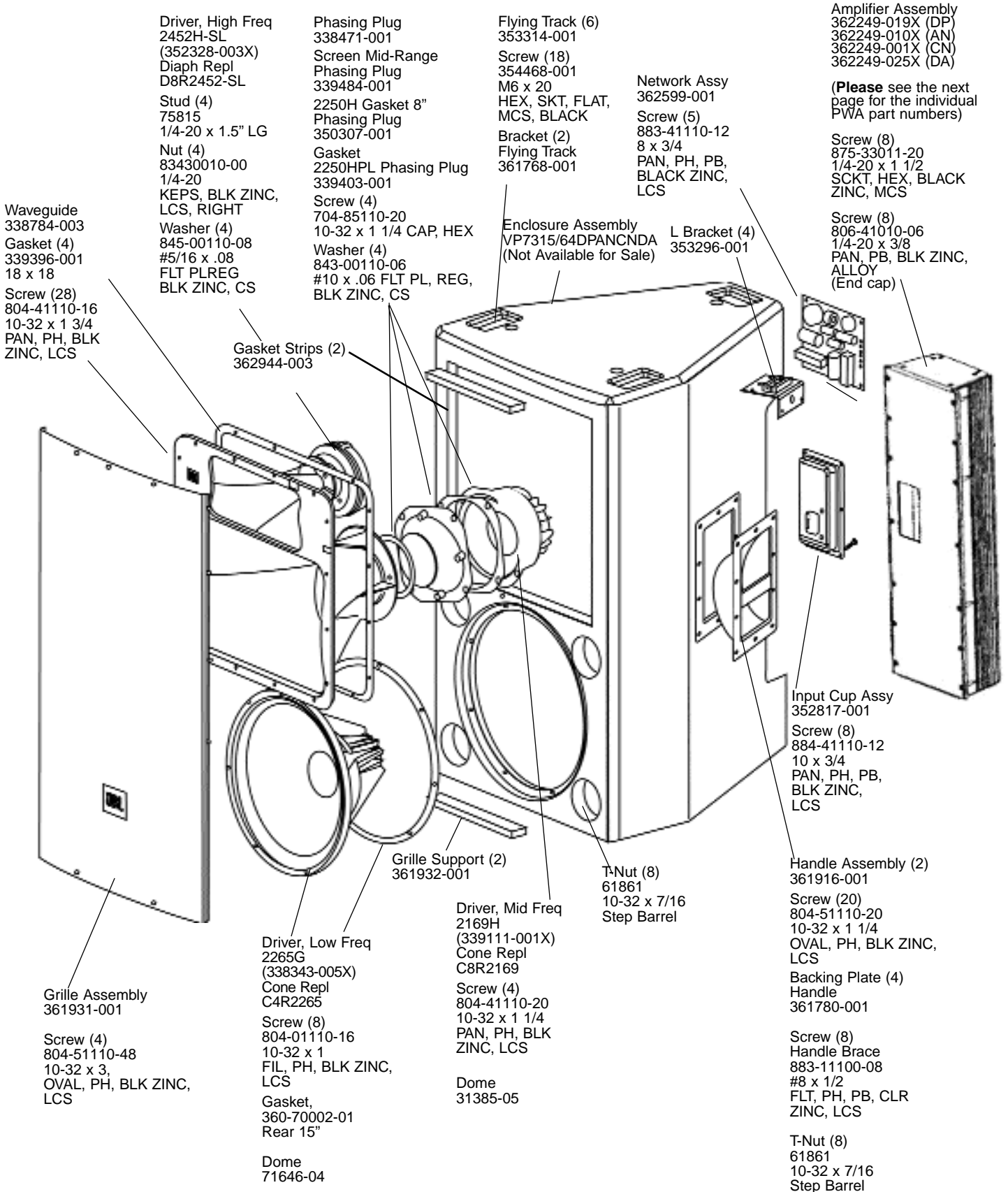

JBL VP7315/64DPAN/CN/DA

DP2 AMPLIFIER ASSEMBLY REFERENCE

AMPLIFIER ASSEMBLY 362249-001

Amplifier Assemblies

DP2	
Note: Amplifier assembly includes the input module.	
Part No.	Description
362249-001	Amp. Assembly, Base Model, VP/VT-Series
362249-002X	Amplifier Assembly, VP7212/95DPAN
362249-003X	Amplifier Assembly, VP7212/95DPCN
362249-004X	Amplifier Assembly, VP7212/64DPAN
362249-005X	Amplifier Assembly, VP7212/64DPCN
362249-006X	Amplifier Assembly, VP7215/95DPAN
362249-007X	Amplifier Assembly, VP7215/95DPCN
362249-008X	Amplifier Assembly, VP7215/64DPAN
362249-009X	Amplifier Assembly, VP7215/64DPCN
362249-010X	Amplifier Assembly, VP7315/64DPAN
362249-011X	Amplifier Assembly, VP7315/64DPCN
362249-012X	Amplifier Assembly, VT4887ADP
362249-013X	Amplifier Assembly, VT4887ADP-AN
362249-014X	Amplifier Assembly, VT4887ADP-CN
362249-015X	Amplifier Assembly, VP7212/95DP
362249-016X	Amplifier Assembly, VP7212/64DP
362249-017X	Amplifier Assembly, VP7215/95DP
362249-018X	Amplifier Assembly, VP7215/64DP
362249-019X	Amplifier Assembly, VP7315/64DP
362249-020X	Amplifier Assembly, VT4887ADP-DA
362249-021X	Amplifier Assembly, VP7212/95DPDA
362249-022X	Amplifier Assembly, VP7212/64DPDA
362249-023X	Amplifier Assembly, VP7215/95DPDA
362249-024X	Amplifier Assembly, VP7215/64DPDA
362249-025X	Amplifier Assembly, VP7315/64DPDA

Input Modules

Note: If ordering an input module you must order 1 of the tuning files below depending on the system model number.

	DP-dbx Horizontal 364263-001X	DP-AN Horizontal 363372-001X	DP-CN Horizontal 363373--001X	DP-DA Horizontal 444668-001X
Model Numbers				
VP7212/95DP	364092-001	362342-001	362343-001	445131-001
VP7212/64DP	364093-001	362340-001	362341-001	445132-001
VP7215/95DP	364094-001	362347-001	362348-001	445133-001
VP7215/64DP	364095-001	362345-001	362346-001	441534-001
VP7315/64DP	364096-001	362349-001	362350-001	441535-001
	DP-dbx 361541-001X	DP-AN 361092-001X	DP-CN 361093-001X	DP-DA 444668-001X
Model Numbers				
VT4887ADP	363145-001	363455-001	363456-001	444804-001

DP2 AMPLIFIER ASSEMBLY REFERENCE

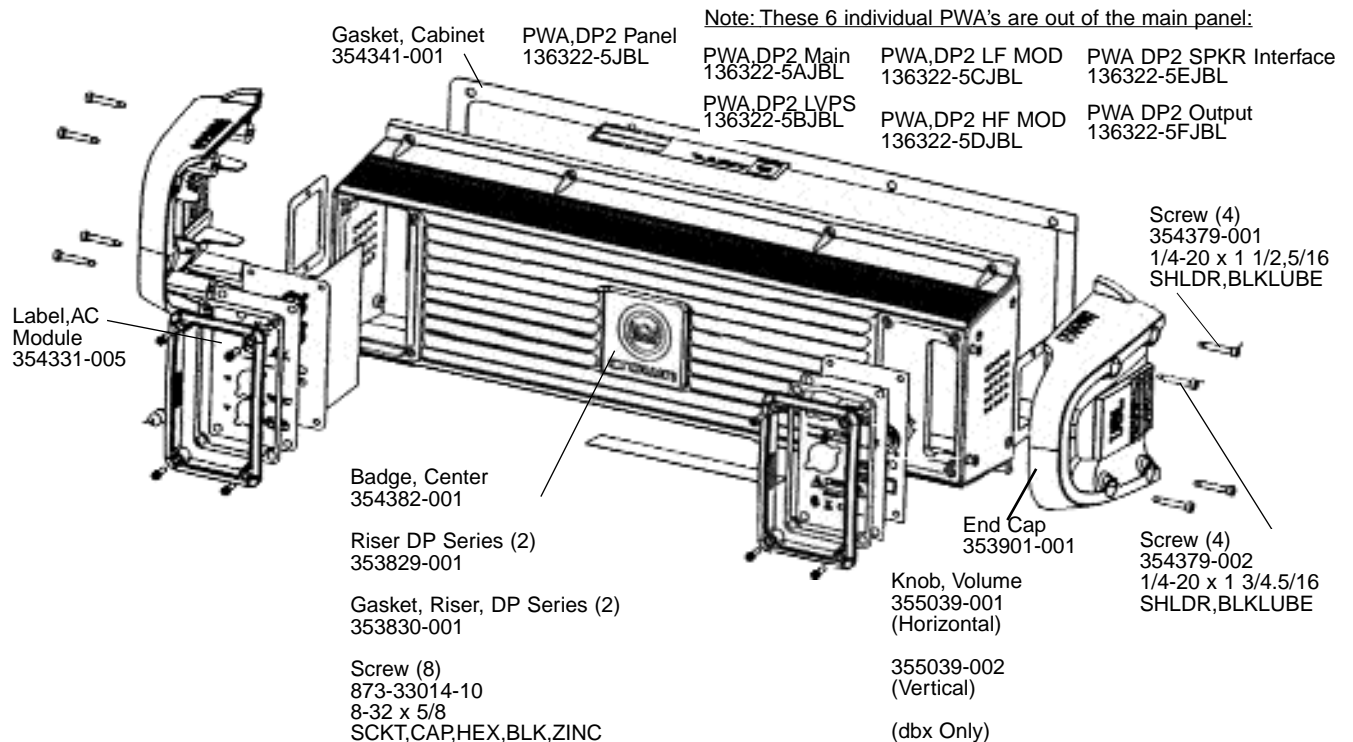

***Note:** end-caps are not required for or included with Venue Performance sales models.