

# Technical Manual



# JBL 5742-M/HF

## SPECIFICATIONS

### ACOUSTIC & ELECTRICAL SPECIFICATIONS:

- Nominal Impedance: MF: 2 x 4 Ohms, HF: 8 Ohms
- Input Power Rating: MF: 2 x 700W; 1000 to 2000W recommended amplifier  
HF: 500W to 1000W recommended amplifier
- Frequency Response: 220 Hz - 19 kHz ( ±3 dB)
- Frequency Range: 220 Hz -20 kHz (-10 dB)
- Sensitivity: MF: 115 dB SPL, 2.83V @ 1 meter (3.3 ft)  
HF: 115 dB SPL, 2.83V @ 1 meter (3.3 ft)
- Crossover Frequency:

### SYSTEM COMPONENTS:

- Cabinet: Enclosure (Not for Sale)
- Mid Frequency Transducer: (4) 2169H, 200 mm (8 in) dia. Differential Drive® Neodymium Magnet, 76 mm (3 in) dual coil edgewound ribbon voice coil
- DC Resistance: 5.1 ohms ±10% Aluminum Wire

### SYSTEM COMPONENTS: (CONT'D)

- DC Resistance: 5.1 ohms ±10% Aluminum Wire
- High Frequency Driver: 2452H-SL 38 mm (1.5 in) exit compression driver with 100 mm (4 in) diameter voice coil and Neodymium magnet.
- DC Resistance: 4.10 ohms ±8%
- Terminal / Wire Assembly: 444716-001

### AURAL SWEEP TEST SPECIFICATIONS:

- A. M.F. Aural Sweep Test: 7.0V Input, 20 Hz to 1kHz
- B. H.F. Aural Sweep Test: 2.5V Input, 300 Hz to 1.2 kHz

### PHYSICAL SPECIFICATIONS:

- Enclosure Dimensions: 1544 x 762 x 450 mm D (60.8 x 30.0 x 17.8 in. D)
- Shipping Weight: 99 lb (45.1 kg)

### WARRANTY INFORMATION:

- Refer to Warranty Statement packed with each product.

## PACKAGE

Warranty 59660



- Carton 990-00204-00
- Filler, Top 991-00204-01
- Filler, Bottom 365534-001
- PKG, Microfoam (8) 49790P 20" x 18" Sheets
- Rear Filler 443525-001
- Tray, Bottom 991-00207-00

## WIRING DIAGRAM

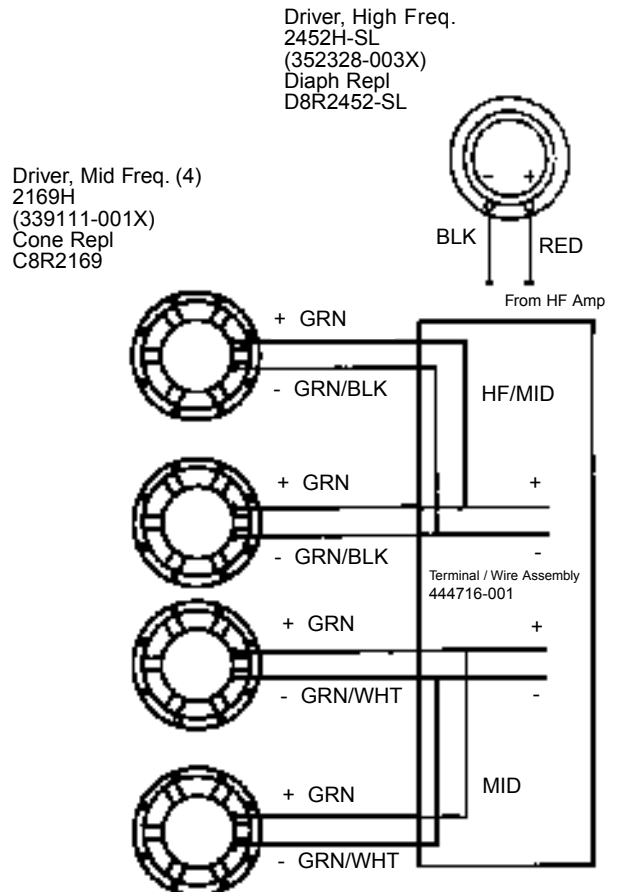

JBL 5742-M/HF REV C

# JBL 5742-M/HF

## COMPONENT EXPLODED VIEW

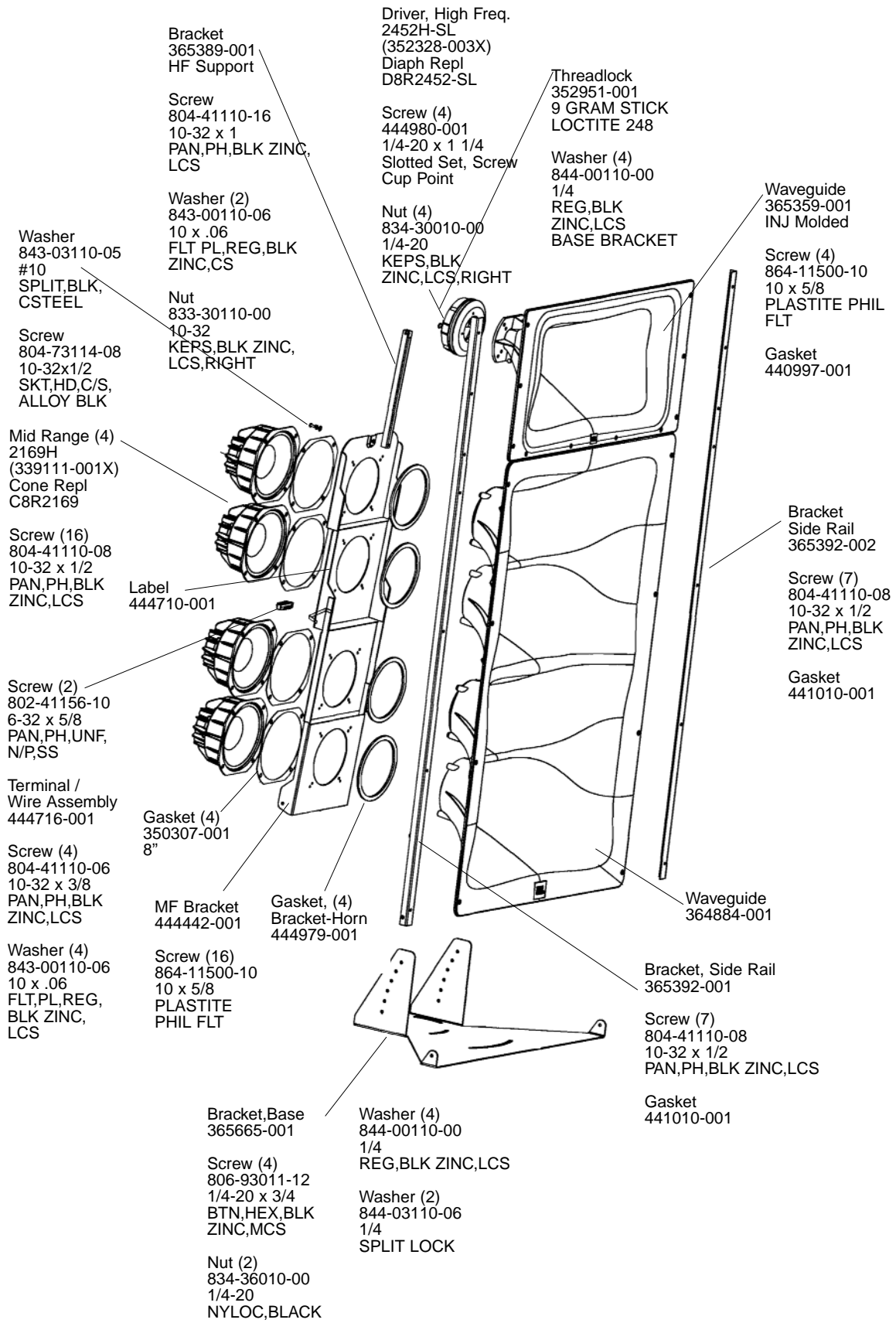

JBL 5742-M/HF