

# Technical Manual

# JBL3678-HF



## SPECIFICATIONS

### ACOUSTIC & ELECTRICAL SPECIFICATIONS:

- Nominal Impedance: 8 ohm
- Power Capacity: 70W Continuous Program Above 800 Hz  
100W Continuous Program Above 1.2 kHz
- Frequency Range: 500 Hz to 20 kHz
- Sensitivity: 110 dB SPL\* - On-Axis On Horn
- Crossover Frequency: 1.2 kHz Recommended

### SYSTEM COMPONENTS:

- Horn: 2342
- Bracket: Adjustable Clamp Type
- High Frequency Transducer: 44mm (1-3/4 in.) Pure Titanium Diaphragm Compression Driver 2425HS (66923X)
- DC Resistance: 3.2 ohm  $\pm$ 8% Aluminum Wire

### AURAL SWEEP TEST SPECIFICATIONS:

- A. H.F. Aural Sweep Test: 2.83V Input, 550 Hz to 1.2 kHz

### PHYSICAL SPECIFICATIONS:

- Overall Dimensions: 229mm x 229mm x 229mm D (9.0 x 9.0 x 9.0 in. D)
- Shipping Weight: 8 lbs. (3.6 kg.)

### WARRANTY INFORMATION:

- Refer to Warranty Statement packed with each product.

\*1 Watt (2.83 V RMS) @ 1 Meter

## PACKAGE

Warranty 59660  
Owners Manual 980-00023-00  
Literature 980-00018-00

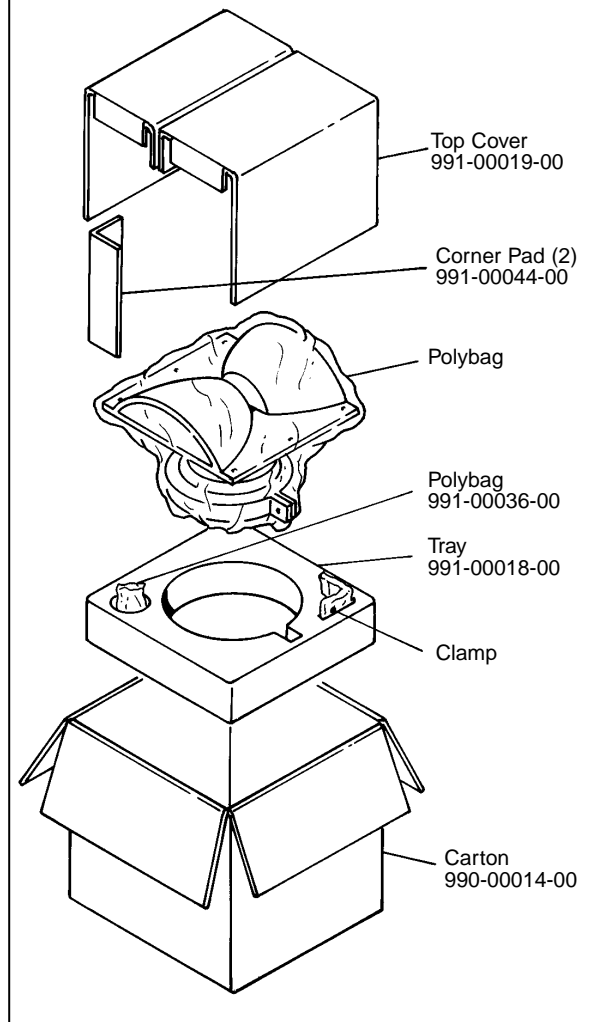

## WIRING DIAGRAM

Speaker, High Freq  
2425HS (66923X)  
Diaph Repl  
D8R2425

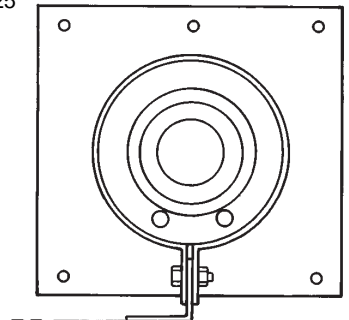

### TILT DEGREE CLAMP BASE 331165-001

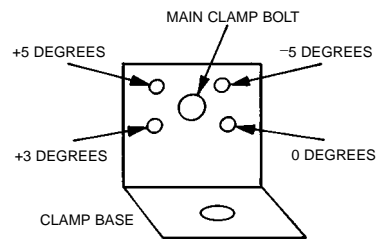

(SHOWN WITH BOTTOM SECTION FACING THE VIEWER)

NOTE: SEE BACK PAGE OF JBL3678-LF (REF)

# JBL3678-HF

## COMPONENT EXPLODED VIEW

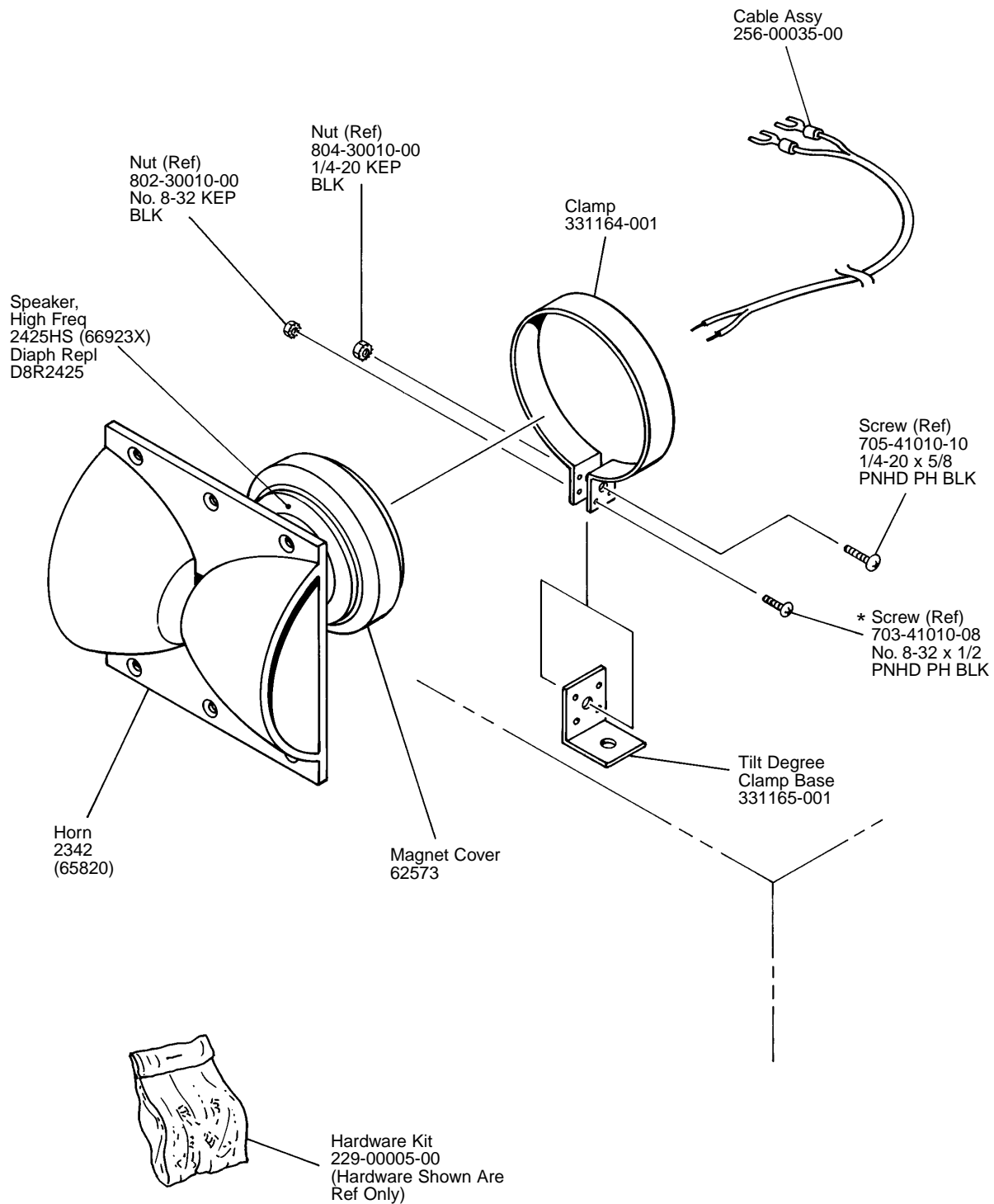

\* Position Screw Per Instruction Manual