

Technical Manual

JBL4782A DUAL 300 MM (12") TRIPLE CHAMBER BANDPASS™ SUB-BASS SYSTEM



SPECIFICATIONS

ACOUSTIC & ELECTRICAL SPECIFICATIONS:

- Nominal Impedance: 4 ohm
- Power Rating: AES Pink Noise: 1200W
- Frequency Response: 35 Hz to 190 Hz (± 3dB)
- Sensitivity: 98 dB SPL*
- Crossover Frequencies: 80 Hz to 120 Hz, 30 Hz Low Cut

SYSTEM COMPONENTS:

- Cabinet: C4782A
- Grille: N/A

*1 Watt (2.83 V RMS) @ 1 Meter

SYSTEM COMPONENTS: (cont'd)

- Low Frequency Transducer: 300mm (12 in.) Cone Transducer (2206H) (2)
- Crossover Network: JBL/UREI 5235 Active Crossover 53-5334 Crossover Card

PHYSICAL SPECIFICATIONS:

- Enclosure Dimensions: 620mm x 1050mm x 550mm D (24.37 x 41.37 x 21.62 in. D)
- Shipping Weight: 121 lbs. (55 kg)

WARRANTY INFORMATION:

- Refer to the Warranty Statement packed with each product.

WIRING DIAGRAM

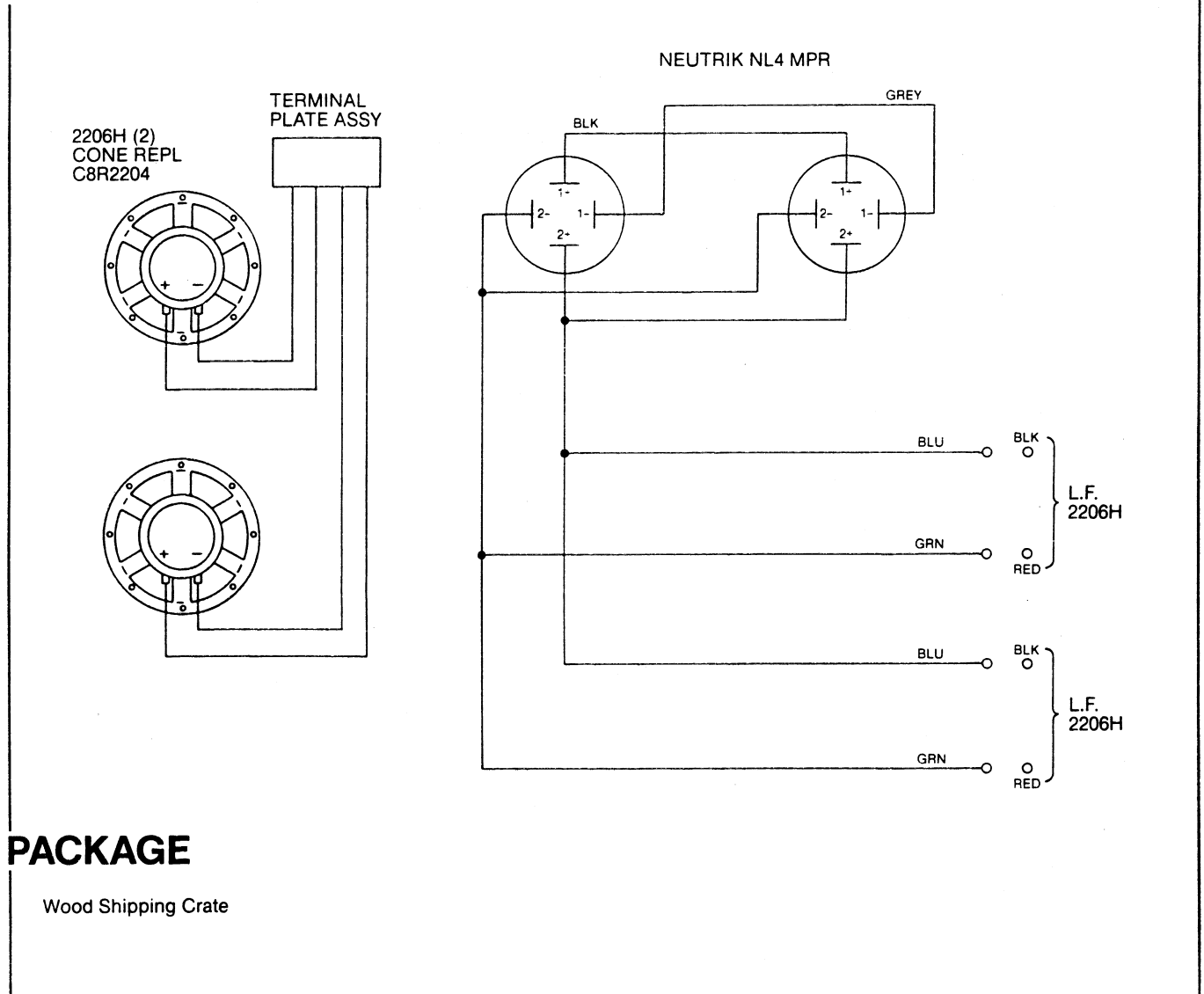

PACKAGE

Wood Shipping Crate

JBL4782A REV A

JBL4782A

COMPONENT EXPLODED VIEW

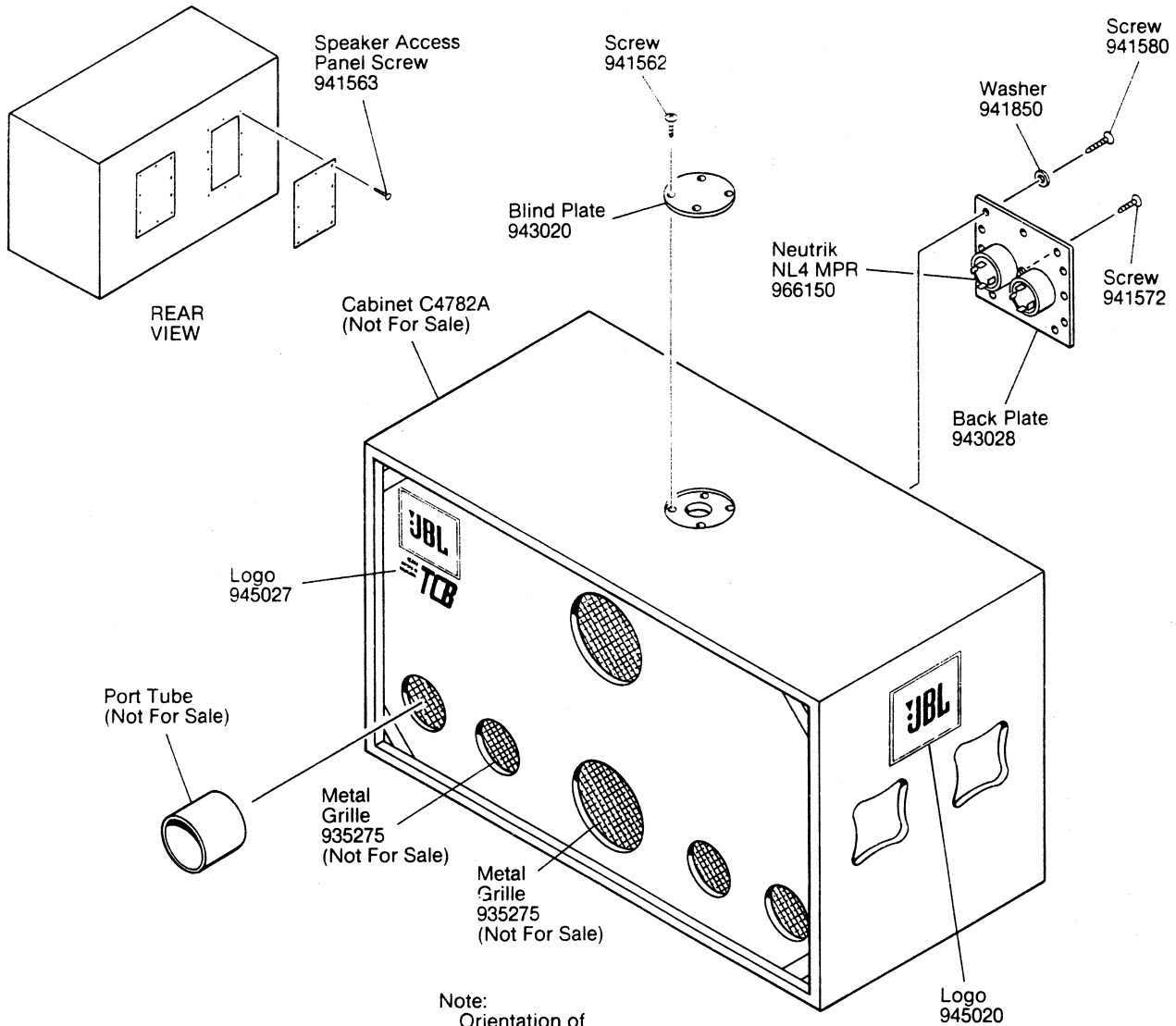

Note:
Orientation of
Speakers in Cabinet

Speaker, Low Freq (2)
2206H
Cone Repl
C8R2206

Metal Bar
943011 (2)

Screw, Allen Hd
941594

Note:
Screw for
T-Nuts
941563