

# Technical Manual

# JBL SRX738/F

## SPECIFICATIONS



### ACOUSTIC & ELECTRICAL SPECIFICATIONS:

- Nominal Impedance: 8 Ohms
- Power Capacity: Continuous / Program / Peak:  
Passive: 800W / 1600W / 3200W  
Bi-amp LF: 800W / 1600W / 3200W  
Bi-amp MF/HF: 350W / 700W / 1400W
- Frequency Range: 35 Hz – 20 kHz (–10 dB)
- Maximum SPL: 130 dB SPL peak (1 watt @ 1 meter)
- System Sensitivity: Passive Mode 95 dB SPL (1 watt @ 1 meter)
- Mid / High Sensitivity: Bi-amp Mode 108 dB SPL (1 watt @ 1 meter)
- Crossover Freq.: 2 kHz / 350 Hz

### SYSTEM COMPONENTS:

- Cabinet: Enclosure (Not For Sale)
- Grille: 354030-001
- Low Frequency Transducer: 2268HPL, 457 mm (18 in) Differential Drive
- DC Resistance: 5.3 ohms ± 10%
- Mid Frequency Transducer: 2169H, 200 mm (8 in) Cone Midrange Compression Driver

### SYSTEM COMPONENTS: (CONT'D)

- DC Resistance: 5.1 ohms ± 10%
- High Frequency Transducer: 2431H, 102 mm (4 in) voice coil, neodymium-magnet compression driver
- DC Resistance: 4.0 ohms ± 10%
- Crossover Network: 354158-001

### AURAL SWEEP TEST SPECIFICATIONS:

- A. System Aural Sweep Test: 10.0V Input, 20 Hz to 20 kHz
- B. L.F. Aural Sweep Test: 10.0V Input, 20 Hz to 1 kHz
- C. H.F. Aural Sweep Test: 2.83V Input, 550 Hz to 20 kHz

### PHYSICAL SPECIFICATIONS:

- Enclosure Dimensions: 1022 x 533 x 508 mm D (40.25 x 21.0 x 20.0 in. D)
- Net Weight: 95 lb (43 kg.)

### WARRANTY INFORMATION:

- Refer to Warranty Statement packed with each product.

## PACKAGE

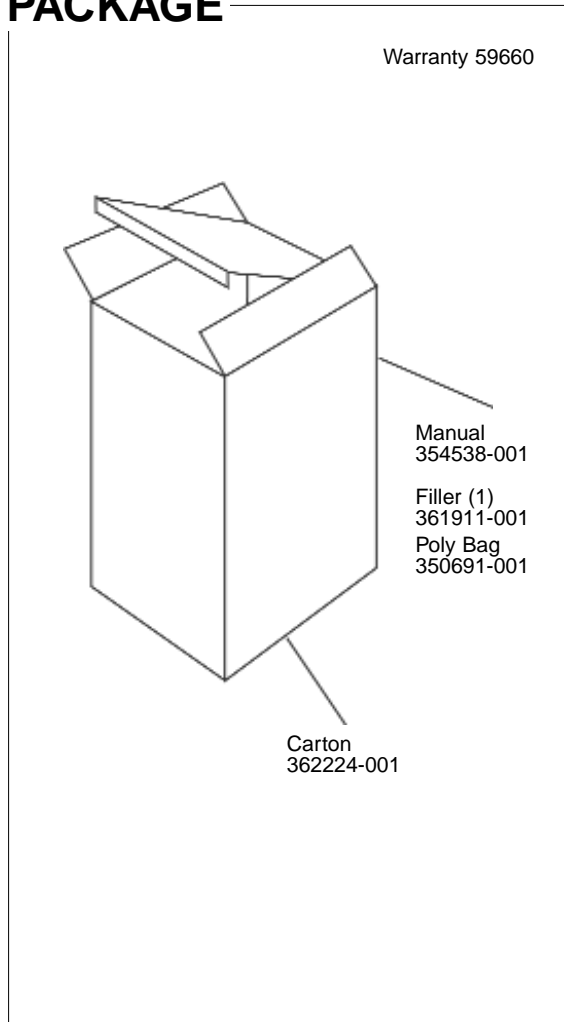

## WIRING DIAGRAM

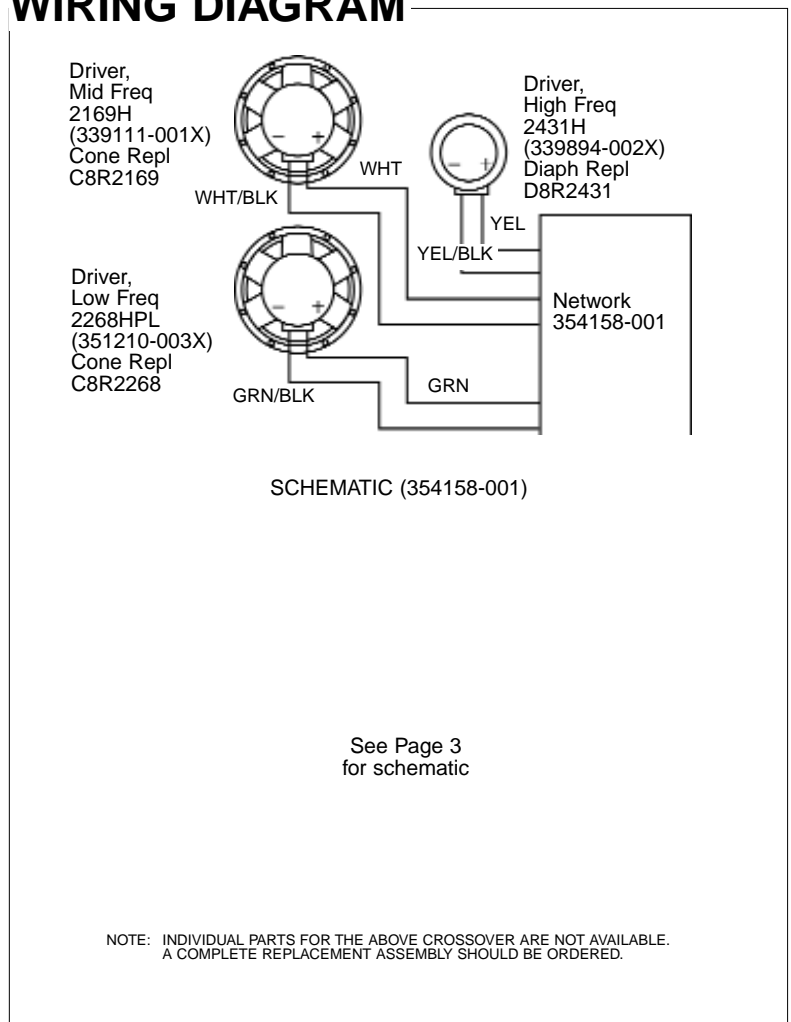

JBL SRX738/F REV S

# JBL SRX738/F

## COMPONENT EXPLODED VIEW

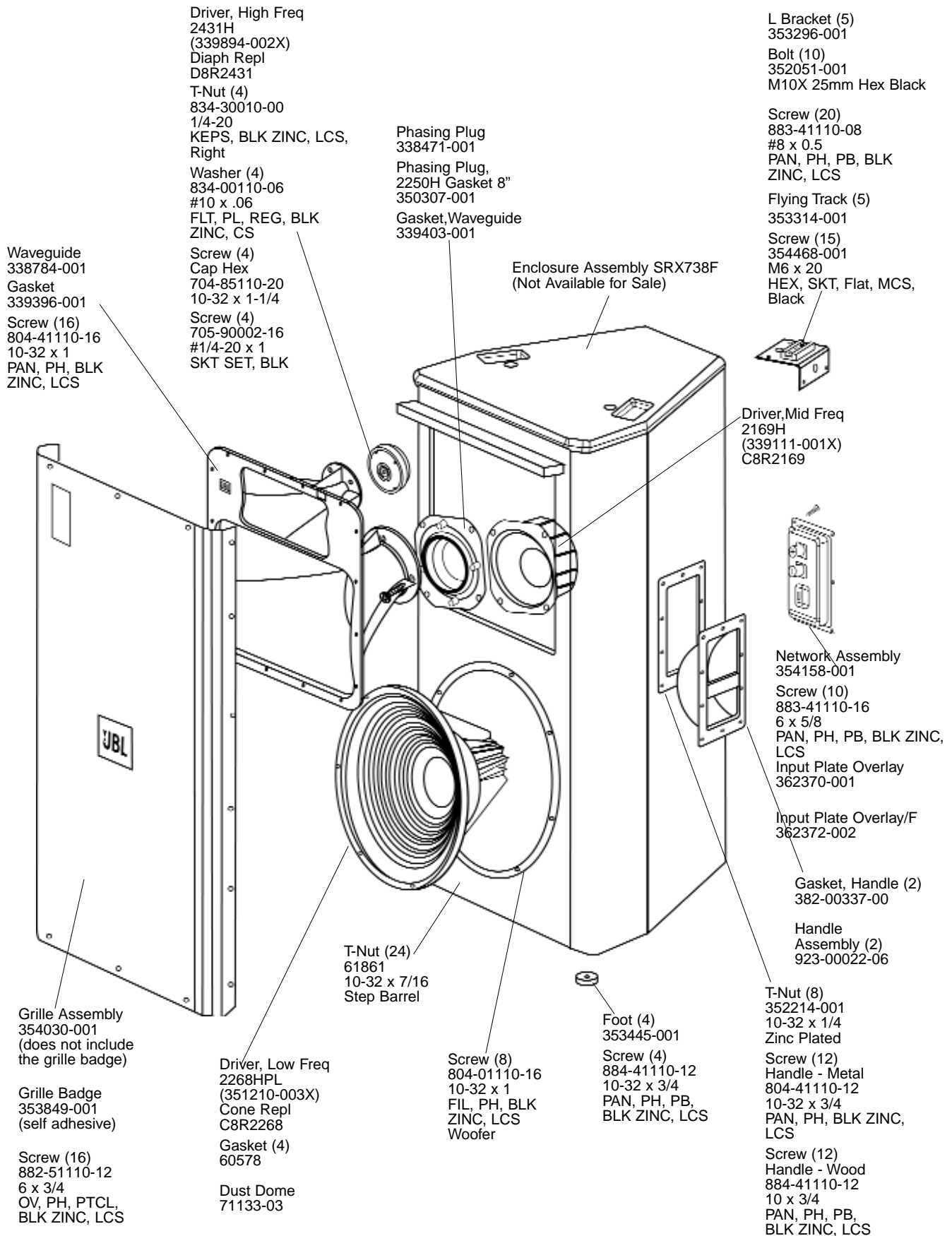

# JBL SRX738/F

SCHEMATIC (354158-001)

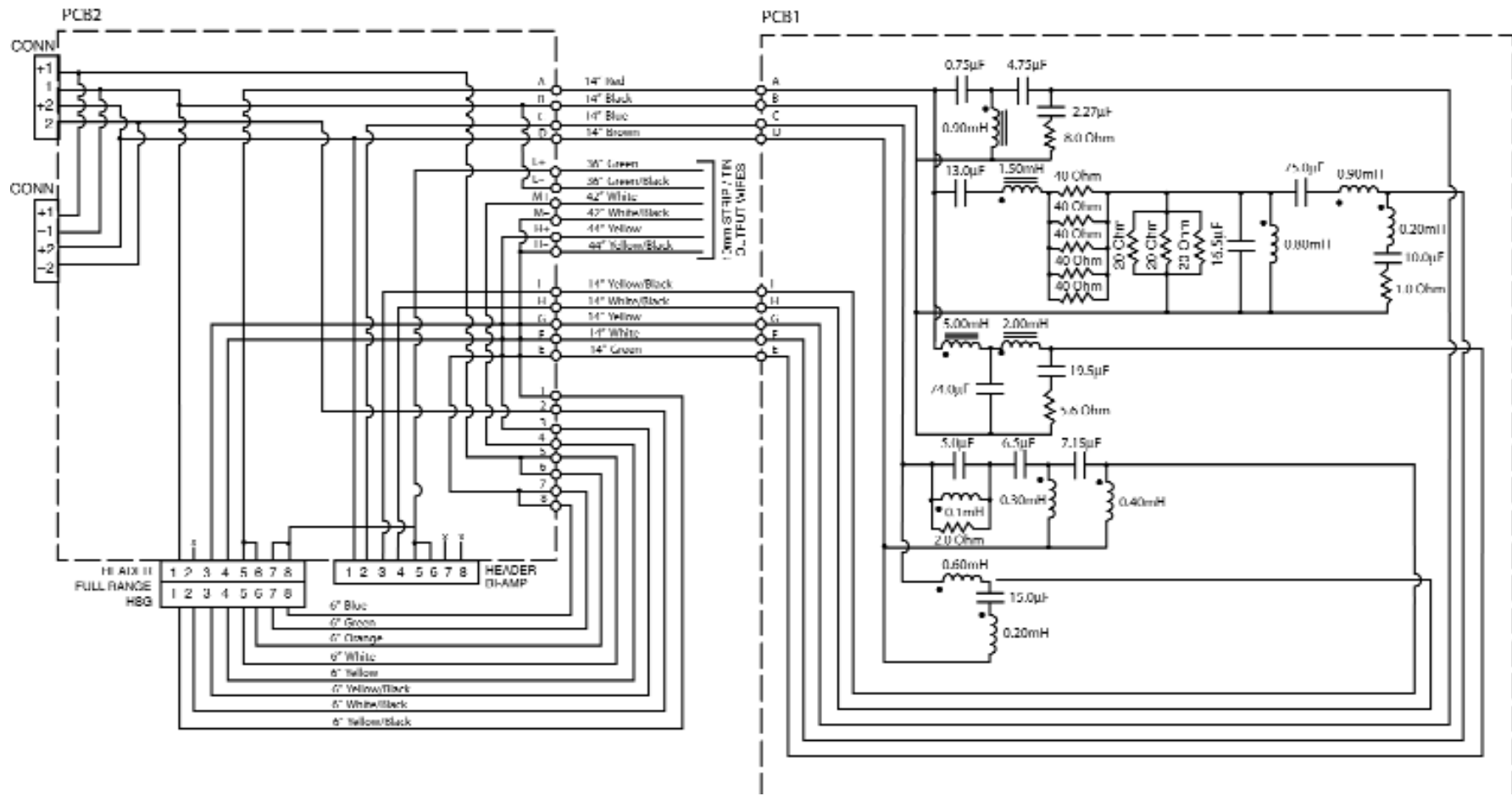

NOTE: INDIVIDUAL PARTS FOR THE ABOVE CROSSOVER ARE NOT AVAILABLE. A COMPLETE REPLACEMENT ASSEMBLY SHOULD BE ORDERED.