

Technical Manual

JBL PD5322/95-WH



SPECIFICATIONS

ACOUSTIC & ELECTRICAL SPECIFICATIONS:

- Nominal Impedance: 8 ohms
- Power Capacity: L.F. 1600 W (6400 W Peak), 2 Hrs (AES) 1200 W (4800 w Peak), 100 Hrs
M.F. 350 W (1400 W peak), 100 hrs.
H.F. 75 W (300 W Peak), 2 Hrs
- Frequency Range: 41 Hz – 17 kHz (–10 dB)
- Maximum SPL: Tri-amp mode: L.F. 128 dB SPL cont avg (134 dB peak)
M.F. 134 dB SPL cont avg (140 dB peak)
H.F. 133 dB SPL cont avg (139 dB peak)
Passive mode: 134 dB SPL cont avg (140 dB peak)
- System Sensitivity: Passive Mode 109 dB SPL (mid/high section only)
- Passive Crossover: 6th Order (36 dB/Oct) Linkwitz-Riley
HP and LP, 1.5 kHz

SYSTEM COMPONENTS:

- Cabinet: (Not For Sale)
- Grille: 352235-001, 352235-003 (Wh)
- Low Frequency Transducer: 300mm (12 in.) Driver with 100mm (4 in.) Voice Coil (2206HPL)
- DC Resistance: 5 ohms

- Mid Frequency 200mm (8 in) Neodymium Transducer: Differential Drive NDD™ dual 75mm (3 in) voice coil (2169H)
- DC Resistance: 5.1 ohms
- High Frequency Transducer: 38mm (1.5 in.) Exit Compression Driver with 100mm (3 in.) Voice Coil (2431H)
- DC Resistance: 4.0 ohms ± 10%
- Crossover Network 352610-001

AURAL SWEEP TEST SPECIFICATIONS:

- A. System Aural Sweep Test:
- B. L.F. Aural Sweep Test: 10.0V Input, 20 Hz to 1.2 kHz
- C. M.F. Aural Sweep Test: 7.0V Input, 20 Hz to 1 kHz
- D. H.F. Aural Sweep Test: 2.83V Input, 550 Hz to 20 kHz

PHYSICAL SPECIFICATIONS:

- Enclosure Dimensions: 991mm x 673mm x 706mm D (39.0 x 26.5 x 27.8 in. D)
- Net Weight: 170 lbs. (77 kg.)

WARRANTY INFORMATION:

- Refer to Warranty Statement packed with each product.

PACKAGE

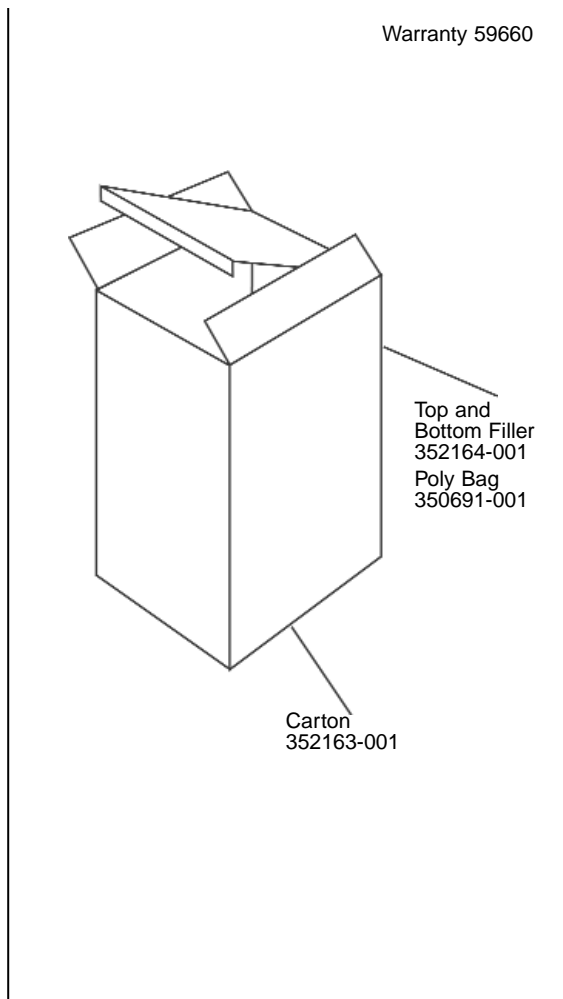

WIRING DIAGRAM

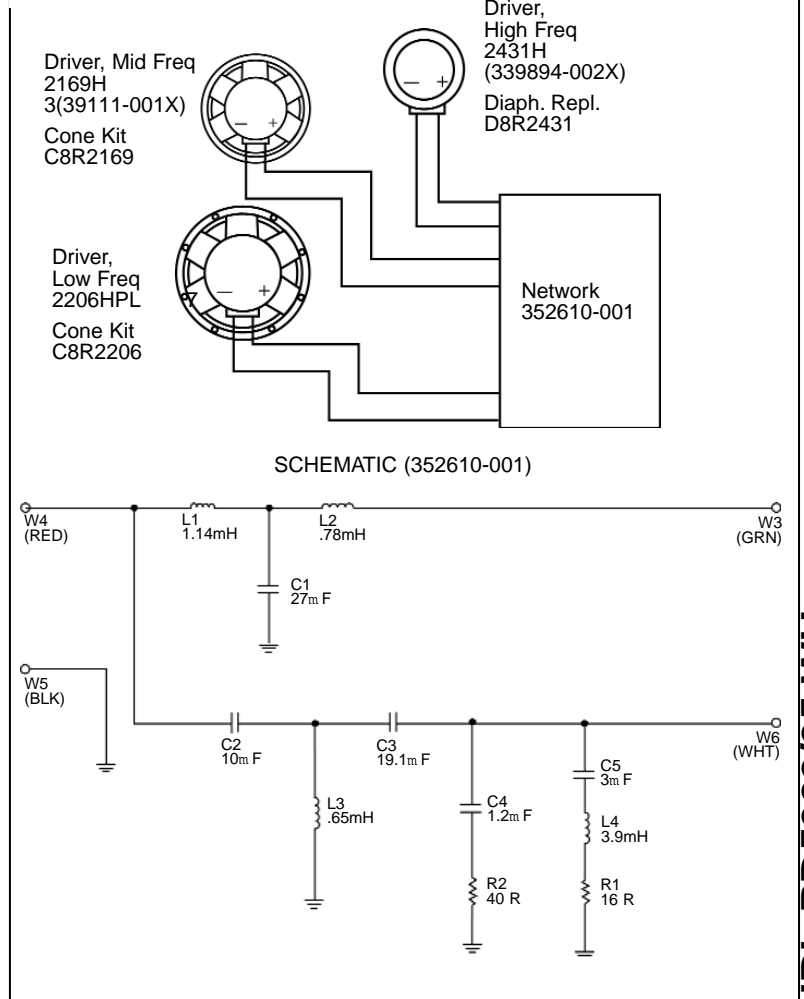

JBL PD5322/95-WH

COMPONENT EXPLODED VIEW

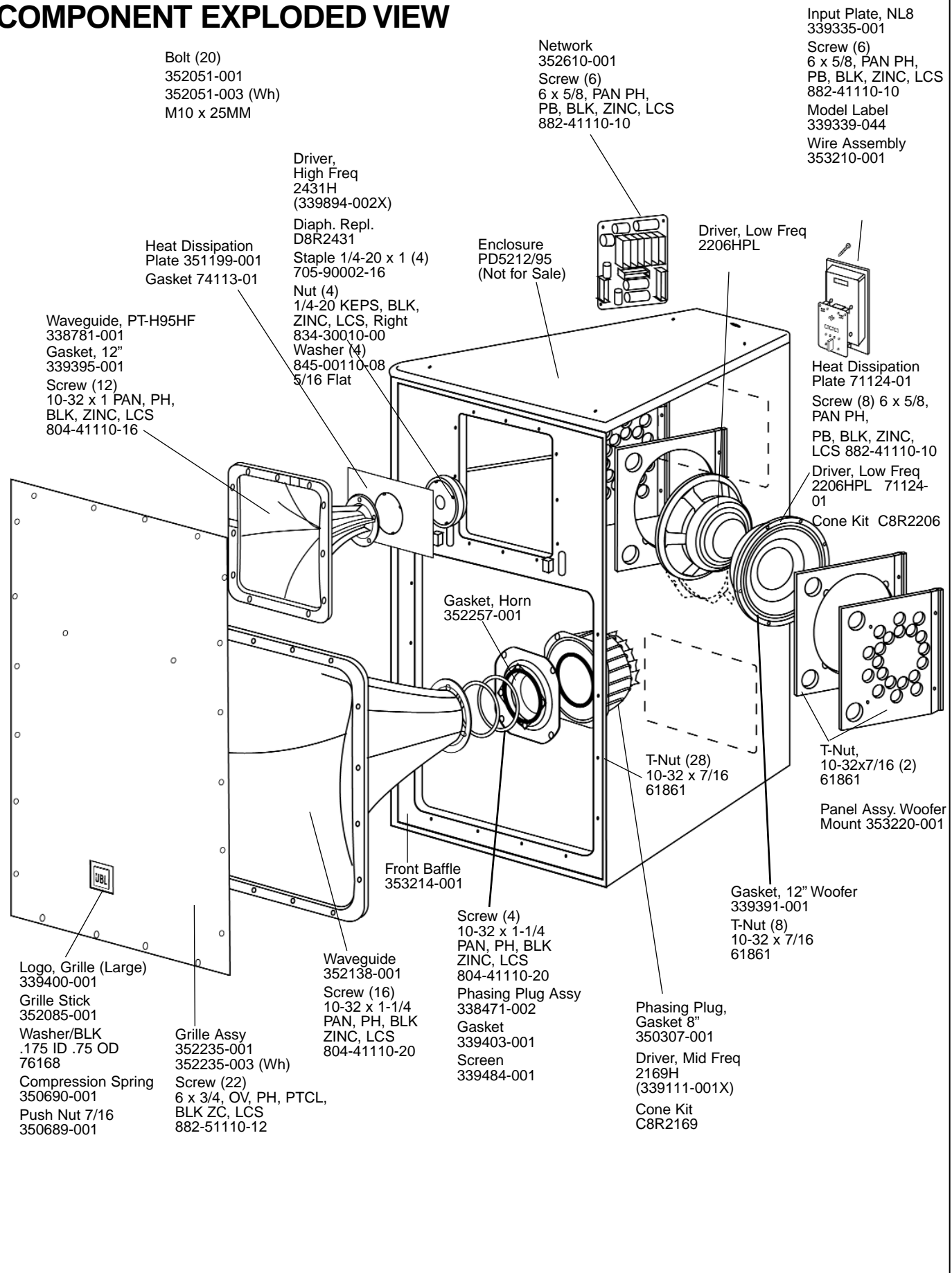

Bolt (20)
352051-001
352051-003 (Wh)
M10 x 25MM

Network
352610-001
Screw (6)
6 x 5/8, PAN PH,
PB, BLK, ZINC, LCS
882-41110-10

Input Plate, NL8
339335-001
Screw (6)
6 x 5/8, PAN PH,
PB, BLK, ZINC, LCS
882-41110-10
Model Label
339339-044
Wire Assembly
353210-001

Driver,
High Freq
2431H
(339894-002X)

Heat Dissipation
Plate 351199-001
Gasket 74113-01

Enclosure
PD5212/95
(Not for Sale)

Driver, Low Freq
2206HPL

Waveguide, PT-H95HF
338781-001
Gasket, 12"
339395-001
Screw (12)
10-32 x 1 PAN, PH,
BLK, ZINC, LCS
804-41110-16

Diaph. Repl.
D8R2431
Staple 1/4-20 x 1 (4)
705-90002-16
Nut (4)
1/4-20 KEPS, BLK,
ZINC, LCS, Right
834-30010-00
Washer (4)
845-00110-08
5/16 Flat

Heat Dissipation
Plate 71124-01
Screw (8) 6 x 5/8,
PAN PH,
PB, BLK, ZINC,
LCS 882-41110-10
Driver, Low Freq
2206HPL 71124-
01
Cone Kit C8R2206

Gasket, Horn
352257-001

T-Nut,
10-32x7/16 (2)
61861

Panel Assy. Woofer
Mount 353220-001

Front Baffle
353214-001

Gasket, 12" Woofer
339391-001
T-Nut (8)
10-32 x 7/16
61861

Logo, Grille (Large)
339400-001
Grille Stick
352085-001
Washer/BLK
.175 ID .75 OD
76168
Compression Spring
350690-001
Push Nut 7/16
350689-001

Grille Assy
352235-001
352235-003 (Wh)
Screw (22)
6 x 3/4, OV, PH, PTCL,
BLK ZC, LCS
882-51110-12

Waveguide
352138-001
Screw (16)
10-32 x 1-1/4
PAN, PH, BLK
ZINC, LCS
804-41110-20

Screw (4)
10-32 x 1-1/4
PAN, PH, BLK
ZINC, LCS
804-41110-20
Phasing Plug Assy
338471-002
Gasket
339403-001
Screen
339484-001

Phasing Plug,
Gasket 8"
350307-001
Driver, Mid Freq
2169H
(339111-001X)
Cone Kit
C8R2169

JBL PD53220/95-WH