

Technical Manual

JBL PD5322/43-WH



SPECIFICATIONS

ACOUSTIC & ELECTRICAL SPECIFICATIONS:

- Nominal Impedance: 8 ohms
- Power Capacity: Continuous / Program / Peak:
Passive: 800 W / 1600 W / 3200 W
Bi-amp LF: 800 W / 1600 W / 3200 W
Bi-amp MF/HF: 350 W / 700 W / 1400 W
- Frequency Range: 35 Hz – 20 kHz (–10 dB)
- Maximum SPL: 130 dB SPL peak (1w @ 1m)
- System Sensitivity: Passive Mode 95 dB SPL (1w @ 1m)
- Mid / High Sensitivity: Bi-amp Mode 108 dB SPL (1w @ 1m)
- Crossover Freq.: M/H 1.7 k

SYSTEM COMPONENTS:

- Cabinet: (Not For Sale)
- Grille: 352235-001, 352235-003 (Wh)
- Low Frequency Transducer: 457 mm (12 in) Differential Drive 2206H
- DC Resistance: 5.1 ohms ± 10%

- Mid Frequency Transducer: 200 mm (8 in) Cone Midrange Compression Driver 2169H
- DC Resistance: 5.1 ohms ± 10%
- High Frequency Transducer: 102 mm (4 in) voice coil, neodymium-magnet compression driver 2431H
- DC Resistance: 4.1 ohms ± 10%
- Crossover Network: 353027-001

AURAL SWEEP TEST SPECIFICATIONS:

- A. System Aural Sweep Test: 10.0V Input, 20 Hz to 20 kHz
- B. L.F. Aural Sweep Test: 10.0V Input, 20 Hz to 1 kHz
- C. H.F. Aural Sweep Test: 2.83V Input, 550 Hz to 20 kHz

PHYSICAL SPECIFICATIONS:

- Enclosure Dimensions: 1092 mm x 541 mm x 648 mm D (39 in. x 26.5 in. x 35.3 in. D)
- Net Weight: 185 lbs. (43 kg.)

WARRANTY INFORMATION:

- Refer to Warranty Statement packed with each product.

PACKAGE

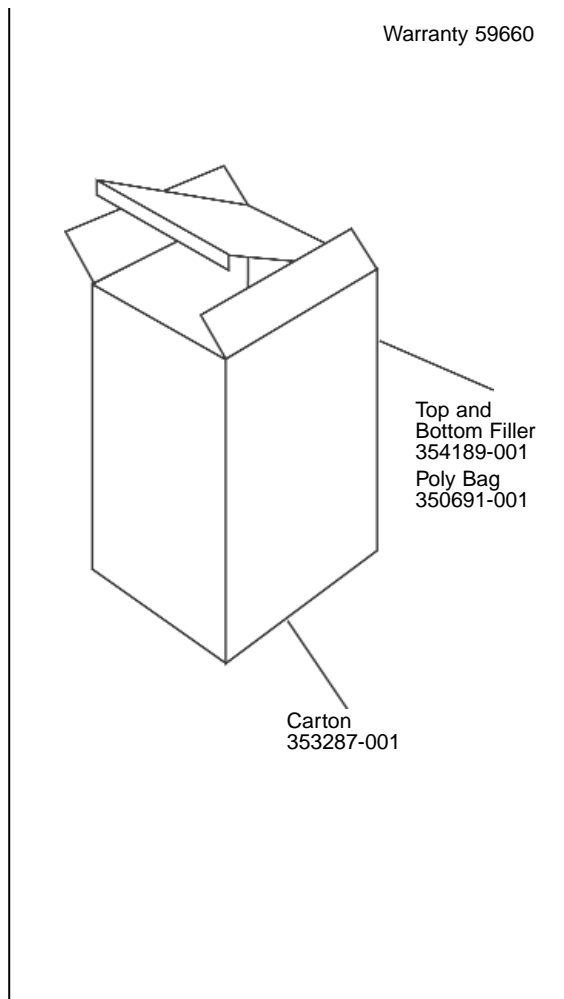

WIRING DIAGRAM

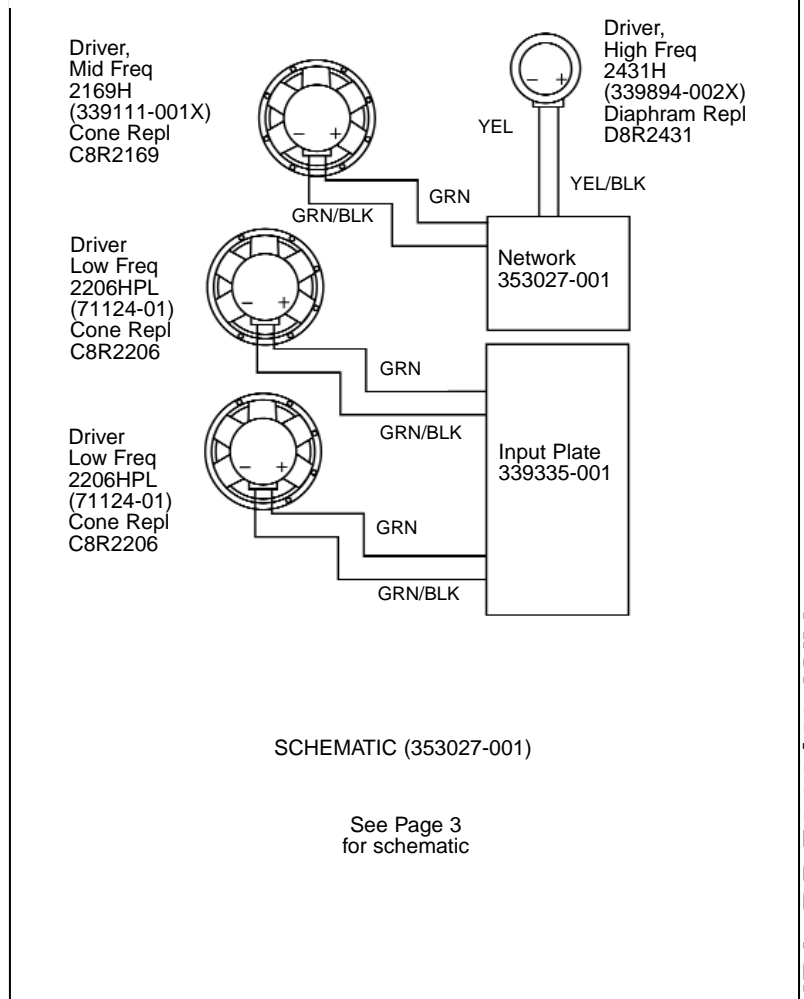

JBL PD5322/43-WH REV D

JBL PD5322/43-WH

COMPONENT EXPLODED VIEW

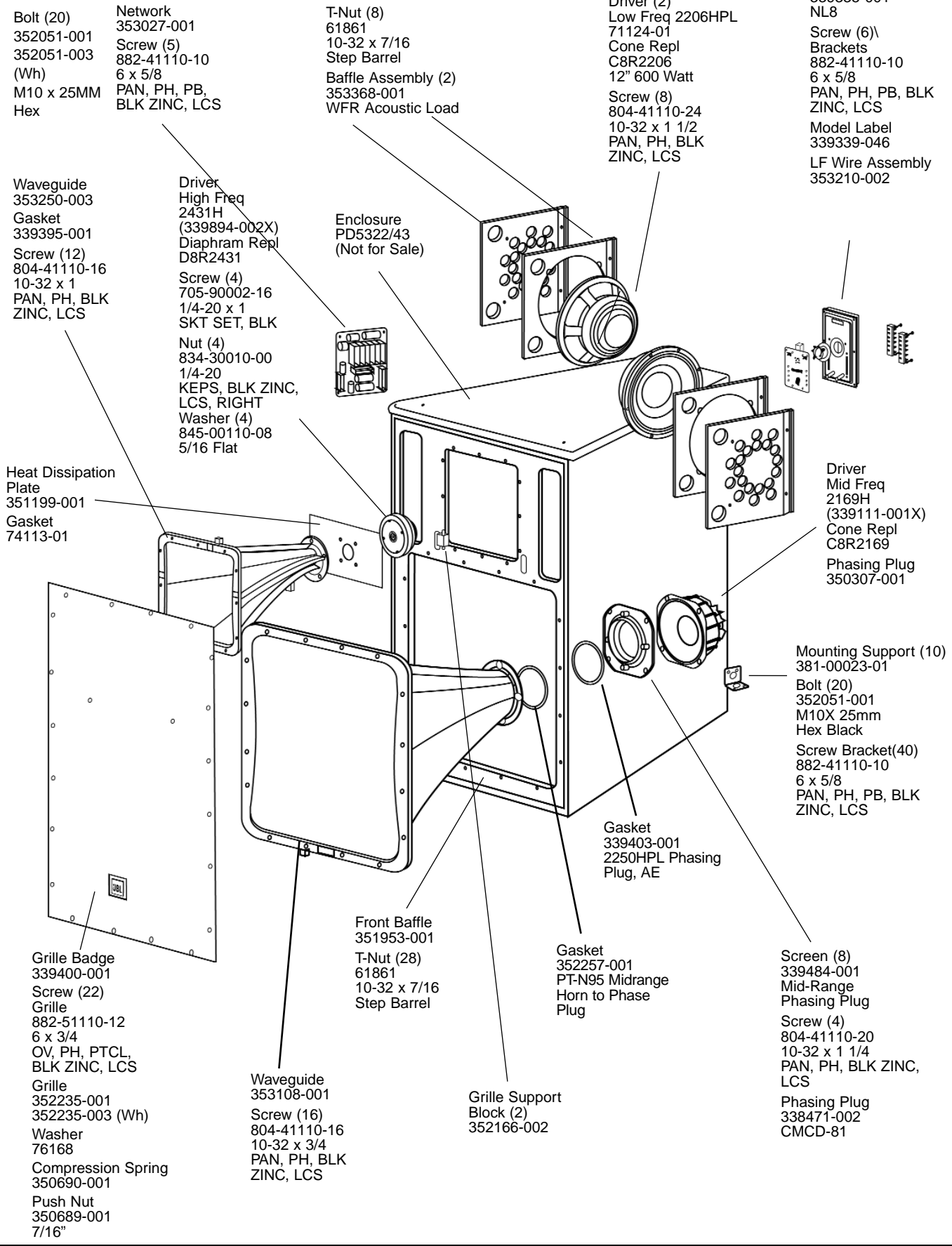

JBL PD5322/43-WH

JBL PD5322/43-WH

SCHEMATIC (353027-001)

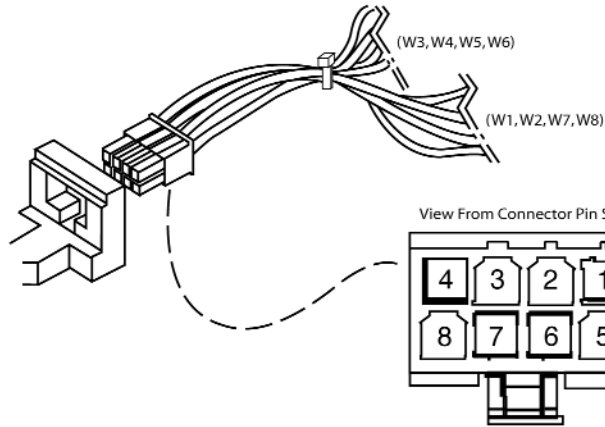
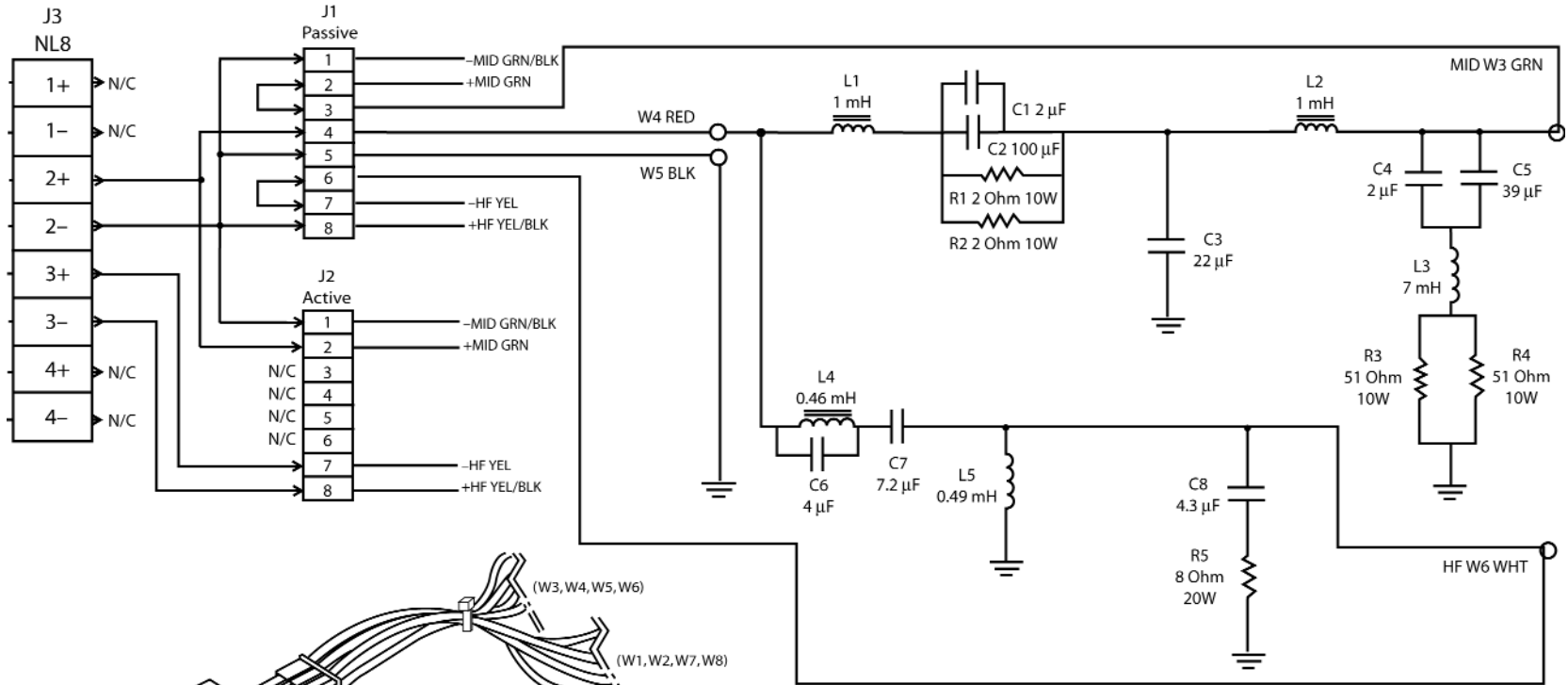

PIN/Wire	Wire Color
W1	GRN/BLK Stripped and Tinned
W2	GRN Stripped and Tinned
W3	GRN
W4	RED
W5	BLK
W6	WHT
W7	YEL/BLK Stripped and Tinned
W8	YEL Stripped and Tinned