

# Technical Manual

# JBL PD5212/64-WH



PROFESSIONAL

## SPECIFICATIONS

### ACOUSTIC & ELECTRICAL SPECIFICATIONS:

- Nominal Impedance: 8 ohms
- Power Capacity: L.F. 400 W (1600 W Peak), 2 Hrs  
300 W (1200 W Peak), 100 Hrs  
H.F. 75 W (300 W Peak), 2 Hrs
- Frequency Range: 80 Hz – 18 kHz (-10 dB)
- Sensitivity: L.F. 109 dB SPL (1 W at 1M)  
H.F. 116 dB SPL (1 W at 1 M)
- System Sensitivity: Passive Mode 107 dB SPL (1 W at 1 M)
- Passive Crossover: 6th Order (36 dB/Oct) Linkwitz-Riley  
HP and LP, 850 Hz

### SYSTEM COMPONENTS:

- Cabinet: (Not For Sale)
- Grille: 352235-001, 352235-003 (Wh)
- Low Frequency Transducer: 300mm (12 in.) Driver with 75mm (3 in.) Voice Coil (M222-8A)
- DC Resistance: 4.2 ohm

### SYSTEM COMPONENTS: (cont'd)

- High Frequency Transducer: 38mm (1.5 in.) Exit Compression Driver with 100mm (4 in.) Voice Coil (2451H-1)
- DC Resistance: 5.2 ± 0.4 ohms
- Crossover Network: 352609-001

### AURAL SWEEP TEST SPECIFICATIONS:

- A. System Aural Sweep Test: 7.0V Input, 40 Hz to 20 kHz
- B. L.F. Aural Sweep Test: 7.0V Input, 20 Hz to 1.2 kHz
- C. H.F. Aural Sweep Test: 2.83V Input, 100 Hz to 1.0 kHz

### PHYSICAL SPECIFICATIONS:

- Enclosure Dimensions: 991mm x 673mm x 706mm D  
(39.0 x 26.5 x 27.8 in. D)
- Net Weight: 152 lbs. (69.0 kg.)

### WARRANTY INFORMATION:

- Refer to Warranty Statement packed with each product.

## PACKAGE

Warranty 59660

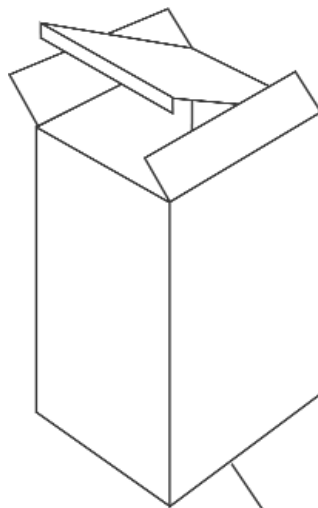

Carton  
352163-001

Top and Bottom Filler  
352164-001  
Poly Bag  
350691-001

## WIRING DIAGRAM

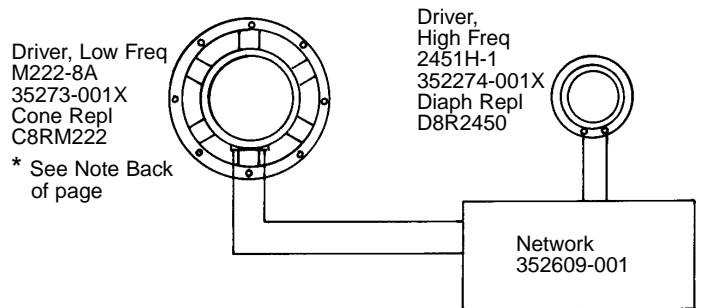

SCHEMATIC (352609-001)

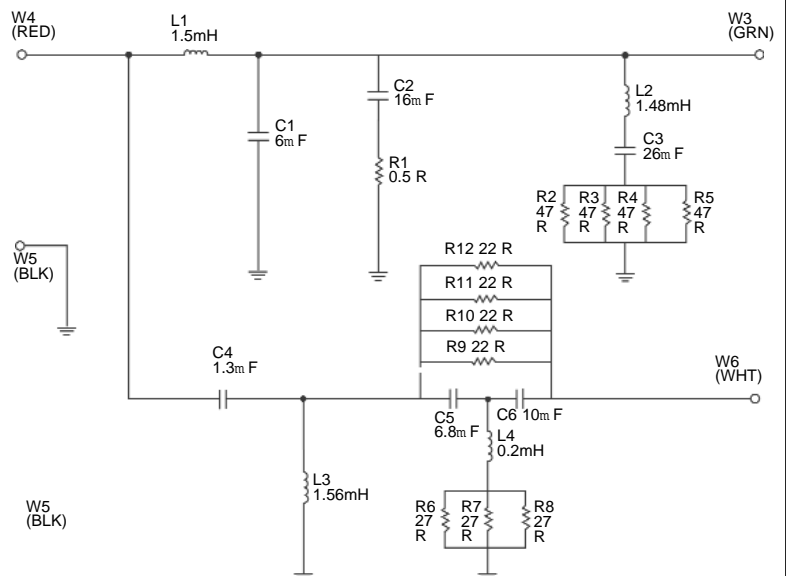

JBL PD5212/64-WH REV F

# JBL PD5212/64-WH

## COMPONENT EXPLODED VIEW

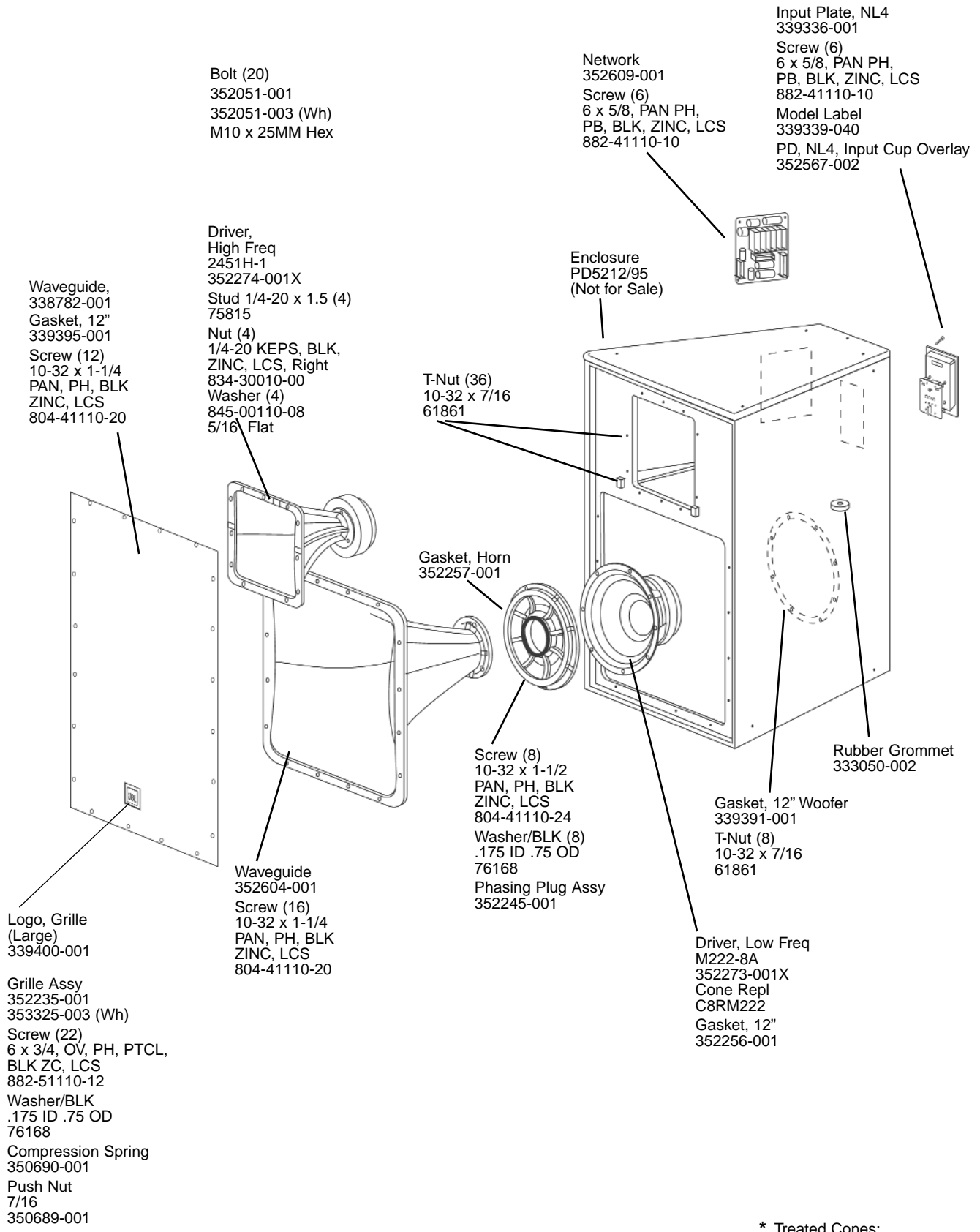

\* Treated Cones:  
 Install Sheet 980-00037-00  
 WR-2 (2 oz)  
 WR-16 (16 oz)

**JBL PD5212/64-WH**