

# Technical Manual

# JBL MS115/WH

## SPECIFICATIONS



### ACOUSTIC & ELECTRICAL SPECIFICATIONS:

- Nominal Impedance: 8 ohm
- Power Capacity: 350W IEC: 1400W Peak
- Frequency Range: 55 Hz – 17 kHz (-10dB)
- Sensitivity: 100 dB SPL, 1 Watt @ 1 Meter
- Crossover Frequency: 1.6 kHz

### SYSTEM COMPONENTS:

- Cabinet: (Not For Sale)
- Grille: 128-00323-65, 128-00323-00 (Wh)
- Low Frequency Transducer: 380mm (15 in.) Dome Transducer (2032H)  
DC Resistance: 4.3 ohm ± 10%
- High Frequency Transducer: 25mm (1 in.) Titanium Diaphragm (2418H)  
DC Resistance: 3.2 ohm ± 8%

### SYSTEM COMPONENTS: (cont'd)

- Crossover Network 129-20039-00

### AURAL SWEEP TEST SPECIFICATIONS:

- A. System Aural Sweep Test: 7.0V Input, 20 Hz to 20 kHz
- B. L.F. Aural Sweep Test: 7.0V Input, 20 Hz to 1.2 kHz
- C. H.F. Aural Sweep Test: 2.83V Input, 550 Hz to 20 kHz

### PHYSICAL SPECIFICATIONS:

- Enclosure Dimensions: 661mm x 467mm x 413mm D (26.0 x 18.38 x 16.25 in. D)
- Net Weight: 62 lbs. (28.2 kg.)

### WARRANTY INFORMATION:

- Refer to Warranty Statement packed with each product.

## PACKAGE

Warranty 59660  
Owner's Manual 981-00043-03  
Logo Sticker, Marquis 950-00032-00

Tech Note 980-00036-00

Filler (2) 991-00138-00

Microfoam (4) Packaging 49790P

Hardware Kit 229-00009-01  
Eye Bolt (3) 888-00049-00  
Washer (3) 846-73310-03  
Instruction Sheet 980-00032-00

Carton 990-00143-00

## WIRING DIAGRAM

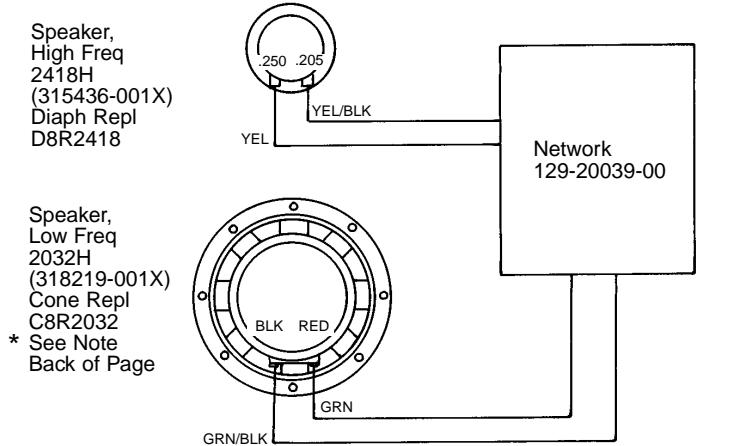

SCHEMATIC (129-20039-00)

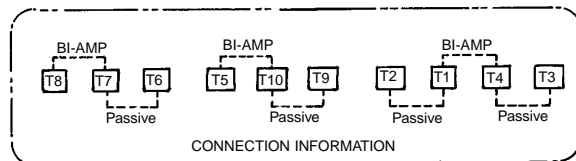
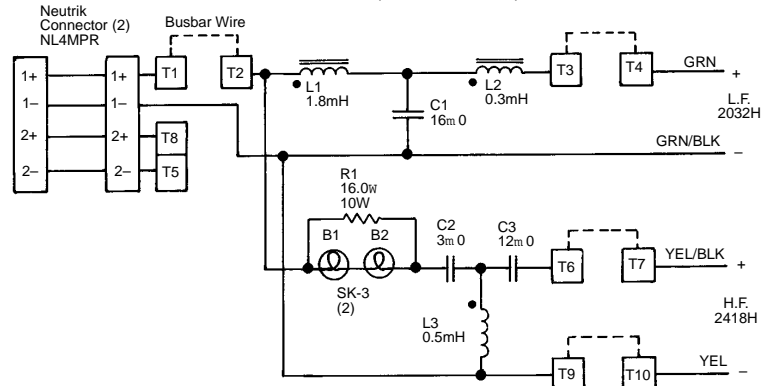

JBL MS115/WH REV L

# JBL MS115/WH

## COMPONENT EXPLODED VIEW

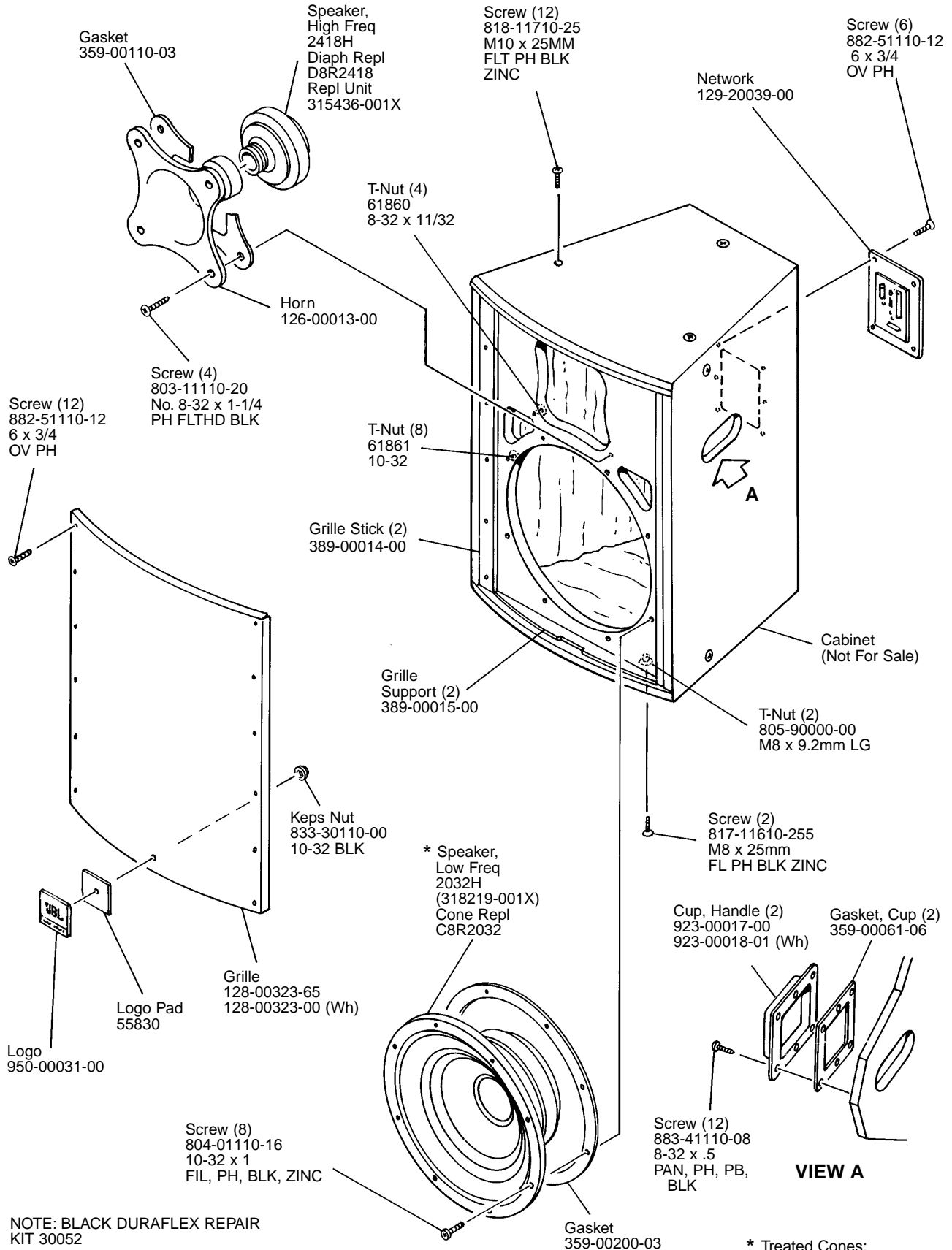

NOTE: BLACK DURAFLEX REPAIR KIT 30052

WHITE DURAFLEX REPAIR KIT 30053

\* Treated Cones:  
Install Sheet 980-00037-00  
WR2 (2 oz)  
WR16 (16 oz)

JBL MS115/WH