

# Technical Manual

# JBL LSR2325P

## SPECIFICATIONS



### SPECIFICATIONS:

- Long Term Maximum System Power: 21 Watts (IEC265-5)
- Frequency Range: 43 Hz - 20 kHz (+/- 3 dB)
- Input Sensitivity: 92 dB SPL / 1 meter at -10 dBV Balanced Input
- Maximum SPL: Each: 101 dB / 107 dB (Continuous / Peak)  
Pair: 112 dB / 118 dB (Continuous / Peak)
- Amplifier Power: LF/HF: 55 W / 35 W
- Input Connectors: Balanced XLR, 1/4" TRS, RCA
- Crossover Frequency: 1.7 kHz 4th-order Acoustic Linkwitz-Riley

### SYSTEM COMPONENTS:

- Cabinet Assembly: Not Available for sale
- Low Frequency Transducer: 235G, 132 mm (5 in) Magnetically Shielded Ferrite
- DC Resistance: 3.2 ohm +/- 0.1 ohm
- High Frequency Transducer: 231H, 25 mm (1 in) neodymium
- DC Resistance: 7.2 ohm +/- 0.36 ohm

### AURAL SWEEP TEST SPECIFICATIONS:

- A. System Aural Sweep Test: 0.44V Input, 20 Hz to 20 kHz  
- 4 dB XLR Input, volume full clockwise switches to center detent
- B. L.F. Aural Sweep Test: 4.0 V Input, 20 Hz to 2 kHz
- C. H.F. Aural Sweep Test: 2.5 V Input, 100 Hz to 10 kHz

### PHYSICAL SPECIFICATIONS:

- Enclosure Dimensions: 303 x 187 x 258 mm D  
(H x W x D) (11.9 x 7.4 x 10 in D)
- Net Weight: 16 lb (7.7 kg)

### WARRANTY INFORMATION:

- Refer to Warranty Statement packed with each product.

## PACKAGE

Warranty 59660

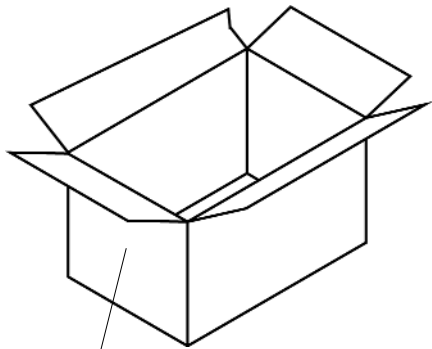

Carton  
440897-001

Filler  
440900-001

Manual, LSR2300  
365438-001

PKG, Microfoam (2)  
49790P  
20" x 18" Sheets

AC Cord 120V  
425-00000-00  
AC-Cord 230V  
425-00000-01



## INPUT PANEL

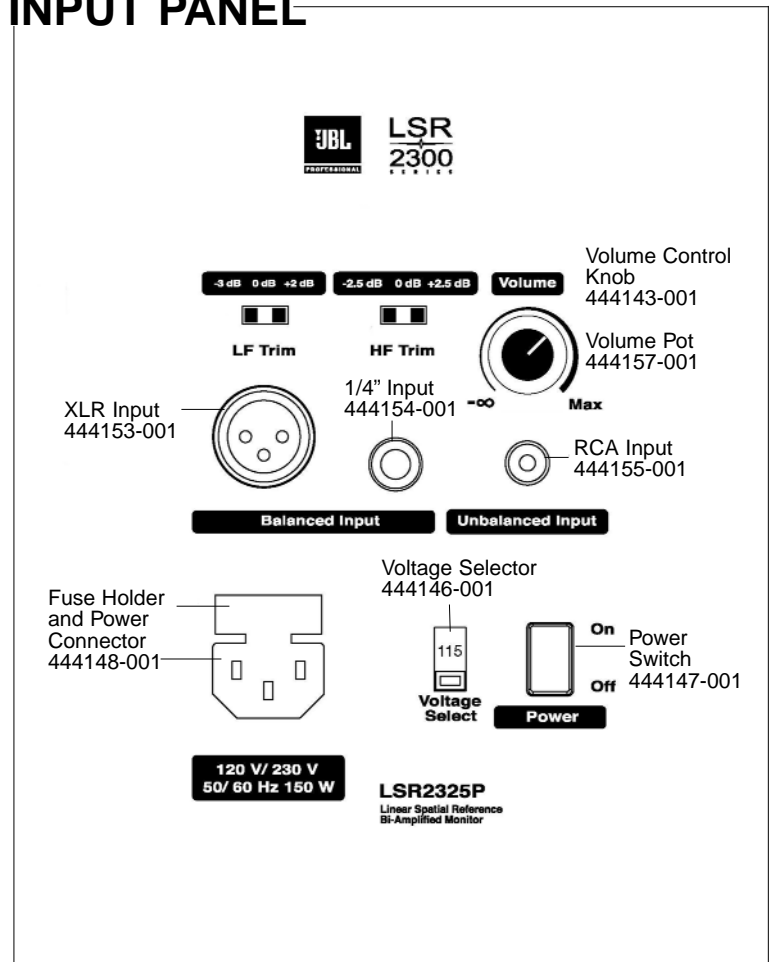

JBL LSR4325P REV B

# JBL LSR2325P

## COMPONENT EXPLODED VIEW

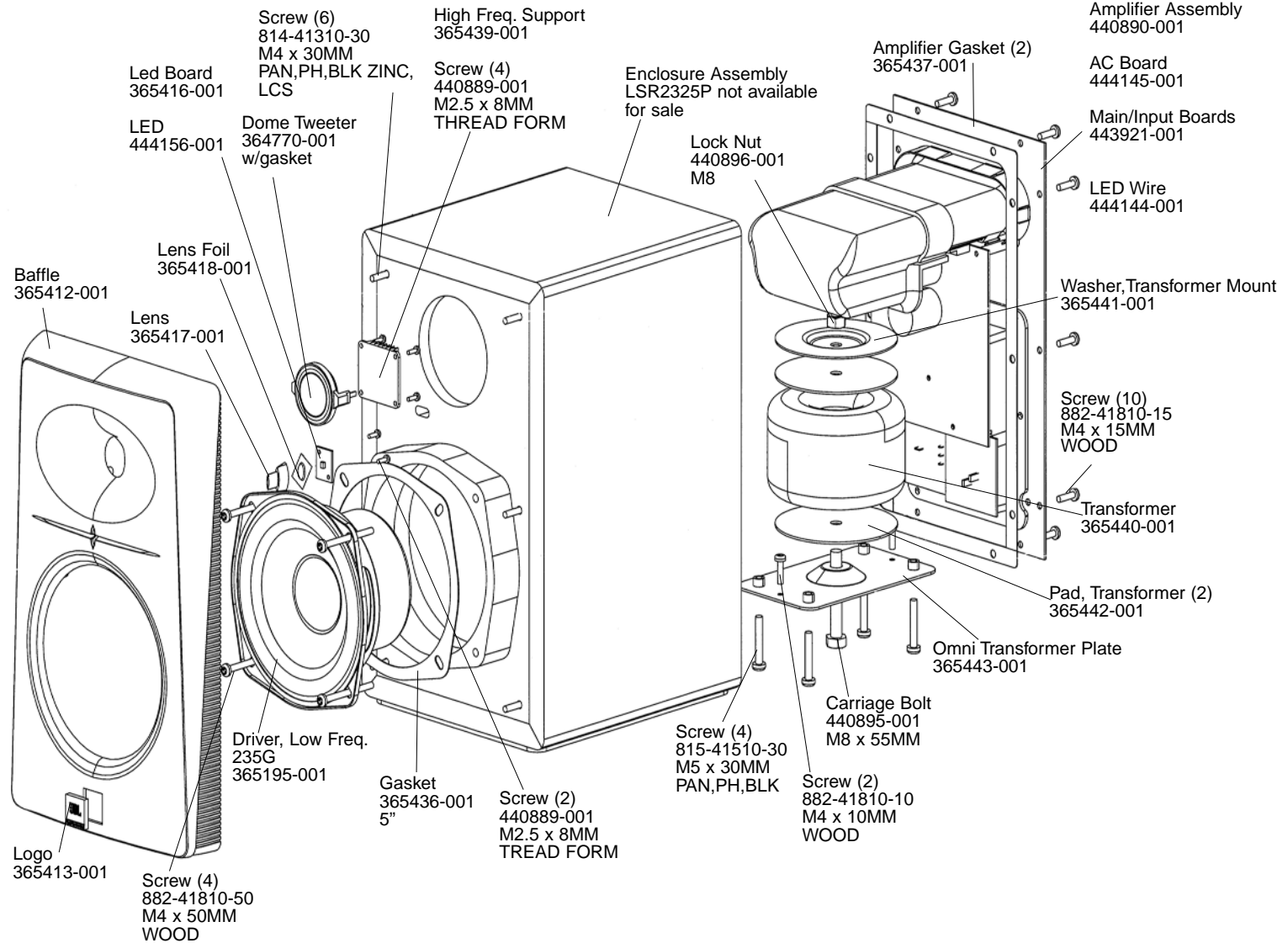

JBL LSR2325P