

Technical Manual

JBL031TiS

SPECIFICATIONS



ACOUSTIC & ELECTRICAL SPECIFICATIONS:

- Nominal Impedance: 8 ohm
- Power Capacity:] Not Available
- Frequency Range:] Not Available
- Sensitivity:] Not Available
- Crossover Frequencies: N/A

SYSTEM COMPONENTS:

- Cabinet: N/A
- Grille: N/A
- High Frequency Transducer: 25mm (1 in.) Pure Titanium Dome (031TiS) (73849)
- DC Resistance: 3.5 ohm to 4.2 ohm Copper Wire

AURAL SWEEP TEST SPECIFICATIONS:

- H.F. Aural Sweep Test: 2.0V Input, 2.0 Hz to 20 kHz

PHYSICAL SPECIFICATIONS:

- Enclosure Dimensions: 112mm x 85mm x 36mm D (4.375 x 3.35 x 1.43 in. D)
- Net Weight: Not Available

WARRANTY INFORMATION:

- Refer to the Warranty Statement packed with each product.

*1 Watt (2.83 V RMS) @ 1 Meter

PACKAGE

Warranty 59660

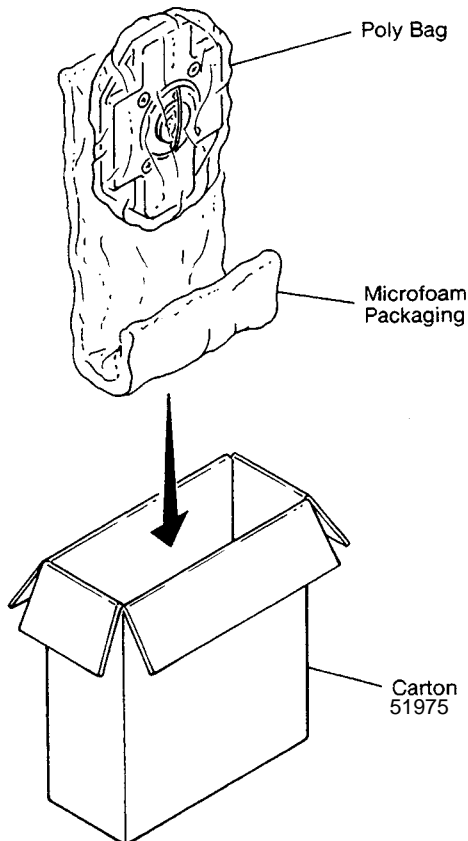

COMPONENT VIEW

Speaker, High Freq
031TiS
(73849)

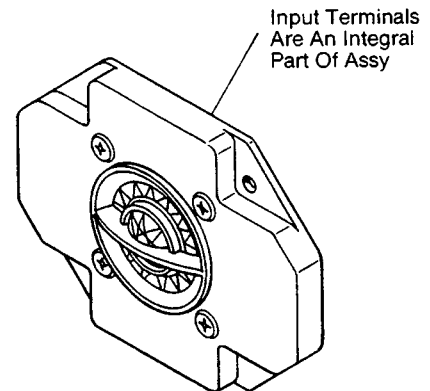
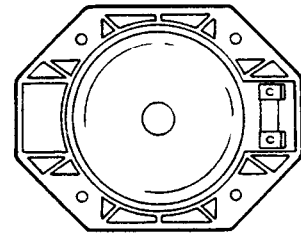

NOTE: CONE/DIAPHRAGM KIT NOT AVAILABLE. DEFECTIVE SPEAKER SHOULD BE REPLACED.

JBL031TiS REV B

JBL031TiS

MECHANICAL DRAWING

THESE DRAWINGS AND SPECIFICATIONS ARE THE PROPERTY OF JBL. UNLESS OTHERWISE SPECIFIED, THEY ARE ISSUED IN STRICT CONFIDENCE AND SHALL NOT BE REPRODUCED, COPIED, OR USED AS THE BASIS FOR MANUFACTURE OR SALE OF APPARATUS WITHOUT WRITTEN PERMISSION.

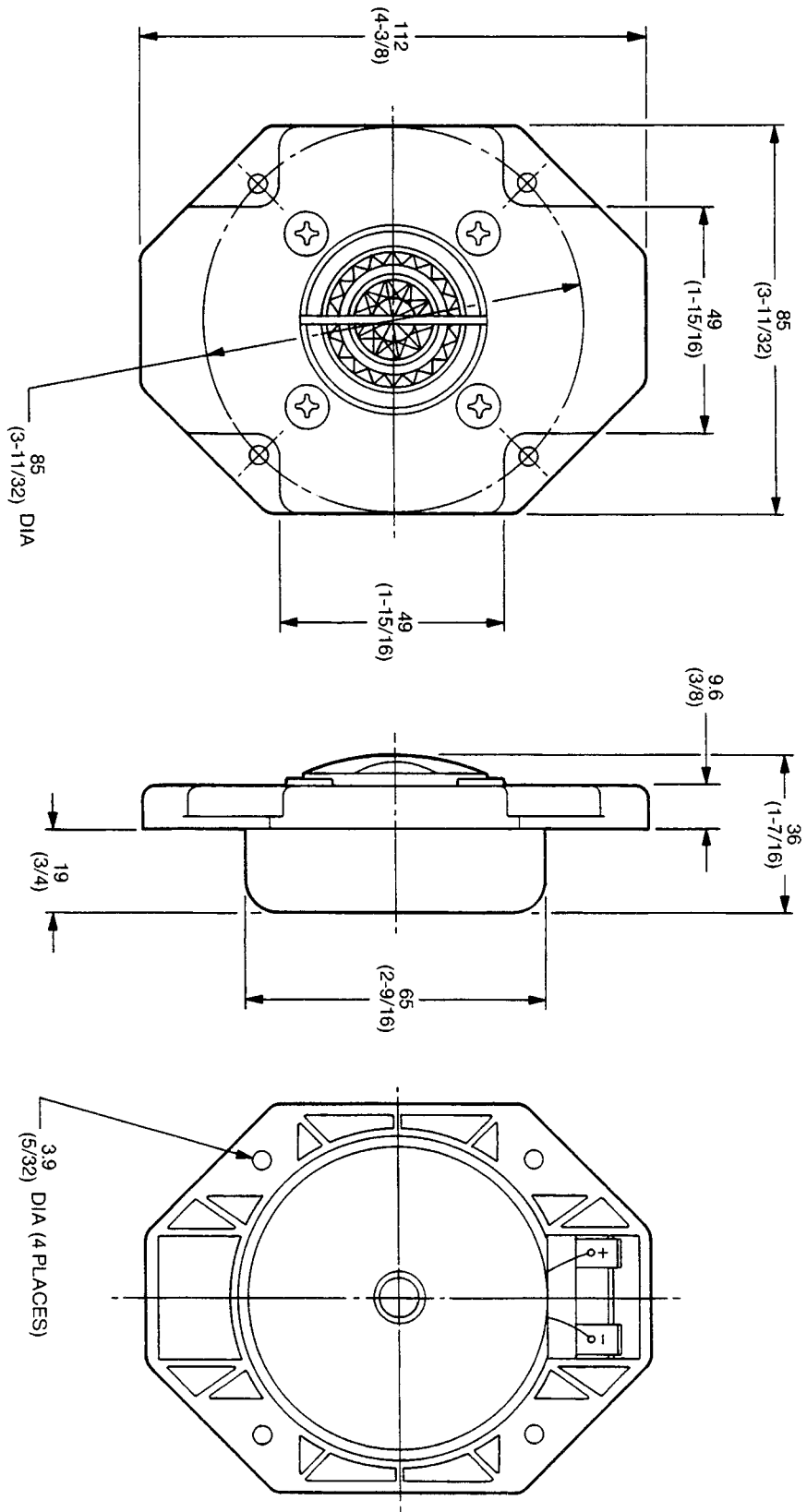

ALL DIMENSIONS ARE REF. ONLY
NOTE: DIMENSIONS IN () ARE IN INCHES

JBL031TiS