

Technical Manual

JBL AM6315/64-WH



SPECIFICATIONS

ACOUSTIC & ELECTRICAL SPECIFICATIONS:

- Nominal Impedance: 8 Ohms
- Power Capacity (AES): L.F. 1000W (4000W Peak), 2 Hrs
600W (2400W Peak), 100 Hrs
M.F. 350W (1400W Peak) 100 Hrs
H.F. 75 W (300W Peak), 2 Hrs
- Frequency Range: 38Hz – 19 kHz (-10dB)
- Sensitivity: L.F. 95dB SPL (1 watt @ 1 meter)
M.F. 108dB SPL (1 watt @ 1 meter)
H.F. 115dB SPL (1 watt @ 1 meter)
M.F./H.F. Section in Bi-Amp Mode:
108dB SPL
- Crossover Frequency: 4th Order (24dB/oct) Linkwitz-Riley
HP & LP, 2.1 kHz

SYSTEM COMPONENTS:

- Cabinet: Enclosure (Not For Sale)
- Grille: 338163-008, 338163-108 WH
- Low Frequency Transducer: 2226HPL, 380mm (15 in.) VGCTM Driver With 100mm (4 in.) Voice Coil
- DC Resistance: 5.0 ohm ±10% Aluminum Wire
- Mid Range Transducer: 2250HPL, 200mm (8 in.) NDDTM Neodymium Differential Drive Dual Voice Coil Internal Driver
- DC Resistance: 5.2 ohm ±10% Aluminum Wire

SYSTEM COMPONENTS: (CONT'D)

- High Frequency Transducer: 2431H, 38mm (1.5 in.) Exit Compression Driver, 75mm (3 in.) Voice Coil
- DC Resistance: 4.4 ohm ±10%
- Crossover Network: 339407-001

AURAL SWEEP TEST SPECIFICATIONS:

- A. System Aural Sweep Test: 10.0V Input, 20 Hz to 20 kHz
- B. L.F. Aural Sweep Test: 10.0V Input, 20 Hz to 1.2 kHz
- C. M.F. Aural Sweep Test: 7.0V Input, 170 Hz to 5 kHz
- D. H.F. Aural Sweep Test: 2.83V Input, 550 Hz to 20 kHz

PHYSICAL SPECIFICATIONS:

- Enclosure Dimensions: 967 x 561 x 657 mm D
(38.1 x 22.1 x 25.9 in.D.)
- Net Weight: 107 lb (48.3 kg.)

WARRANTY INFORMATION:

- Refer to Warranty Statement packed with each product.

PACKAGE

Warranty 59660
Installation Sheet
339390-007

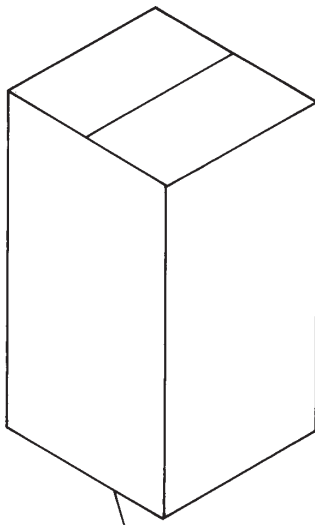

Carton
338860-001

Hardware Kit
229-00009-01

Filler (2)
351590-001

ACC, Not included

Micro Foam (8)
49790P

Logo Sticker, Grille Assy (Large) AE
339399-001

Sticker, JBL
337638-001

WIRING DIAGRAM

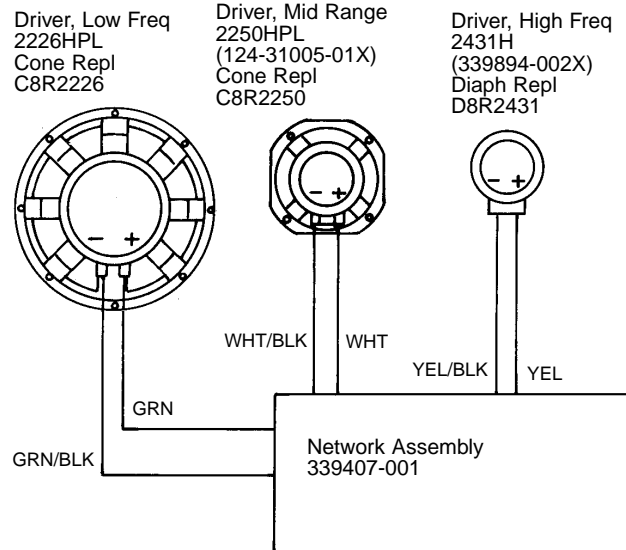

SEE NETWORK SCHEMATIC PAGE

Schematic Diagram (339419-001)

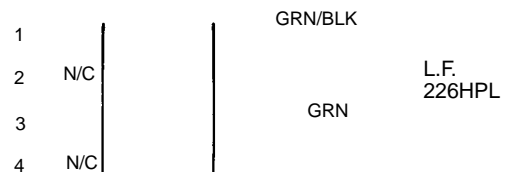

JBL AM6315/64-WH

COMPONENT EXPLODED VIEW

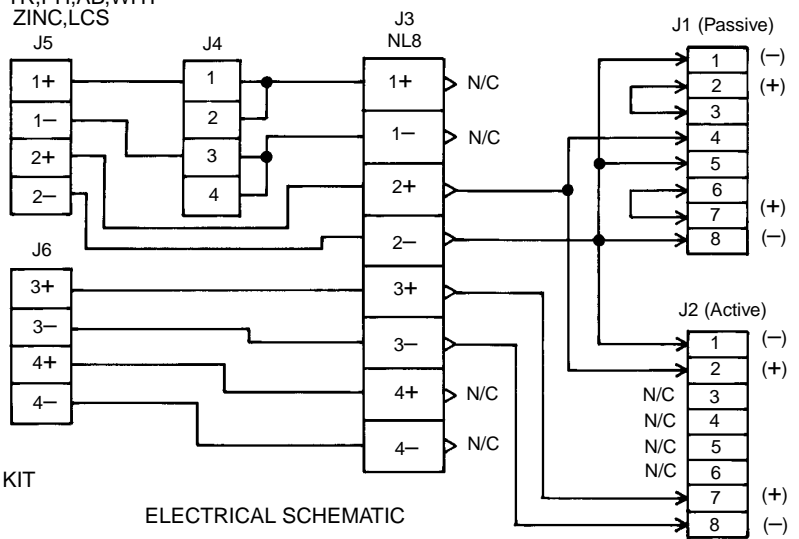
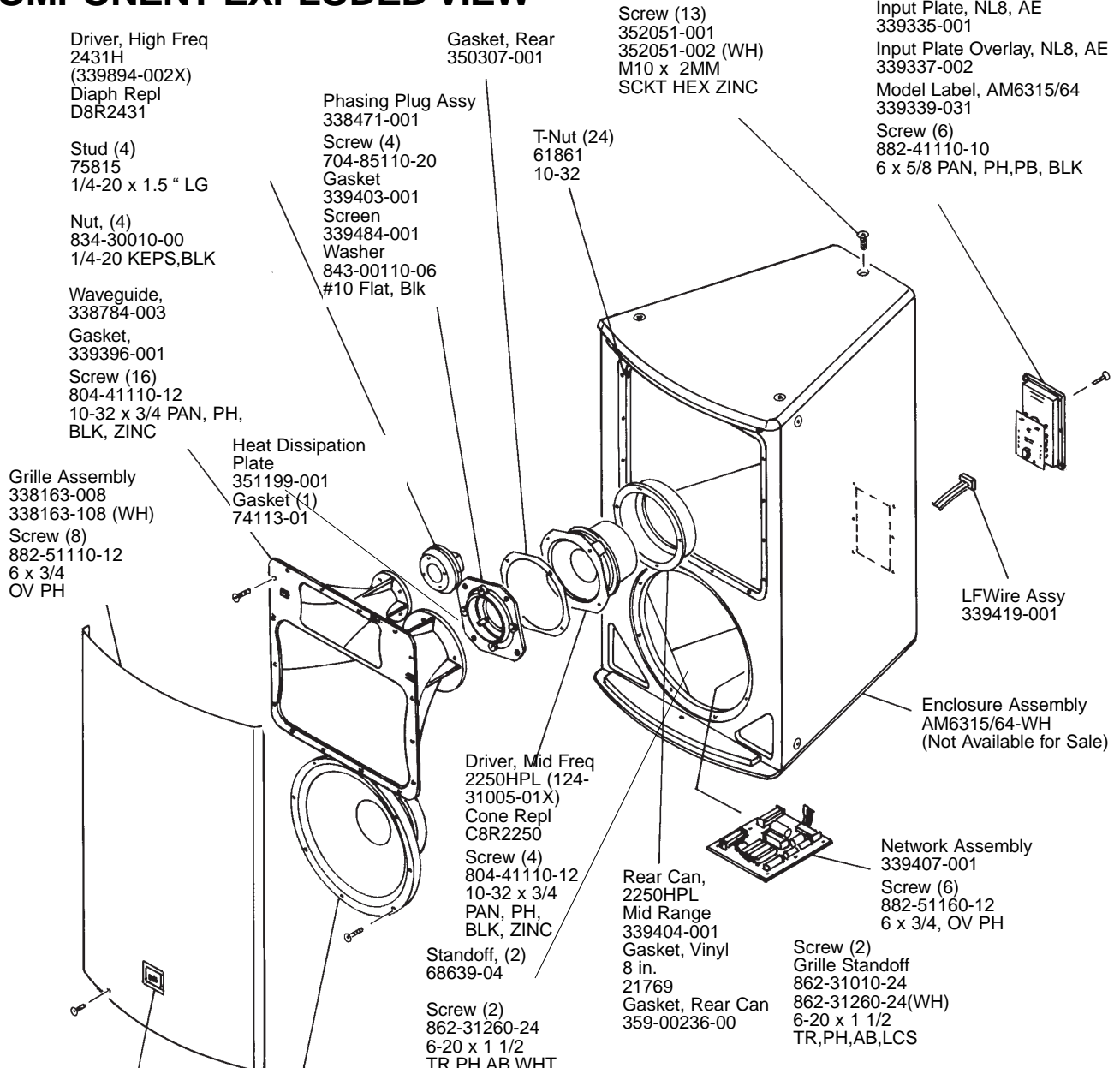

NOTE: BLACK DURAFLEX REPAIR KIT
16677
WHITE DURAFLEX REPAIR KIT
16679

JBL AM6315/64-WH

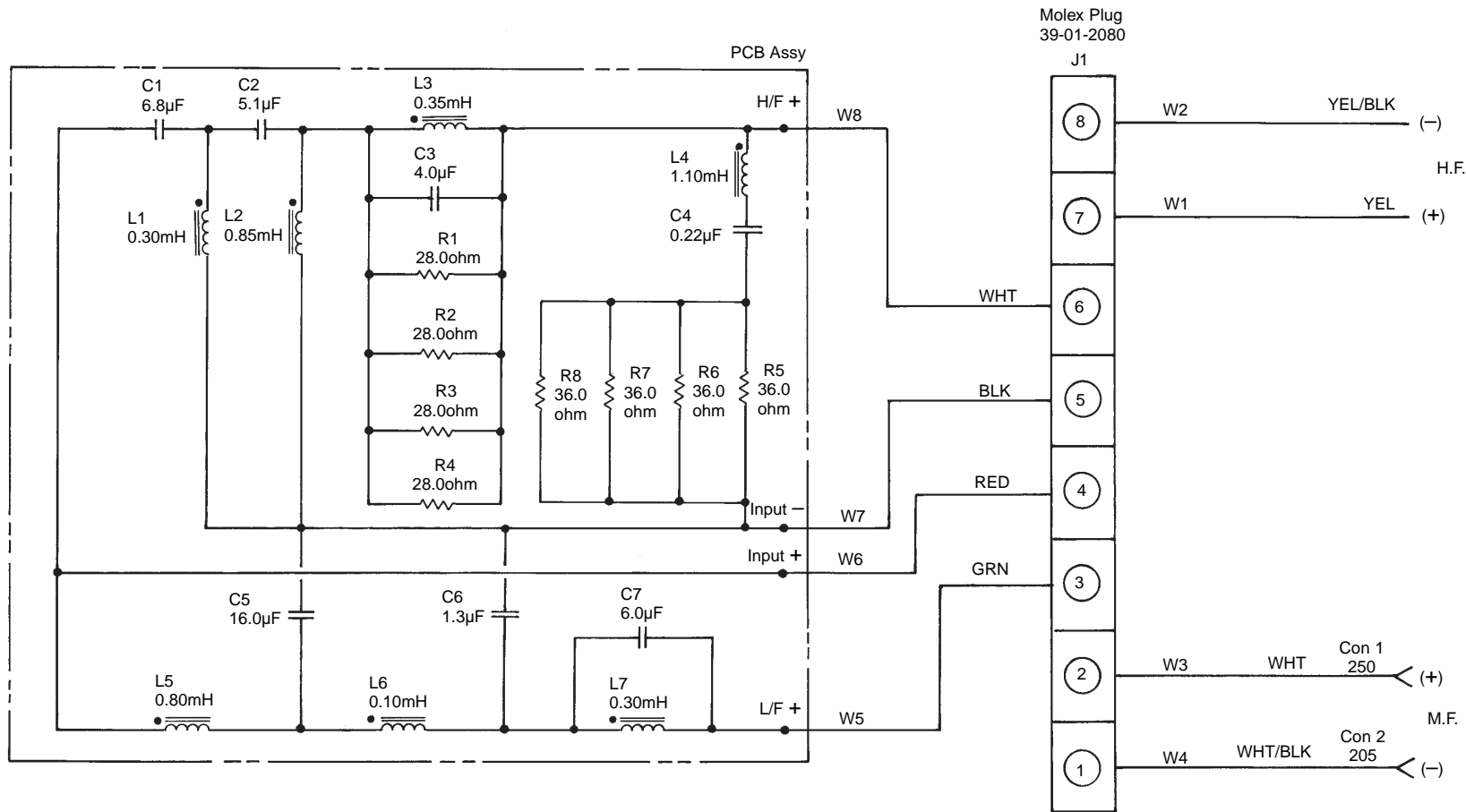

NOTE: INDIVIDUAL PARTS FOR THE ABOVE CROSSOVER ARE NOT AVAILABLE.
A COMPLETE REPLACEMENT ASSEMBLY SHOULD BE ORDERED.