

Technical Manual



JBL AM4215/95-WH

SPECIFICATIONS

ACOUSTIC & ELECTRICAL SPECIFICATIONS:

- Nominal Impedance: 8 Ohms
- Power Capacity (AES): L.F. 500W (2000W Peak), 2 Hrs
350W (1200W Peak), 100 Hrs
H.F. 35W (140W Peak), 2 Hrs
- Frequency Range: 40Hz – 20 kHz (-10dB)
- Sensitivity: L.F. 97dB SPL (1 Watt at 1 Meter)
H.F. 113dB SPL (1 Watt at 1 Meter)
Passive Mode 97dB
- Crossover Frequencies: 4th Order (24dB/oct) Linkwitz-Riley
HP & LP, 1.3 kHz

SYSTEM COMPONENTS:

- Cabinet: Enclosure (Not For Sale)
- Grille: 338163-002, 338163-102 (WH)
- Low Frequency Transducer: 2033H, 380mm (15 in.) Driver With
75mm (3 in.) Voice Coil
- DC Resistance: 5.3 ohm ±10%
- High Frequency Transducer: 2407H, 38mm (1.5 in.) Exit Compression
Driver 38mm (1.5) Voice Coil

SYSTEM COMPONENTS: (CONT'D)

- DC Resistance: 4.25 ohm ±0.15 ohms
- Crossover Network: 339437-002

AURAL SWEEP TEST SPECIFICATIONS:

- A. System Aural Sweep Test: 7.0V Input, 40Hz to 20 kHz
- B. L.F. Aural Sweep Test: 6.0V Input, 40Hz to 7 kHz
- C. H.F. Aural Sweep Test: 2.83V Input, 1.6 kHz to 16 kHz

PHYSICAL SPECIFICATIONS:

- Enclosure Dimensions: 783 x 422 x 504mm D
(30.8 x 16.6 x 19.9in.D.)
- Net Weight: 64 lb (29.0 kg.)

WARRANTY INFORMATION:

- Refer to Warranty Statement packed with each product.

PACKAGE

Warranty 59660
Installation Sheet
339390-004

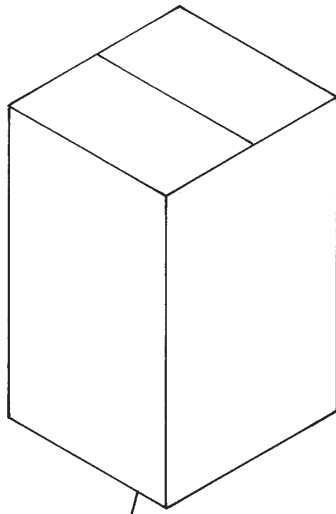

- Carton 351684-001
- Filler (2) 351408-001
- Micro Foam (8) 49790P
- Logo Sticker, Grille Assy (Medium) 339398-001
- Sticker, JBL 337638-001
- Hardware Kit 229-00009-01
- ACC, Not Included

WIRING DIAGRAM

Driver, Low Freq
2033H(124-37007-00X)
Cone Repl
C8R2033

Driver, High Freq
2407H (339150-001X)
Diaph Repl
D8R2407

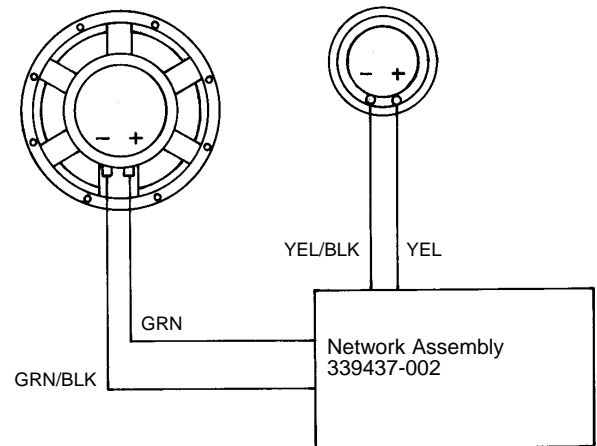

SEE NETWORK SCHEMATIC PAGE

NOTE: INDIVIDUAL PARTS FOR THE ABOVE CROSSOVER ARE NOT AVAILABLE.
A COMPLETE REPLACEMENT ASSEMBLY SHOULD BE ORDERED.

JBL AM4215/95-WH

SCHEMATIC (339437-002)

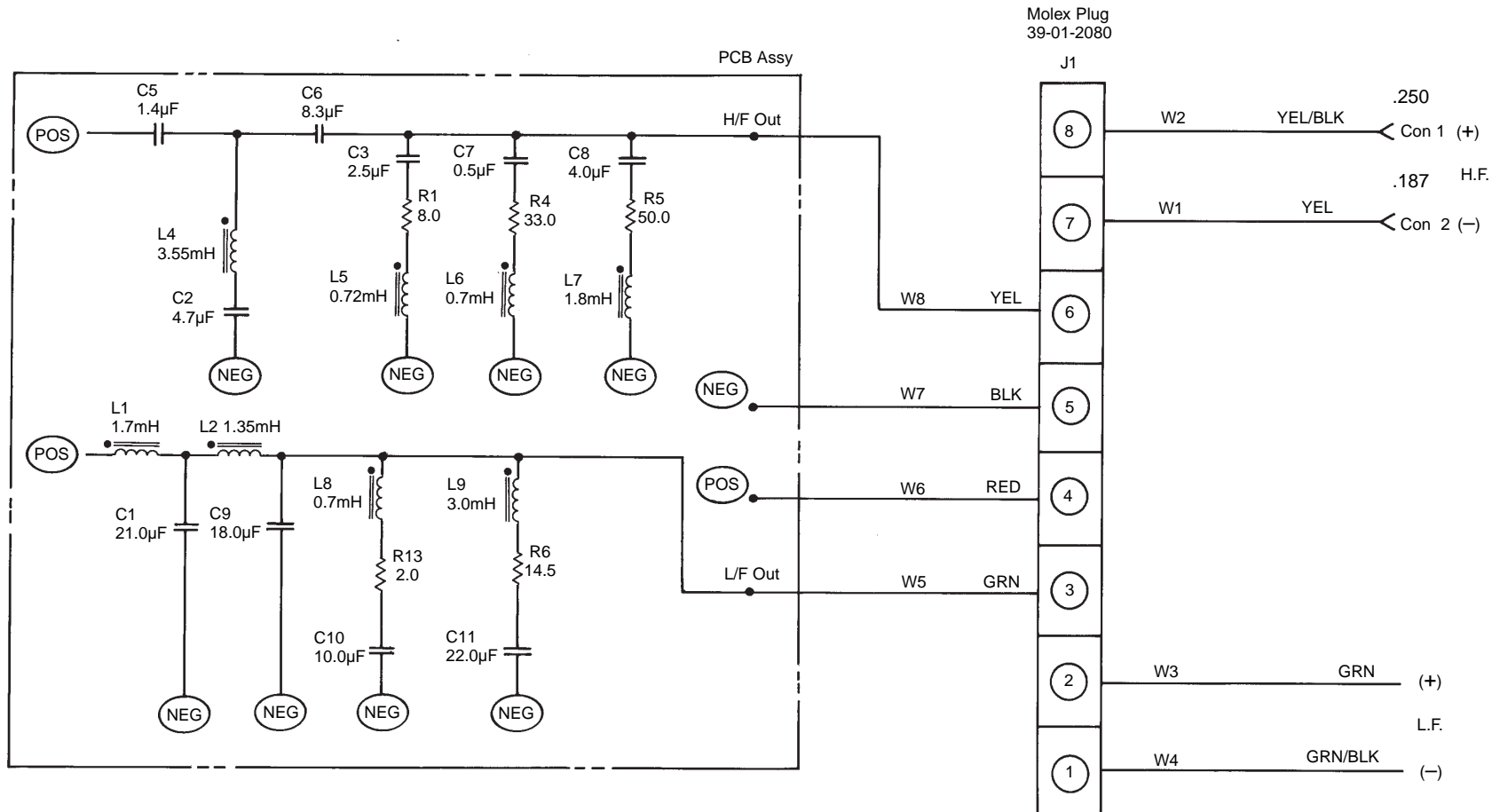

Individual Parts for the above crossover are not available.
A complete replacement assembly should be ordered.

JBL AM4215/95-WH

JBL AM4215/95-WH

COMPONENT EXPLODED VIEW

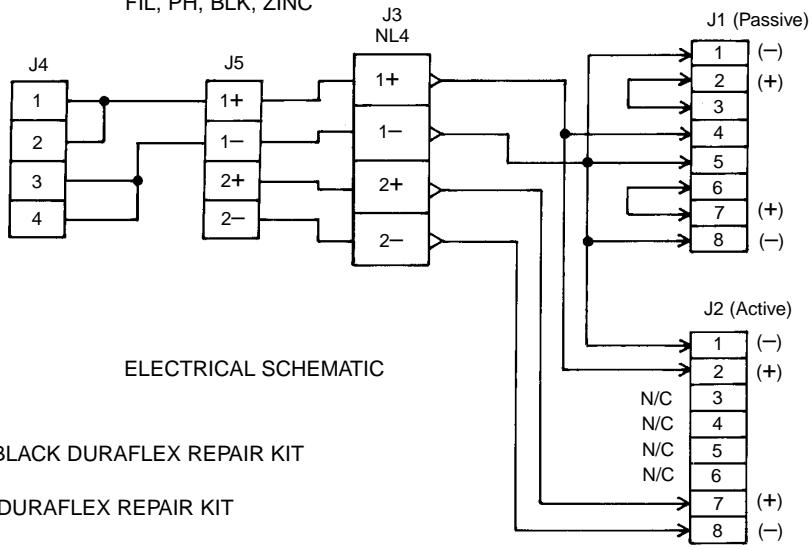
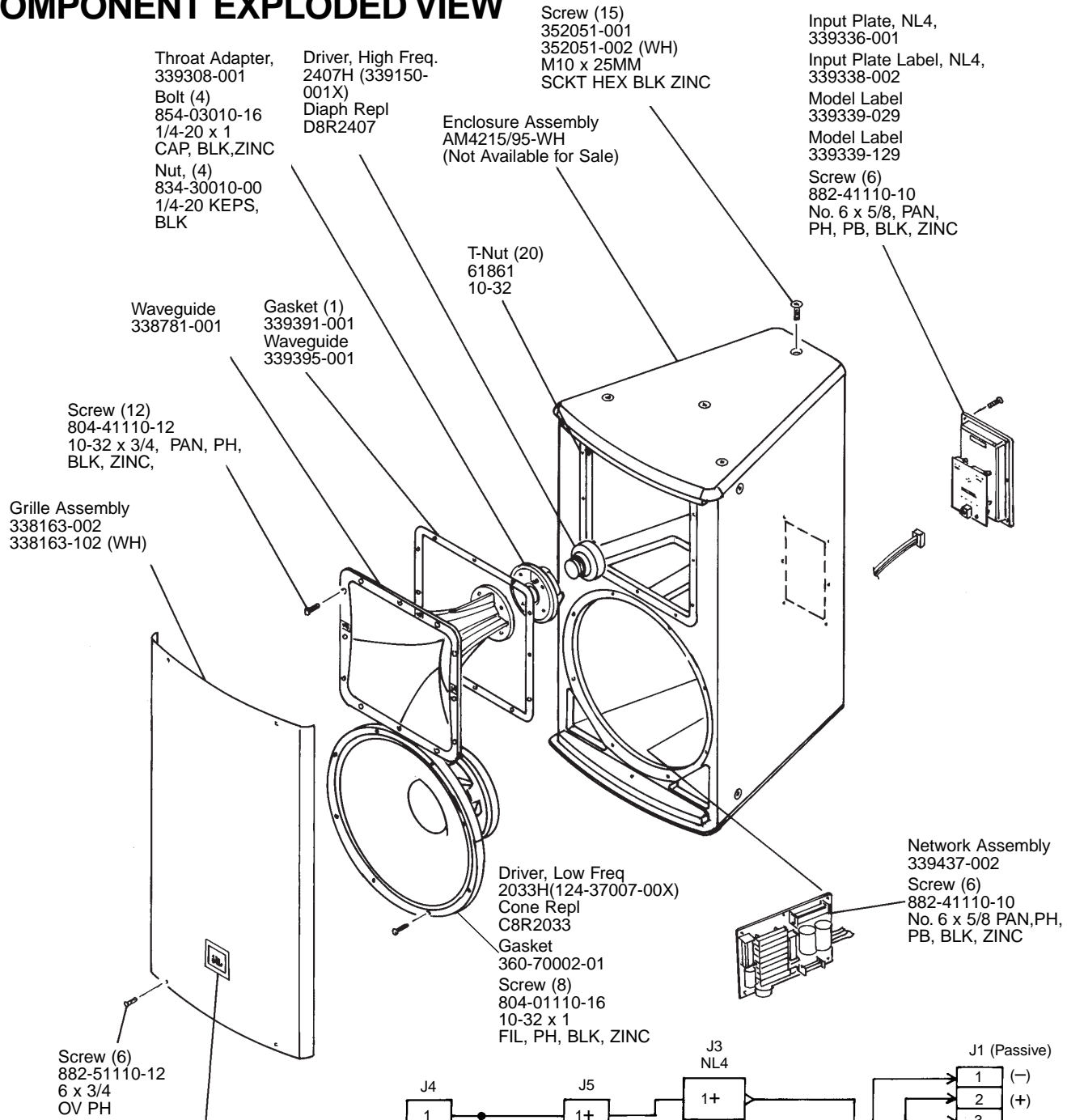

NOTE: BLACK DURAFLEX REPAIR KIT 16677
WHITE DURAFLEX REPAIR KIT 16679