

Technical Manual



JBL AC2212/95-WH

SPECIFICATIONS

ACOUSTIC & ELECTRICAL SPECIFICATIONS:

- Nominal Impedance: 8 Ohms
- Power Capacity (AES): L.F. 300W (1100W Peak), 2 Hrs
250W (1000W Peak), 100 Hrs
H.F. 30W (120W Peak), 2 Hrs
- Frequency Range: 50Hz – 19 kHz (-10dB)
- Sensitivity: L.F. 95dB SPL (1 watt @ 1 meter)
H.F. 112dB SPL (1 watt @ 1 meter)
Passive Mode 97dB
- Crossover Frequencies: 3rd Order (18dB/oct) Butterworth
HP & LP, 1700 Hz

SYSTEM COMPONENTS:

- Cabinet: Enclosure (Not For Sale)
- Grille: 338163-001, 338163-101 (WH)
- Low Frequency Transducer: M112-8, 300mm (12 in.) Driver With 63mm (2.5 in.) Voice Coil
- DC Resistance: 5.5 ohm ±10%
- High Frequency Transducer: 2412H, 25mm (1. in.) Voice Coil

SYSTEM COMPONENTS: (CONT'D)

- DC Resistance: 3.6 ohm ±10%
- Crossover Network: 339414-001

AURAL SWEEP TEST SPECIFICATIONS:

- A. System Aural Sweep Test: 7.0V Input, 20 Hz to 20 kHz
- B. L.F. Aural Sweep Test: 6.0V Input, 20 Hz to 1 kHz
- C. H.F. Aural Sweep Test: 2.83V Input, 550 Hz to 20 kHz

PHYSICAL SPECIFICATIONS:

- Enclosure Dimensions: 548 x 355 x 352 mm D
(21.6 x 14.0 x 13.9 in.D.)
- Net Weight: 38 lb (17.3 kg.)

WARRANTY INFORMATION:

- Refer to Warranty Statement packed with each product.

PACKAGE

Warranty 59660
Installation Sheet
339390-017

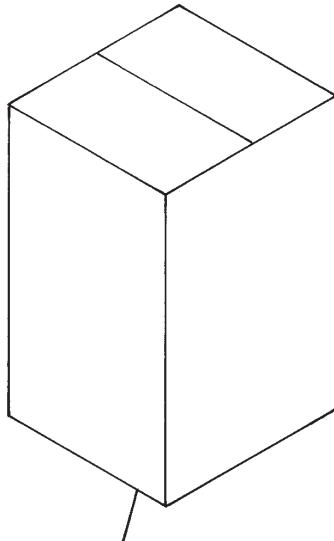

- Carton, AE Enclosure (1)
351386-001
- Filler (2)
331387-001
- Logo Sticker, Grille Assy (Small) AE
339397-001
- Micro Foam (4)
49790P
- Hardware Kit
229-00009-01
- ACC, Not Included

WIRING DIAGRAM

Driver, Low Freq
M112-8
336961-001

Driver, High Freq
2412H
(125-10000-00X)

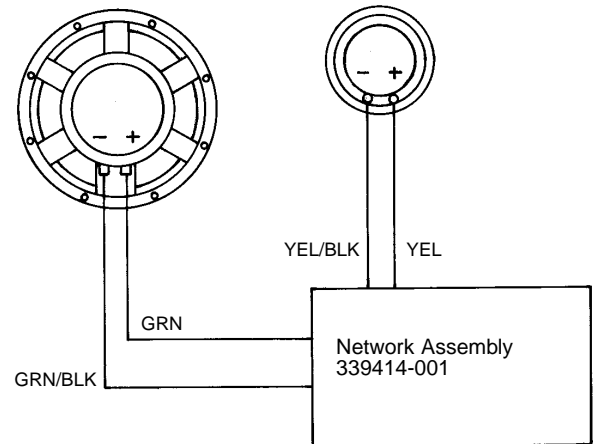

SEE NETWORK SCHEMATIC PAGE

NOTE: INDIVIDUAL PARTS FOR THE ABOVE CROSSOVER ARE NOT AVAILABLE.
A COMPLETE REPLACEMENT ASSEMBLY SHOULD BE ORDERED.

JBL AC2212/95-WH

COMPONENT EXPLODED VIEW

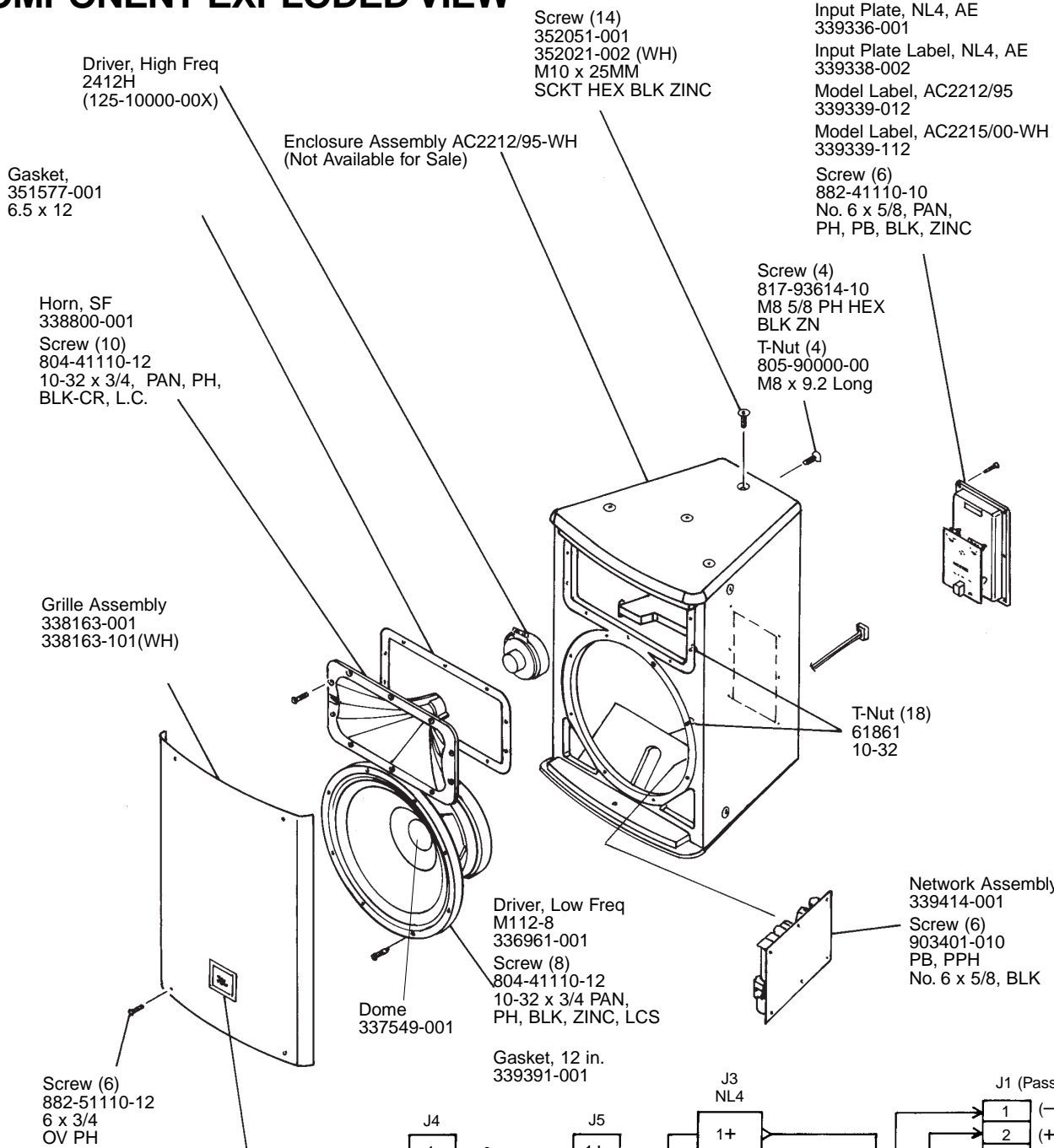

Logo, Grille Assy (Small), AE
339401-001

Logo, Grille Assy (Small), AE
White
339401-002

Push Nut
350689-001
7/16"

Compression Spring
350690-001

Washer, BLK
76168
.175 ID, .75 OD

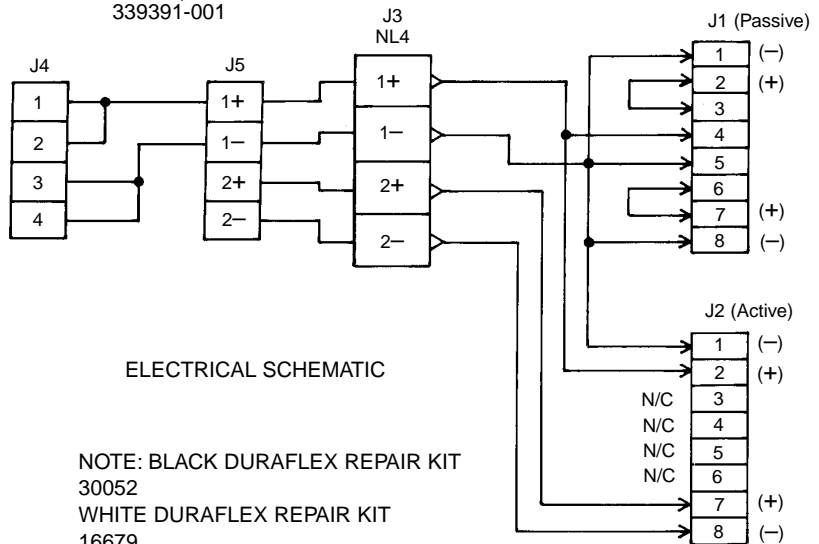

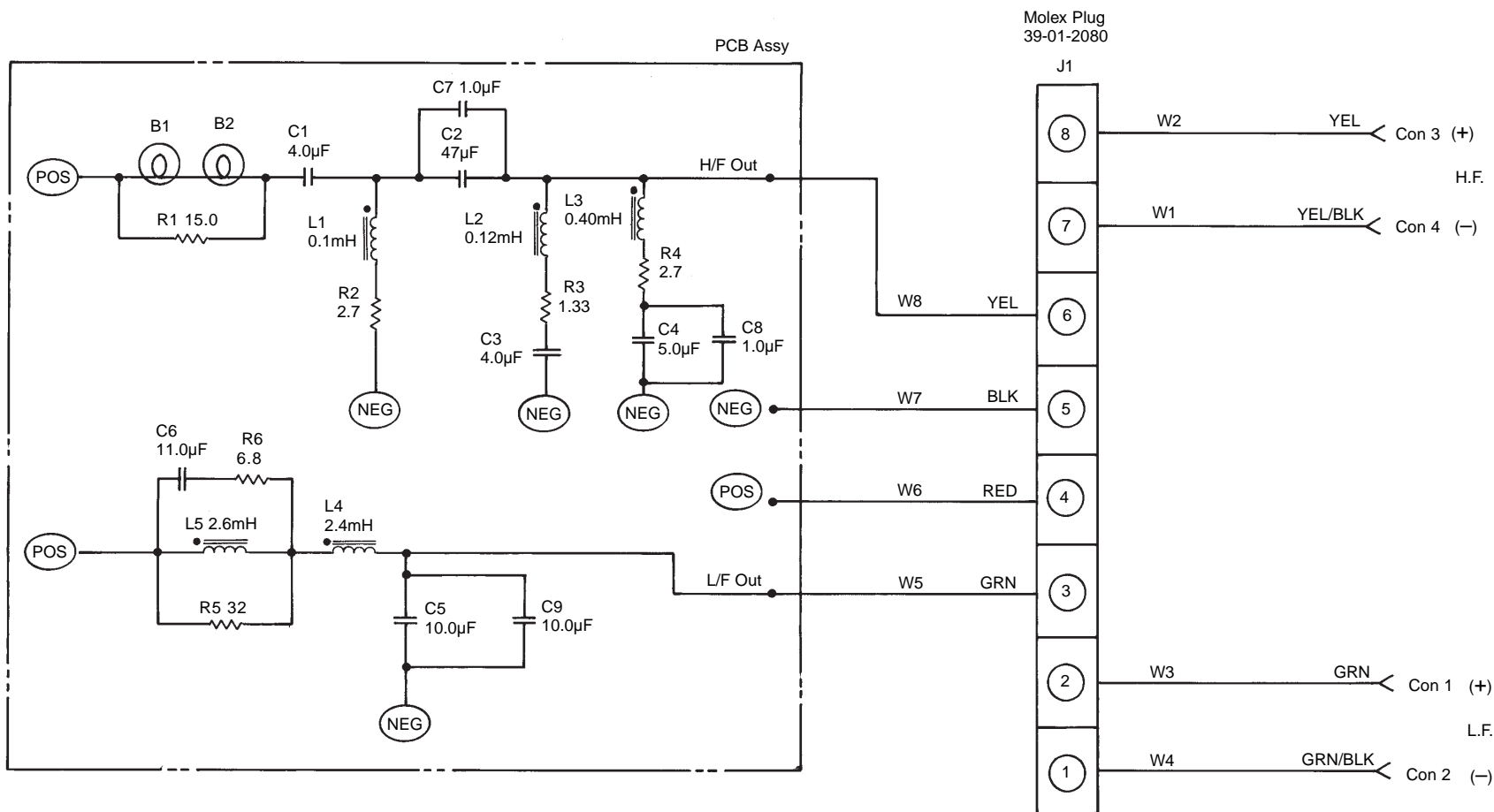

Network Assy
339414-001

NOTE: INDIVIDUAL PARTS FOR THE ABOVE CROSSOVER ARE NOT AVAILABLE.
A COMPLETE REPLACEMENT ASSEMBLY SHOULD BE ORDERED.